



**PARTICOLARI PER
INDUSTRIA EDILIZIA
ED ARREDAMENTO**



GIELLE TECHNOPLAST S.r.l.

GIELLE TECHNOPLAST S.r.l.



Tutte le indicazioni contenute in questo catalogo non assicurano nessuna garanzia, ma hanno esclusivamente carattere informativo.

Modifiche possono essere apportate senza alcun preavviso.

*Troverete tutti gli aggiornamenti sul sito:
www.gielletechnoplast.com.*

Le dimensioni sono espresse in millimetri.

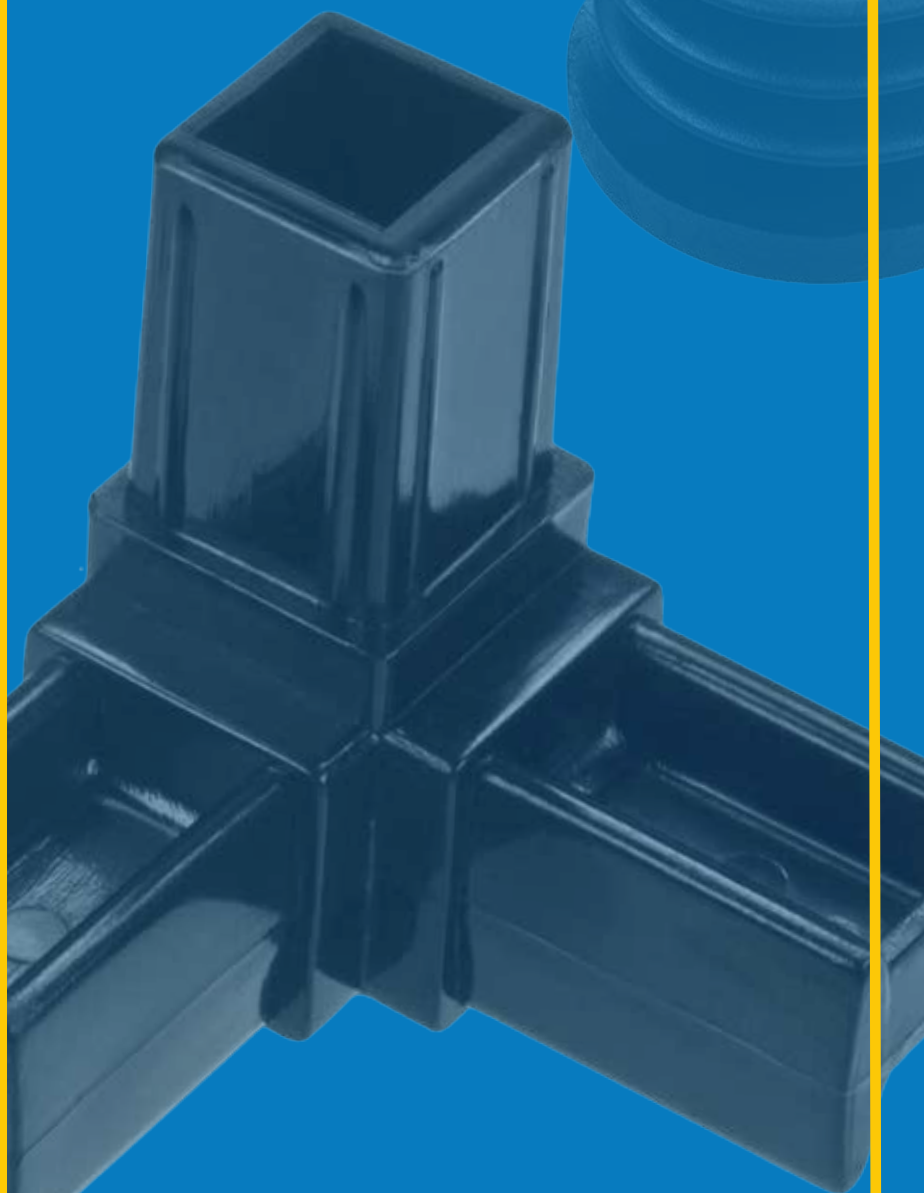
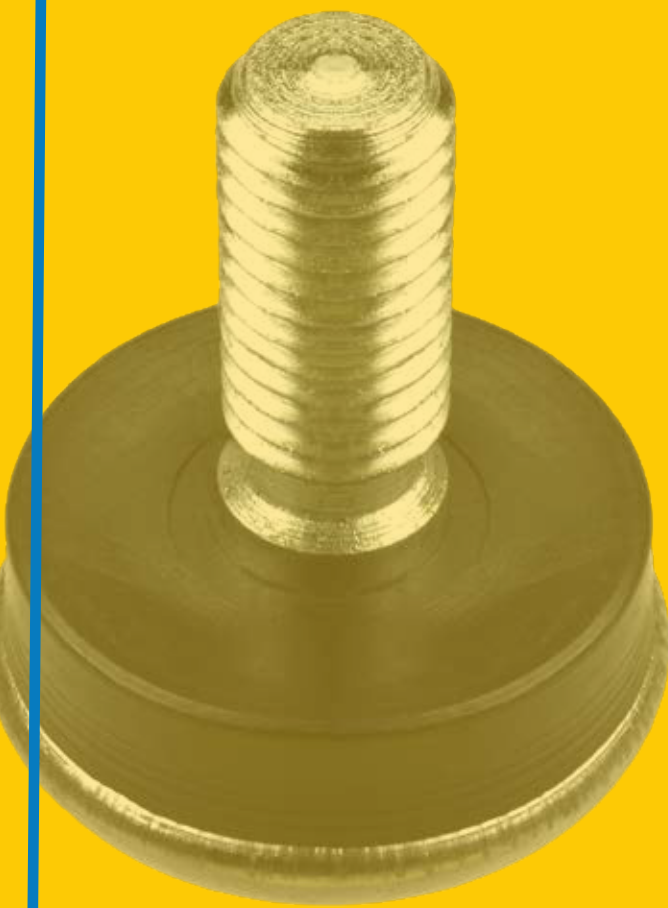

*All indications and communications contained in the present catalogue do not assure any guarantee, but they have information character only.
Changes may be introduced without notice.*

*You will find every update on our web-site:
www.gielletechnoplast.com*

All the dimensions are in mm.



La società **Gielle Technoplast S.r.l.**, fondata nel 1977, si è specializzata nello stampaggio ad iniezione ed estrusione di articoli tecnici in materiale termoplastico.

L'esperienza maturata nei vari settori industriali, ha permesso con l'utilizzo di materie prime dalle molteplici caratteristiche, in stabilità dimensionale, eccellenti resistenze meccaniche e chimiche, ottime resistenze termiche, antiusura e bassa abrasività, di eseguire con successo processi



produttivi con garanzia di qualità avvalendosi di presse tecnologicamente avanzate, complete di computer di bordo, quanto necessario per una ripetibilità e costanza

qualitativa nella produzione con possibilità di realizzazione di prodotti con grammature da 20 a 1200 gr.

Le materie prime più utilizzate sono Nylon, Polipropilene, Politene, Acetalica, Policarbonato, Gomma termoplastica, PVDF, ETFE, PEEK e altri ancora, con cariche fibra vetro e fibra carbonio.

Il continuo accrescimento tecnologico e la conoscenza dei materiali, ci permette di progettare e realizzare stampi su esigenza dei clienti consigliando poi il materiale più idoneo allo stampaggio.

Per prototipi o piccole produzioni, la Gielle Technoplast dispone di un reparto per lavorazione meccanica di semilavorati plastici per eseguire con qualità e rapidità esecuzioni di taglio, tornitura, fresatura, rettifica, e saldatura.



GielleTechnoplast S.r.l., established in Milano in 1977, is specialized in injection and extrusion moulding of technical articles made in different thermoplastic materials.

Experience ripened in different industrial sectors over the years and the use of materials with different characteristics like dimensional stability, excellent mechanical and chemical strength, excellent thermal resistance, resistance to wear and low abrasive attitudes have allowed us to carry out production processes always with success and with quality guarantee.

Our technologically advanced presses, provided with their own computer, assure the same quality during the production processes and guarantee the execution of articles, whose weight ranges from 20 to 1200 gr.

The raw materials used are Nylon, Polypropylene, Polythene, Resins Acetyl, Polycarbonate, Thermoplastic Rubbers, PVDF, ETFE, PEEK and other materials, charged carbon fiber and fiber glass.

The continous growth of our technological and materials knowledge make us able to plan and realize moulds studied on our customer needs, suggesting also which is the most suitable material to be used for the moulding.



A mechanical manufacturing department of semi-finished for prototypes or small sets is available to make executions of works like cutting, turning, milling, grinding, and welding.



01. PIEDINI *LEVELLING ELEMENTS*



art.400 pag.18
 piedino regolabile base in pe e
 perno ferro zincocromato
pe based and zinc-plated steel stud



art.402 pag.19
 piedino regolabile base pe
 e perno ferro zincocromato
pe based and zinc plated steel stud



art.403 pag.20
 piedino regolabile in pp con esagono
 ch.17 e perno ferro zincocromato
*pp flat levelling element with ch.17
 exagon adjustment and zinc plated
 steel stud*



art.405 pag.20
 piedino regolabile base pa e perno
 ferro zincocromato
*levelling element pa based
 and zinc plated steel stud*



art.405 pag.21
 piedino regolabile base pa e perno
 ferro zincocromato girevole chiave 10
*levelling element pa based and zinc
 plated steel revolving stud mm 10*



art.405 pag.21
 piedino regolabile in pa - ghiera cromata
 perno fe zincocromato snodato chiave 10
*levelling element in pa chrome plated
 ferrule and zinc-plated steel joint stud
 mm 10*



art.407 pag.22
 piedino snodato con base piana
tilt glides with plane boack base



art.413 pag.23
 piedino regolabile base in pe esagonale
 ch.25 e gambo ferro zincocromato
*levelling element with ch.25 exagonal
 pe base and zinc plated steel stem*



art.402 pag.18
 piedino regolabile base cromata
 e perno ferro zincocromato
*levelling element chrome plated
 base and zinc plated steel stud*



art.403 pag.19
 piedino regolabile piatto in pp e
 perno in ferro zincocromato
pp based and zinc plated steel stud



art.404 pag.22
 piedino regolabile base plastica
 perno ferro zincocromato fondello
 cromato con quadro 12 mm di reg.
*adjustable foot plastic base Stud
 galvanized, zinc-chromated chrome
 base with 12 mm reg framework.*



art.405 pag.20
 piedino regolabile base plastica
 con gambo e ghiera in fe
 zincocromato
*non-tilt adjustable feet with plastic
 base and zinc plated*



art.405 pag.21
 piedino regolabile base pa e perno
 ferro zincocromato snodato chiave 10
*levelling element pa base and zinc
 plated steel joints stud mm 10*



art.407 pag.22
 piedino per gambe scrivania
levelling element for legs writing desk



art.408 pag.22
 piedino regolabile base in pa e perno
 ferro zincocromato girevole chiave 17
*levelling element pa base and zinc
 plated steel revolving stud mm 17*



art.414 pag.23
 piedino regolabile base in pp e
 perno ferro zincocromato
*levelling element pp base and
 zinc plated steel stud*



art.615 pag.23
sottopiede con chiodo e fondello cromato
buffer with rivet and chromate plate



art.616 pag.24
sottopiede con chiodo in pvc
pvc buffer with rivet

02. PROFILATI POGGIAPIEDI RIGIDI *STIFF FOOTREST PROFILE*



art.303 pag.25
profilato tipo tondo in pvc
pvc profile round type



art.304-305 pag.25
profilato tipo quadro e rettangolare in pvc
pvc square and rectangular profile



art.306 pag.26
sottopiede a pinza lungo in pe
pe saddle feet long type



art.316 pag.26
sottopiede a pinza con piuolo in pe
pe saddle feet with peg



art.316 pag.26
sottopiede a pinza a 2 piuoli in pe
pe saddle feet with two post



art.316 pag.27
sottopiede con base piana a pinza in pe
pe saddle feet flat base



art.316 pag.27
piedino a 90° antiribaltamento in pe
90° antiupsetting feet made in pe

03. PIEDINI ANGOLARI per SCAFFALATURE *ANGLE FEETS for SHELUNG*



art.406 pag.28
angolare in pe
pe angle



art.406 pag.28
angolare a "L" in pe
pe angle "L" type



art.406 pag.28

angolare a "T" in pe
pe angle "T" type



art.406 pag.28

angolare a "U" in pe
pe angle "U" type

04. VOLANTINI *HANDWHEELS - KNOBS*



art.500 pag.29-30

volantino in pa con perno ferro zincocromato
pa knobs with zinc plated steel stud



art.501 pag.31

volantino in pa con boccola ottone
pa knobs with brass insert



art.501 pag.31

volantino in pa con boccola ottone passante
pa knob with blind brass another threaded insert



art.512 pag.32

volantino triangolare in pa con boccola ottone
three-cornered knob in pa with brass insert



art.513 pag.32

volantino triangolare in pa con perno ferro zincocromato
three-cornered knob in pa with zinc plated steel stud



art.514 pag.32

volantino con tappo in pa con boccola ottone
pa knob with plug and brass insert



art.515 pag.33

volantino con tappo in pa e perno ferro zincocromato
pa knob with plug and zinc plated steel stud



art.516 pag.33

volantino margherita in pa con boccola ottone
pa knob with brass insert



art.517 pag.33

volantino a razze con maniglia fissa o scatto ribaltabile in termoindurente
four-spoke handwheel with fold away or fixed handle in the rhosetting material



art.518 pag.34

volantino a razze in termoindurente
four-spoke handwheel in thermosetting material



art.536 pag.34

volantino a fascia in pafv con maniglia fissa o scatto ribaltabile e mozzo ferro zincato
bar-pattern handwheel in pafv with fixed or fold away handle and zinc plated steel hub



art.535 pag.35

volantino a fascia in pafv con mozzo ferro zincato
bar-pattern hand wheel in pafv with zinc plated steel hub



art.550 pag.35
volantino in termoindurente a 3 punte
con mozzo ferro zincocromato
*three-arm knob in thermosetting
material with zinc plated steel hub*



art.509 pag.36
manopolina zigrinata in pa con perno
ferro zincocromato
*knurled knob in pa with zinc plated
steel stud*



art.506 pag.36
manopolina zigrinata in pa con perno
ferro zincocromato
*knurled knob in pa with zinc plated
steel stud*



art.915 pag.37
manopolina zigrinata in pa filettata
knurled knob in pa



art.519 pag.38
maniglia a ripresa in pafv con
pulsante e perno ferro
*pafv adjustable handle with
button and steel stud*



art.510 pag.39
impugnatura a galletto in pa con
perno ferro zincocromato
*pawing nut with zinc plated steel
stud*



art.511 pag.40
impugnatura a galletto in pa con
boccola ottone
pa wing nut with brass insert



art.522 pag.35
manopolina per cassette in abs
con boccola ottone
abs knob with brass insert



art.509 pag.36
manopolina zigrinata in pa filettata
femmina
knurled knob in pa female thread



art.507 pag.36
manopolina zigrinata in pa con
boccola ottone
knurled knob in pa with brass insert



art.519 pag.37
maniglia a ripresa in pafv con
pulsante e boccola ottone filettata
*pafv adjustable handle with
button and brass insert*



art.510 pag.39
impugnatura a galletto in pa con
boccola ottone cieca
pa wingnut with blind brass insert



art.510 pag.39
impugnatura a galletto in pa con
boccola ottone
pa wing nut with brass insert



art.511 pag.40
impugnatura a galletto in pa con
perno ferro zincocromato
*pa wing nut with zinc plated steel
stud*



05. SFERE BALL KNOBS



art.504 pag.41

sfera con foro filettato in abs
abs ball knob with threaded hole



art.505 pag.42

sfera con foro filettato in
termoindurente
*ball knob in thermo setting material
with threaded hole*



art.505/1 pag.43

sfera con foro liscio in ps
ps ball knob with smooth hole



art.505 pag.41

sfera con boccia ottone filettata in pa
pa ball knob with brass thru-insert



art.504 pag.43

sfera con foro liscio in abs
abs ball knobs with smooth hole

06. MANIGLIE E MANOPOLE HANDLES



art.525 pag.44

maniglia in abs
abs handle



art.526 pag.44

maniglia in abs
abs handle



art.526 pag.44

maniglia in abs
abs handle



art.526 pag.44

maniglia curva in pp
pp curved handle



art.130 pag.45

maniglia a ponte in pa
con foro passante per vite
brugola
*u-handle in pa with trou
hole*



art.140 pag.45

maniglia a ponte in pa
con boccia ottone
filettata
*u-handle in pa with
threaded brass insert*



art.150 pag.45

maniglia a ponte in pa
con perno in fe
zincocromato
*u-handle in pa with zinc
plated steel stud*



art.120 pag.46

maniglia a ponte in pa
u-handle in pa



art.523 pag.46

maniglione in termoidurente con boccola ottone
u-handle in thermosetting material with brass insert



art.527 pag.47

maniglia incasso in ps
ps recessed handle



art.528 pag.47

maniglia scatto da incasso in ps
trip handle in ps



art.530 pag.48

maniglia rotonda con bordo sporgente da incasso in abs
round handle with protruded edge in abs



art.502 pag.49

maniglia in pa con perno girevole
pa revolving handle with key



art.920 pag.50

manopola in pvc
pvc handle



art.922 pag.50

manopola rigata in pvc
pvc handle



art.532 pag.46

maniglia trapezoidale bassa in termoidurente
low trapezoidal handle in thermosetting material



art.528 pag.47

maniglia incasso in abs
abs recessed handle



art.529 pag.48

maniglia rotonda interno liscio da incasso in ps
round handle smooth inside in ps



art.503 pag.48

maniglia in pa con foro filettato
pa handle with threaded hole



art.524 pag.49

maniglia ogivale in termoidurente con foro filettato
handle in thermosetting material with threaded hole



art.921 pag.50

manopola in pvc
pvc handle



art.923 pag.50

manopola in pvc
pvc handle



art.929 pag.51

manopola in pa asta
manovra foro passante

pa handle thru hole



art.930 pag.51

manopola rigata in pvc
foro passante

pvc handle thru hole



art.931 pag.51

manopola in pe

pe handle

07. PARTICOLARI per USO INTERNO TUBO COMPONENTS for INTERNAL USE



art.600 pag.52

puntale alettato rotondo in pe

round ribbed insert in pe



art.608 pag.53

puntale alettato rotondo in pp filettato
m10

round ribbed insert in pp thread m10



art.607 pag.53

puntale alettato con zoccolo inclinato
30° in pe

*ribbed insert in pe with 30° inclined
base*



art.604 pag.53

puntale alettato inclinato 30° in pe

ribbed insert 30° inclined in pe



art.612 pag.54

puntale liscio in pvc, alettato in pe

*smooth insert in pvc, ribbed insert
in pe*



art.700 pag.54

puntale copritesta alettato a testa
sferica in pe

ribbed cap spherical head in pe



art.701 pag.55

copritesta alettato in pe

ribbed cap in pe



art.705 pag.55

copritesta alettato in pe con testa in
metallo cromato

*ribbed cap in pe with chromate
metal head*



art.707 pag.56-57

copritesta tondo liscio in abs

smooth cap in abs



art.741 pag.57

copriforo per serramenti in pvc

insert for locks in pvc



art.602 pag.58

puntale quadro alettato in pe

square ribbed insert in pe



art.609 pag.58

puntale alettato quadro in pp
filettato m10

*square ribbed insert thread m10
in pp*



art.605 pag.59
puntale quadro alettato inclinato
30° in pe
*square ribbed insert 30° inclined
in pe*



art.702 pag.59
copritesta alettato quadro in pe
square ribbed cap in pe



art.708 pag.60-61
copritesta liscio - quadro in abs
square smooth cap in abs



art.603 pag.62
puntale rettangolare alettato in
pe
rectangular ribbed insert in pe



art.606 pag.63
puntale rettangolare alettato
inclinato 20° in pe
*rectangular ribbed insert 20°
inclined in pe*



art.606 pag.63
puntale rettangolare inclinato
30° alettato a zoccolo in pe
*rectangular ribbed insert 30°
inclined head in pe*



art.738 pag.64
copritesta rettangolare in pe con
testa in metallo cromato
*rectangular ribbed cap in pe
with chromate metal head*



art.611 pag.65
puntale ellisse alettato in pe
elliptical ribbed insert in pe



art.601 pag.66
puntale ovale alettato in pe
oval ribbed insert in pe



art.709 pag.59
copritesta - puntale quadro
alettato in pe
square cap - insert, ribbed in pe

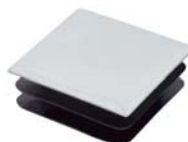

art.719 pag.60
copritesta alettato quadro in pe
con testa in metallo cromato
*square ribbed cap in pe, with
chromate metal head*



art.603 pag.61
puntale rettangolare sagomato
in pe
rectangular ribbed insert in pe



art.610 pag.63
puntale rettangolare alettato in
pp filettato m10
*rectangular ribbed insert in pp
thread m10*



art.606 pag.63
puntale rettangolare alettato
inclinato 30° in pe
*rectangular ribbed insert 30°
inclined in pe*



art.704 pag.64
copritesta rettangolare alettato
in pe
rectangular ribbed cap in pe



art.739 pag.65
copritesta rettangolare liscio in
abs
rectangular smooth cap in abs



art.718 pag.66
copritesta ellisse in pe
elliptical ribbed cap in pe



art.601 pag.66
puntale ovale alettato in pp
filettato m10
*oval ribbed insert in pp, thread
m10*



art.601 pag.66
puntale ovale inclinato 12,5° in pe
oval ribbed insert 12,5° inclined in pe



art.703 pag.67
copritesta puntale ovale testa alta in pe
oval ribbed insert, high head, in pe



art.736 pag.67
copritesta ovale in pe con testa in metallo cromato
oval ribbed cap in pe with chromate metal head



art.703 pag.67
copritesta ovale alettato in pe
oval ribbed cap in pe



art.703 pag.67
puntale copritesta semi ovale in pe
semi-oval ribbed insert in pe



art.737 pag.68
copritesta ovale liscio in abs
oval smooth cap in abs

08. PARTICOLARI per USO ESTERNO TUBO COMPONENTS for EXTERNAL USE



art.630 pag.69
calzante export in pvc
out side cap in pvc



art.632 pag.70
calzante botte in pvc
out side cap, barrel shape, in pvc



art.636 pag.71
calzante cilindrico in pvc
out side cap cylindrical shape in pvc



art.740 pag.71
calzante sfera in pvc
out side cap ball shape in pvc



art.635 pag.72
calzante rettangolare esterno per piatto in pvc
rectangular out side cap in pvc



art.631 pag.70
calzante campana a base larga in pvc
out side cap, wide base, in pvc



art.633 pag.70
calzante bombato lungo in pvc
out side cap, long shape in pvc



art.637 pag.71
calzante piede letto in politene
out side cap for bed foot in pe



art.638 pag.71
calzante inclinato 20° in pvc
out side cap 20° inclined in pvc



art.639 pag.72
calzante esterno ovale in pvc
oval out side cap in pvc

art.639 pag.72

calzante ovale con base inclinata in pvc

oval out side cap inclined base in pvc

art.652 pag.73

puntale rettangolare curvo dentato in pvc

rectangular insert in pvc

art.640 pag.73

calzante tondo in pe

round out side cap in pe

art.650 pag.74

calzante artiglio tondo in pvc

clawed out side cap in pvc

art.651 pag.72

calzante rettangolare inclinato in pvc

rectangular out side cap inclined in pvc

art.649 pag.73

calzante pera in pvc

out side cap in pvc

art.653 pag.74

calzante scale pera ovale in pvc

oval ladder out side cap in pvc

art.650 pag.74

calzante artiglio ovale in pvc

oval clawed out side cap in pvc

09. VENTOSE SUCKERS

art.713 pag.75

ventosa con gambo forato in pvc

pvc sucker with drilled shank

art.715 pag.76

ventosa con sottosquadra in pvc

pvc sucker with back-draft

art.714 pag.75

ventosa con sfera a sottosquadra in pvc

pvc sucker with ball

art.916 pag.76

ventosa in pvc con gambo filettato 8 ma

pvc sucker with threaded shank m8

10. PASSAFILI WIRE PROTECTION AND CABLE

art.300-301 pag.77

passafilo a bussola in pvc

wire and cable protection in pvc

art.302 pag.77

passafilo con membrana in pvc

webbed wire and cable protection in pvc

art.302 pag.78

passafilo in pvc

webbed wire and cable protection in pvc



11. RONDELLE WASHERS



art.313 pag.79

rondella sottovite in pe HD
pe hd washer



art.735 pag.79

rondella paracolpo in pvc
buffer washer in pvc



art.311 pag.79

rondella foro svasato in pvc
counter sunk head washer in pvc

12. DISTANZIATORI e PARACOLPI SPACERS and BUFFERS



art.733 pag.80

tubetto distanziatore in pe
pe spacer



art.733 pag.80

tubetto paracolpo cieco tondo in pvc

round blind buffer in pvc



art.733 pag.80

distanziatore conico in pe
conical spacer in pe



art.733 pag.81

distanziatore liscio in pe
smooth spacer in pe



art.732 pag.81

tubetto distanziatore con incavo in pp
spacer with cavity in pp



art.732 pag.81

distanziatore con incavo in pe
spacer with cavity in pe



art.720 pag.81

paracolpo a fungo testa tonda in pvc morbido
round head buffer in soft pvc



art.721 pag.82

paracolpo a fungo testa bombata in pvc morbido
round head buffer in soft pvc



art.722 pag.82

paracolpo a fungo testa piatta in pvc morbido
flat head buffer in soft pvc



art.722 pag.82

paracolpo testa cilindrica in pvc
cylindrical head buffer in pvc



art.722 pag.82

paracolpo a fungo testa bassa in pe e pvc
low head buffer in pe and pvc



art.723 pag.83

paracolpo a fungo testa rettangolare in pvc morbido
rectangular head buffer in soft pvc



art.724 pag.83

paracolpo testa bombata tipo "A" in pvc morbido

buffer type "A" in soft pvc



art.724 pag.83

paracolpo testa bombata tipo "B" in pvc morbido

buffer type "B" in soft pvc



art.724 pag.83

paracolpo testa rotonda tipo "C" in pvc morbido

buffer type "C" in soft pvc



art.725 pag.84

paracolpo a fungo gambo lungo in pvc morbido

buffer with long shank in soft pvc



art.728 pag.84

paracolpo con incavo cilindrico in pvc

buffer with cylindrical cavity in pvc



art.729 pag.84

paracolpo con incavo in pvc

buffer with cavity in pvc



art.730 pag.85

paracolpo troncoconico in pvc

conical buffer in pvc



art.731 pag.85

paracolpo ferma porte in pvc

door-stop buffer in pvc

13. BOCCOLE *BUSHINGS*



art.901 pag.86

boccola in pa con bordo

pa bushing with edge



art.902 pag.86

boccola in pa con bordo

pa bushing with edge



art.903 pag.86

boccola in pa con bordo

pa bushing with edge



art.904 pag.86

boccola in pa rigata con bordo

grooved bushing in pa with edge



art.905 pag.87

boccola in pa con bordo

pa bushing with edge



art.906 pag.87

boccola in pa con bordo

pa bushing with edge



art.907 pag.87

boccola in pa liscia

smooth bushing in pa



art.210 pag.87

morsetto fermatubo completo in pa

complete clamping-lug in pa



14. COPRICROCIERE WRAPPERS



art.211 pag.88
calotta copricrociera in abs
wrapper in abs



art.212 / 213 pag.88
terminale portaruota in abs e
copritesta
*end outside cap for levelling
element in abs, and covering*

15. INNESTI in ABS per TUBO QUADRO ABS CLUTCH for SQUARE TUBES

Tubo mm 20x20 spessore 1,2
Tube 20x20 mm thickness 1,2



art.412 pag.89-90
mod. a "3 vie"
"3 ways" mod.

Tubo mm 25x25 spessore 1,2
Tube 25x25 mm thickness 1,2



art.412 pag.91
mod. a "3 vie"
"3 ways" mod.

16. ARTICOLI VARI OTHER ARTICLES



art.205 pag.92
pinza in pa per faretto spot
pa plier for spot lights



art.806 pag.92
attaccapanni in abs
hanger in abs



art.812 pag.92
vaschetta porta gesso per
lavagna in pp
*little container in pp for
chalk*



art.812 pag.92
vaschetta portamatite in ps
little container penholder in ps



art.812 pag.93
passacavo per scrivania in ps
ps cable channel for desk



art.809 pag.93
bacinella in pp per porta ombrelli
umbrella stand trayer in pp



art.810 pag.93
vaschetta in pp porta om-
brelli per spogliatoi
*umbrella stand bowl for
dressing room made in pp*



art.801 pag.93
blocchetto reggipiani in pe hd
pe hd shelf support



art.801 pag.94

mensola reggipiano in pa
pa shelf support



art.950 pag.94

crociera per stender in zama zincata

star wheel for column clothes galvanized zama



art.808 pag.94

griglia per comodini in pe hd
pe hd grating for night tables



art.800 pag.95

paraspigolo in pe per mobili
pe corner cover for furnitures



art.734 pag.95

carrucola in pa con gola per tubo
ø 20

pa pulley with rim for tube ø 20



art.815 / 816 pag.95

cuscinetto a sfera in pa
pa ball bearing

17. NUOVI RIFERIMENTI *NEW ADDS*



art.415 pag.24

piedino regolabile quadro con base
ottogonale in pa

*adjustable foot square
base octagonal in pa*



art.415 pag.24

piedino regolabile quadro con
base rotonda con esagono il pa

*adjustable foot square with
round base with Hexagon pa*



art.400

PIEDINO REGOLABILE BASE IN PE E PERNO FERRO ZINCOCROMATO
PE BASED AND ZINC PLATED STEEL STUD

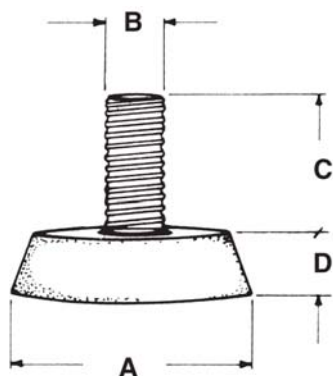

Codice code	AxB	C	D
400039INPRC2	23x8 MA	20	12
400040INPRC2	23x10 MA	20	12
400001NNPR2	25x8 MA	25	11
400002NNPR2	25x10 MA	25	11
400003NNPR2	25x10 MA	60	11
400004NNPR2	30x8 MA*	25	11
400007GNPR2	30x10 MA*	25	11
400006NNPR2	30x8 MA	25	11
400008NNPR2	30x10 MA	25	11
400009NNPR2	40x8 MA	25	11
400010NNPR2	40x10 MA	25	11
400012NNPR2	50x10 MA	25	11
400013NNPR2	50x10 MA	40	11
400014NNPR2	50x12 MA	50	11
400015NNPR2	50x12 MA•	50	11
400050INPR2	60x10 MA	37	17
400051INPR2	60x12 MA	37	17

* Zigrinato

• con dado

colore standard Nero

* Knurled

• with nut

standard colour Black

art.402

PIEDINO REGOLABILE BASE CROMATA E PERNO FERRO ZINCOCROMATO
LEVELLING ELEMENT CHROME PLATED BASE AND ZINC PLATED STEEL STUD

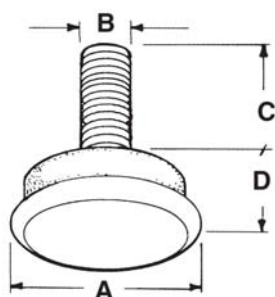

Codice code	AxB	C	D
402010INRFC2	30x8 MA	25	12,5
402011INRFC2	30x10 MA	25	12,5
402012INRFC2	40x8 MA	25	13
402013INRFC2	40x10 MA	25	13

colore standard Nero
standard colour Black

PIEDINO REGOLABILE BASE PE E PERNO FERRO ZINCOCROMATO
PE BASED AND ZINC PLATED STEEL STUD
art.402

Codice code	AxB	C	D
402020MPN2	50x8 MA	25	15
402021MPN2	50x10 MA	25	15
402022MPN2	60x8 MA	25	15
402023MPN2	60x10 MA	32	15
402024MPN2	60x12 MA	30	15

colore standard Nero

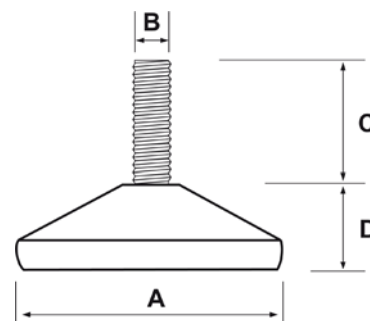
standard colour Black

PIEDINO REGOLABILE PIATTO IN PP E PERNO IN FERRO ZINCOCROMATO
PP BASED AND ZINC PLATED STEEL STUD
art.403

Codice code	AxB	C	D
403049MPRP9	25x6	22	11
403050MPRP9	25x8	22	11
403051MPRP9	25x10	22	11
403052MPRP9	30x8	22	11
403053MPRP9	30x10	22	11
403054MPRP9	40x8	22	11
403055MPRP9	40x10	22	11
403056MPRP9	50x8	32	11
403057MPRP9	50x10	32	11
403058MPRP9	60x8	32	11
403059MPRP9	60x10	32	11
403060MPRP9	80x8	32	11
403061MPRP9	80x10	32	11
403062MPRP9	110x8	30	18
403063MPRP9	110x10	40	18
403064MPRP9	110x12	40	18
403065MPRP9	150x8	40	18
403066MPRP9	150x10	40	18
403067MPRP9	150x12	40	18

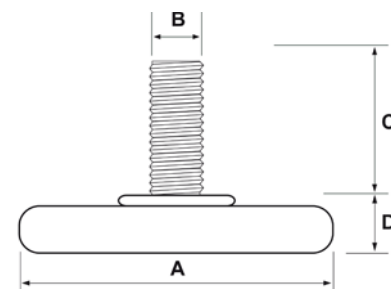
colore standard Nero

standard colour Black



art.403

PIEDINO REGOLABILE IN PP CON ESAGONO CH.17 E PERNO FERRO ZINCOCROMATO
PP FLAT LEVELLING ELEMENT WITH CH.17 EXAGON ADJUSTMENT AND ZINC PLATED STEEL STUD

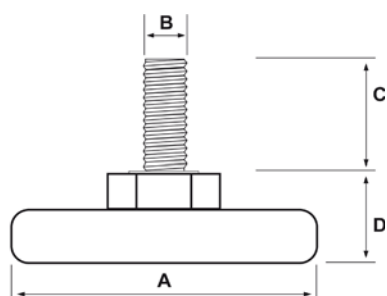

Codice code	AxB	C	D
403001MPRPE9	30x8	22	16
403002MPRPE9	30x10	22	16
403003MPRPE9	40x8	22	16
403004MPRPE9	40x10	22	16
403006MPRPE9	50x8	25	16
403007MPRPE9	50x10	25	16
403009MPRPE9	60x8	25	16
403011MPRPE9	60x10	25	16

colore standard Nero
standard colour Black

art.405

PIEDINO REGOLABILE BASE PLASTICA CON GAMBO E GHIERA IN FE ZINCOCROMATO
NON-TILT ADJUSTABLE FEET WITH PLASTIC BASE AND ZINC PLATED

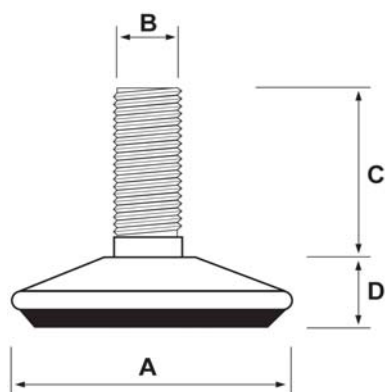

Codice code	AxB	C	D
405004ICR3	20x6 MA	13	7
405005ICR3	25x8 MA	20	10
405006ICR3	25x10 MA	20	10
405007ICR3	30x8 MA	20	11,5
405008ICR3	30x10 MA	20	11,5
405009ICR3	35x8 MA	20	12
405010ICR3	35x10 MA	20	12
405011ICR3	40x8 MA	25	13,5
405012ICR3	40x10 MA	25	13,5
405013ICR3	50x10 MA	30	15,5
405014ICR3	50x12 MA	35	15,5

colore standard Nero
standard colour Black

art.405

PIEDINO REGOLABILE BASE PA E PERNO FERRO ZINCOCROMATO
LEVELLING ELEMENT PA BASED AND ZINC PLATED STEEL STUD

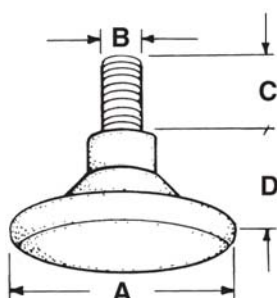

Codice code	AxB	C	D
405001NNSC3	55x8 MA	30	30
405002NNSC3	55x10 MA	30	30

colore standard Nero
standard colour Black

PIEDINO REGOLABILE BASE PA E PERNO FERRO ZINCOCROMATO GIREVOLE CHIAVE 10
LEVELLING ELEMENT PA BASED AND ZINC PLATED STEEL REVOLUING STUD mm 10

art.405

Codice code	AxB	C	D	E
405020INRG3	40x10 MA	25	11,5	6
405021INRG3	50x10 MA	30	13	6
405022INRG3	50x12 MA	35	13	6

colore standard Nero
standard colour Black

disponibile anche con ghiera Cromata
also available with Chrome plated ferrule

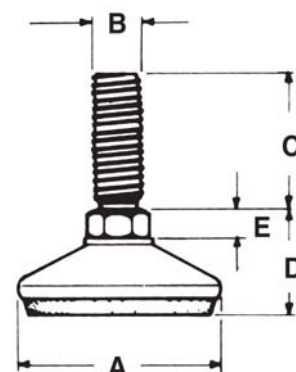

PIEDINO REGOLABILE IN PA - GHIERA CROMATA PERNO FE ZINCOCROMATO SNODATO CHIAVE 10
LEVELLING ELEMENT IN PA CHROME PLATED FERRULE AND ZINC-PLATED STEEL JOINT STUD mm 10

art.405

Codice code	AxB	C	D	E
405040ICRS3	35x10 MA	10	5	12
405041ICRS3	35x10 MA	20	5	12
405042ICRS3	35x10 MA	30	5	12
405043ICRS3	50x10 MA	10	5	16
405044ICRS3	50x10 MA	20	5	16
405045ICRS3	50x10 MA	30	5	16

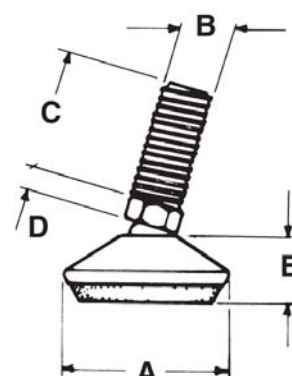

PIEDINO REGOLABILE BASE PA E PERNO FERRO ZINCOCROMATO SNODATO CHIAVE 10
LEVELLING ELEMENT PA BASE AND ZINC PLATED STEEL JOINTS STUD mm 10

art.405

Codice code	AxB	C	D	E
405050INRS3	26x10 MA	10	5	11,5
405051INRS3	26x10 MA	20	5	11,5
405052INRS3	26x10 MA	30	5	11,5

colore standard Nero
standard colour Black

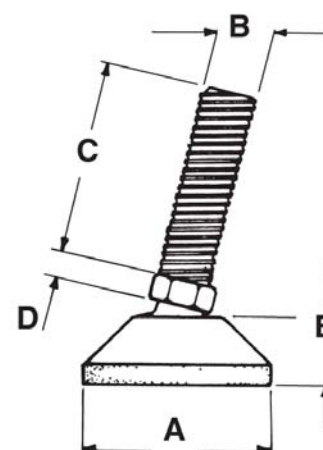



art.408

PIEDINO REGOLABILE BASE IN PA E PERNO FERRO ZINCOCROMATO GIREVOLE CHIAVE 17
 LEVELLING ELEMENT PA BASE AND ZINC PLATED STEEL REVOLVING STUD mm 17

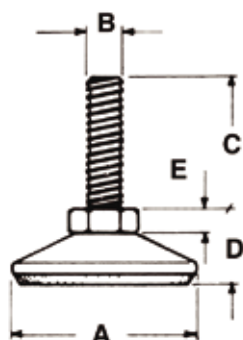

Codice code	AxB	C	D	E
408001INPRG3	40x10MA	40	11,5	6,5
408002INPRG3	40x10MA	60	11,5	6,5
408003INPRG3	50x10MA	40	13	6,5
408004INPRG3	50x10MA	60	13	6,5

colore standard Nero
 standard colour Black

disponibile anche con ghiera Cromata
 also available with Chrome plated ferrule

art.407

PIEDINO PER GAMBE SCRIVANIA
 LEVELLING ELEMENT FOR LEGS WRITING DESK

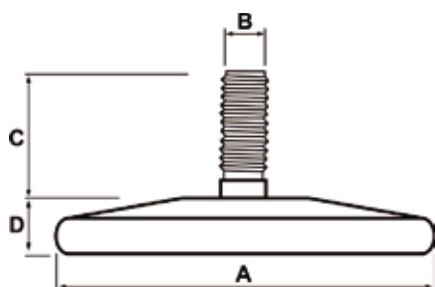

Codice code	AxB	C	D
407007INPGS3	60x8 MA	35	7
407008INPGS3	60x10 MA	35	7
407001INPGS3	80x8 MA	20	14
407002INPGS3	80x10 MA	20	14
407003INPGS3	100x8 MA	20	18
407004INPGS3	100x8 MA	25	18
407005INPGS3	100x10 MA	20	18
407006INPGS3	100x10 MA	25	18

colore standard Nero
 standard colour Black

art.404

PIEDINO REGOLABILE BASE IN PA PERNO FERRO ZINCOCROMATO
 FONDELLO CROMATO CON QUADRO 12 MM DÌ REGOLAZIONE
 ADJUSTABLE FOOT BASE IN PA STUD GALVANIZED, ZINC-CHROMATED
 CHROMED BASE with 12 MM DÌ ADJUSTING

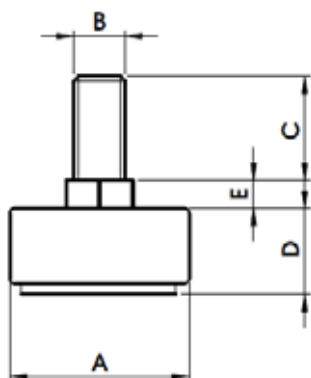

Codice code	AxB	C	D	E
404002ERC 2	35x10MA	20	14,5	5

PIEDINO SNODATO CON BASE PIANA
TILT GLIDES WITH PLANE BOACK BASE
art.407

Codice code	AxB	C	D	E
407020INPS3	80x10 MA	20	15	4
407021INPS3	80x10 MA	30	15	4
407022INPS3	100x100 MA	20	21	4
407023INPS3	100x10 MA	30	21	4

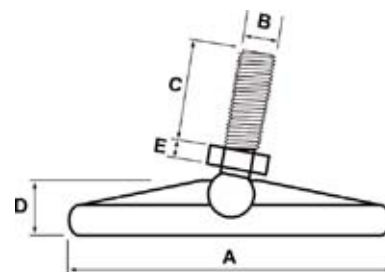

colore standard Nero
standard colour Black

PIEDINO REGOLABILE BASE IN PE ESAGONALE CH.25 E GAMBO FERRO ZINCOCROMATO
LEVELLING ELEMENT WITH CH.25 EXAGONAL PE BASE AND ZINC PLATED STEEL STEM
art.413

Codice code	AxB	C	D
413001MPNPRE2	25x8 MA	22	7
413002MPNPRE2	25x10 MA	22	7
413003MPNPRE2	25x8 MA	35	8
413004MPNPRE2	25x10 MA	35	8

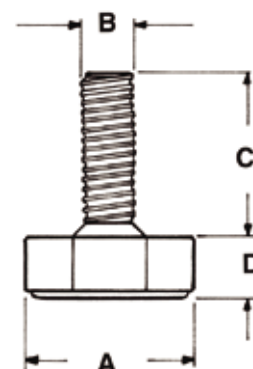

colore standard Nero
standard colour Black

PIEDINO REGOLABILE BASE IN PP E PERNO FERRO ZINCOCROMATO
LEVELLING ELEMENT PP BASE AND ZINC PLATED STEEL STUD
art.414

Codice code	AxB	C	D
414001MNPR7	50x8 MA	28	25
414002MNPR7	50x10 MA	28	25
414003MNPR7	60x8 MA	28	28
414004MNPR7	60x10 MA	28	28
414005MNPR7	60x8 MA	28	40
414006MNPR7	60x10 MA	28	40

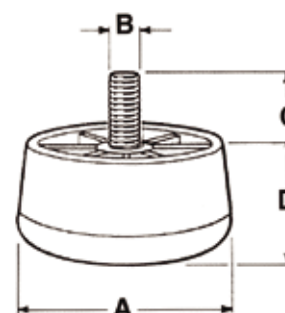

colore standard Nero
standard colour Black

art.415

PIEDINO REGOLABILE QUADRO CON BASE OTTAGONALE IN PA
ADJUSTABLE FOOT OCTAGONAL-BASED FRAMEWORK IN PA

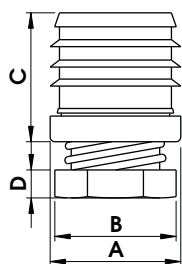

Codice code	A	B	C	D
415001INPR3	30x30	26	28	6

PIEDINO REGOLABILE QUADRO CON BASE ROTONDA CON ESAGONO IN PA
ADJUSTABLE FOOT WITH ROUND BASE WITH HEXAGON IN PA

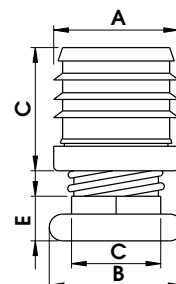

Codice code	A	B	C	D	E
415200INPR3	30x30	30	21	28	12

art.615

SOTTOPIEDE CON CHIODO E FONDELLO CROMATO
BUFFER WITH RIVET AND CHROMATE PLATE

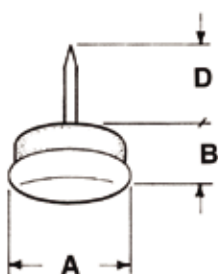

Codice code	A	B	D
615001IMSFCC2	15	8	16
615002IMSFCC2	18	10	16
615003IMSFCC2	20	11	14
615004IMSFCC2	23	11	18
615005IMSFCC2	26	11	18
615006IMSFCC2	30	11	18
615007IMSFCC2	40	11	22

art.616

SOTTOPIEDE CON CHIODO IN PVC
PVC BUFFER WITH RIVET

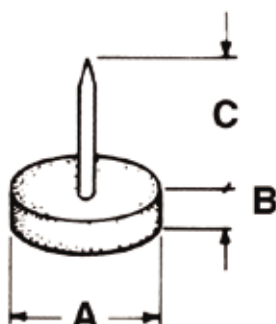

Codice code	A	B	C
616001INPC1	15	7	15
616002INPC1	15	12	15
616003INPC1	20	6	15
616004INPC1	25	9	19

colore standard Nero
standard colour black

a richiesta colore Bianco
White colour on request

PROFILATO TIPO TONDO IN PVC

PVC PROFILE ROUND TYPE

Codice code	Misura Ø size Ø	Minimo Ordine minimum order
303013MNPT1	7,5	mt. 200
303001MNPT1	10	mt. 200
303014MNPT1	12	mt. 200
303002MNPT1	14	mt. 200
303003MNPT1	16	mt. 150
303004MNPT1	18	mt. 100
303005MNPT1	20	mt. 100
303006MNPT1	22	mt. 100
303007MNPT1	25	mt. 100
303008MNPT1	28	mt. 50
303009MNPT1	30	mt. 50
303010MNPT1	32	mt. 50
303011MNPT1	35	mt. 50
303012MNPT1	40	mt. 40

lunghezza standard mt. 2
standard lenght mt. 2

colore Nero
Black colour

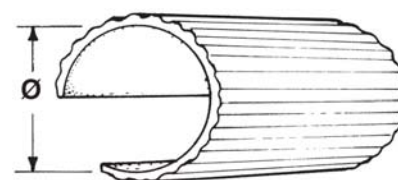

art.303

PROFILATO TIPO QUADRO E RETTANGOLARE IN PVC

PVC SQUARE AND RECTANGULAR PROFILE

Codice code	A	B	Minimo Ordine minimum order
304001MNPQ1	20	20	mt. 100
304002MNPQ1	25	25	mt. 64
304003MNPQ1	30	30	mt. 64
305001MNPRI	40	20	mt. 48
305002MNPRI	50	25	mt. 36
305003MNPRI	60	25	mt. 24

lunghezza standard mt. 2
standard lenght mt. 2

colore Nero
Black colour

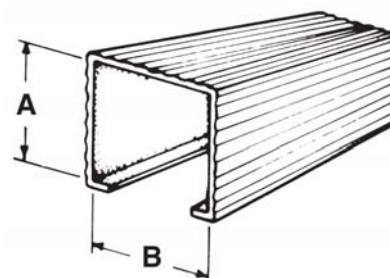

art.304-305

art.306

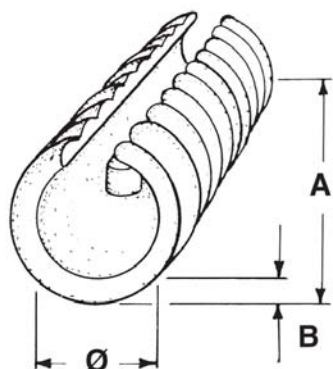

SOTTOPIEDE A PINZA LUNGO IN PE
PE SADDLE FEET LONG TYPE

Codice code	Misura Ø size Ø	Piuolo Ø peg Ø	A	B
306001INSPL2	18-20	6	46	4,5
306002INSPL2	24-26	8	46	5
306003INSPL2	28-30	8	46	5,5

colore standard Nero
standard colour black

a richiesta anche colore Bianco
White colour on request

art.316

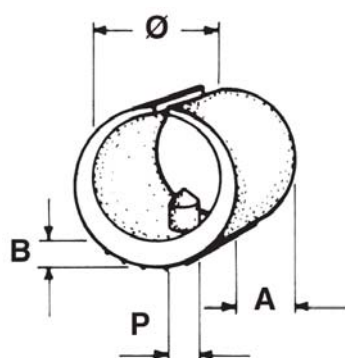

SOTTOPIEDE A PINZA CON PIUOLO IN PE
PE SADDLE FEET WITH PEG

Codice code	Misura Ø size Ø	Piuolo Ø peg Ø	A	B
316015CPNSP2	10-12	4	19	4
316001INSP2	14-16	5,5	18	3,5
316002INSP2	16-18	5,5	19	3,5
316003INSP2	18-20	5,5	20	3,5
316004INSP2	20-22	5,5	22	4
316017CPNSP2	22-24	4	22	4
316005CPNSP2	24-26	5,5	25	5
316007INSP2	24-26	7,5	25	5
316006INSP2	28-30	7,5	30	5,5

colore standard Nero
standard colour black

a richiesta anche colore Bianco
White colour on request

disponibilità senza piuolo misure 18-20 e 24-26
available without any peg size 18-20 and 24-26

art.316

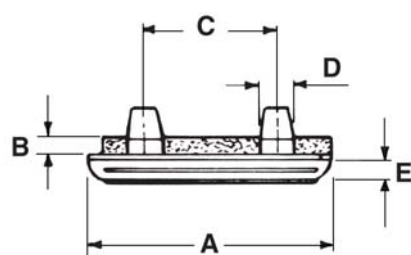

SOTTOPIEDE A PINZA A 2 PIUOLI IN PE
PE SADDLE FEET WITH TWO POST

Codice code	A	B	C	D	E
316014INP22	33	13,5	18	4,5	2,5

colore standard Nero
standard colour Black

art.316

SOTTOPIEDE CON BASE PIANA A PINZA IN PE

PE SADDLE FEET FLAT BASE

Codice code	BXC	Tubo tube	A
316049INBPP2	17x24	8	12,5
316050INBPP2	19x30	10	14,5
316051INBPP2	22x31	12	16,5
316052INBPP2	24x33	14	18

colore standard Nero
standard colour black

a richiesta anche colore Bianco
White colour on request

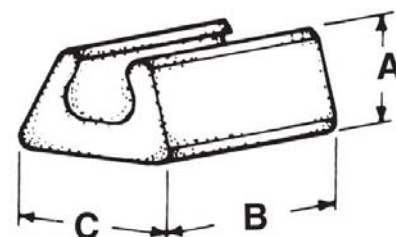

art.316

PIEDINO A 90° ANTIRIBALTAMENTO IN PE

90° ANTIUPSETTING FEET MADE IN PE

Codice code	A	B	C	D
316060INPA2	106	100	Ø 25	Ø 5,5

colore standard Nero
standard colour black

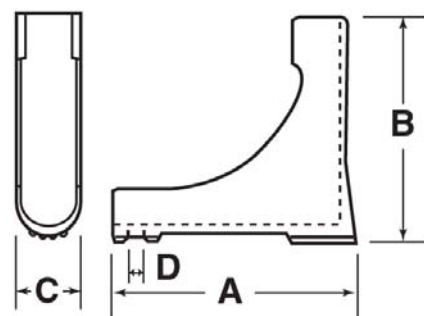

art.406

ANGOLARE IN PE PE ANGLE

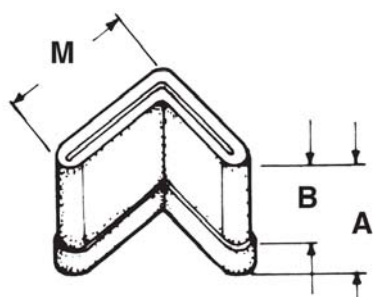

Codice code	Misura size	A	B
406001INA2	20x20x2	20	15
406002INA2	25x25x2	24	19
406011INA2	27x27x1,5	11,5	9,5
406003INA2	30x30x2	24	19
406004INA2	35x35x2	24	19
406005NNA2	35x35 aperto x2 35x35 open x2	21	15
406006NNA2	40x40x2	24	19

colore standard Nero
standard colour Black

art.406

ANGOLARE A "L" IN PE PE ANGLE "L" TYPE

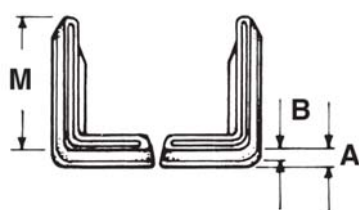

Codice code	Misura size	A	B
406016INA2	35x55x2	12,5	9,5
406017INA2	20x40x2	13	10
406007NNA2	60x35x2	21	15

(destro e sinistro) colore standard Nero
(right and left) standard colour Black

art.406

ANGOLARE A "T" IN PE PE ANGLE "T" TYPE

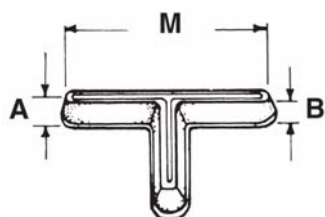

Codice code	Misura size	A	B
406008NNA2	70x55x2	21	14
406017INA2	70x35x2	12,5	10

colore standard Nero
standard colour Black

art.406

ANGOLARE A "U" IN PE PE ANGLE "U" TYPE

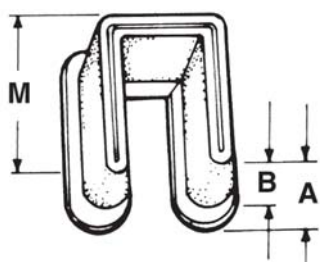

Codice code	Misura size	A	B
406010INA2	35x30x35x2	25	18
406009NNA2	45x30x45x2	21	17

colore standard Nero
standard colour Black

art.500

VOLANTINO IN PA CON PERNO FERRO ZINCOCROMATO
PA KNOBS WITH ZINC PLATED STEEL STUD

Codice code	Ø Dxd	L	H	h	d1
500001NNVP3	20x4 MA	10	12	3	12
500002NNVP3	20x4 MA	15	12	3	12
500003NNVP3	20x4 MA	20	12	3	12
500010NNVP3	20x5 MA	10	12	3	12
500012NNVP3	20x5 MA	15	12	3	12
500013NNVP3	20x5 MA	20	12	3	12
500021NNVP3	20x6 MA	10	12	3	12
500022NNVP3	20x6 MA	15	12	3	12
500023NNVP3	20x6 MA	20	12	3	12
500031NNVP3	25x5 MA	15	13	5	14
500032NNVP3	25x5 MA	20	13	5	14
500034NNVP3	25x5 MA	11	13	3	14
500033NNVP3	25x5 MA	30	13	5	14
500042NNVP3	25x6 MA	15	13	5	14
500043NNVP3	25x6 MA	20	13	5	14
500044NNVP3	25x6 MA	30	13	5	14
500061NNVP3	30x6 MA	10	25	13	20
500062NNVP3	30x6 MA	15	25	13	20
500063NNVP3	30x6 MA	20	25	13	20
500064NNVP3	30x6 MA	25	25	13	20
500065NNVP3	30x6 MA	30	25	13	20
500070NNVP3	30x6 MA	40	25	13	20
500081NNVP3	30x8 MA	15	25	13	20
500082NNVP3	30x8 MA	20	25	13	20
500083NNVP3	30x8 MA	25	25	13	20
500084NNVP3	30x8 MA	30	25	13	20
500085NNVP3	30x8 MA	50	25	13	20
500102NNVP3	40x6 MA	15	25	13	20
500103NNVP3	40x6 MA	20	25	13	20
500104NNVP3	40x6 MA	25	25	13	20
500105NNVP3	40x6 MA	30	25	13	20
500106NNVP3	40x6 MA	40	25	13	20
500122NNVP3	40x8 MA	15	25	13	20
500123NNVP3	40x8 MA	20	25	13	20
500124NNVP3	40x8 MA	25	25	13	20
500125NNVP3	40x8 MA	30	25	13	20
500127NNVP3	40x8 MA	40	25	13	20

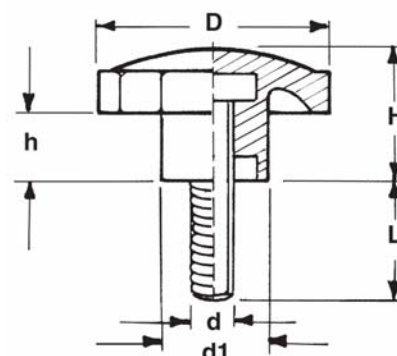

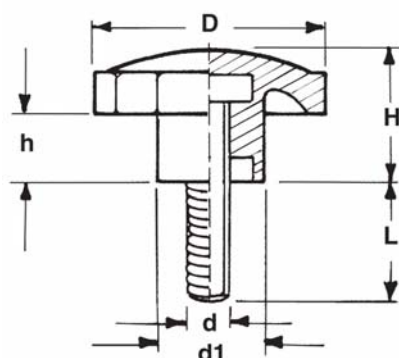

Codice code	Ø Dxd	L	H	h	d1
500128NNVP3	40x8 MA	50	25	13	20
500141NNVP3	40x10 MA	15	25	13	20
500142NNVP3	40x10 MA	20	25	13	20
500143NNVP3	40x10 MA	25	25	13	20
500144NNVP3	40x10 MA	30	25	13	20
500145NNVP3	40x10 MA	40	25	13	20
500161NNVP3	50x8 MA	20	25	13	23
500162NNVP3	50x8 MA	25	25	13	23
500163NNVP3	50x8 MA	30	25	13	23
500165NNVP3	50x8 MA	40	25	13	23
500164NNVP3	50x8 MA	50	25	13	23
500172NNVP3	50x10 MA	20	25	13	23
500173NNVP3	50x10 MA	25	25	13	23
500174NNVP3	50x10 MA	30	25	13	23
500176NNVP3	50x10 MA	40	25	13	23
500175NNVP3	50x10 MA	50	25	13	23
500181NNVP3	60x8 MA	20	31	14	26
500182NNVP3	60x8 MA	25	31	14	26
500183NNVP3	60x8 MA	30	31	14	26
500184NNVP3	60x8 MA	50	31	14	26
500191NNVP3	60x10 MA	20	31	14	26
500192NNVP3	60x10 MA	25	31	14	26
500193NNVP3	60x10 MA	30	31	14	26
500194NNVP3	60x10 MA	50	31	14	26
500202NNVP3	60x12 MA	25	31	14	26
500203NNVP3	60x12 MA	30	31	14	26
500204NNVP3	60x12 MA	50	31	14	26
500205NNVP3	60x12 MA	60	31	14	26
500212NNVP3	70x10 MA	25	35	18	26
500213NNVP3	70x10 MA	30	35	18	26
500214NNVP3	70x10 MA	50	35	18	26
500215NNVP3	70x10 MA	60	35	18	26
500222NNVP3	70x12 MA	25	35	18	26
500223NNVP3	70x12 MA	30	35	18	26
500224NNVP3	70x12 MA	50	35	18	26
500225NNVP3	70x12 MA	60	35	18	26

colore standard Nero
standard colour Black

a richiesta Cromato o Ottonato
Chrome or Brass plated on request

misure disponibili anche in termoindurente
thermosetting material available too

VOLANTINO IN PA CON BOCCOLA OTTONE
PA KNOBS WITH BRASS INSERT
art.501

Codice code	Ø Dxd	P	d1	H	h
501001NNVB3	20x4 MA	8	12	12	3
501003NNVB3	20x5 MA	8	12	12	3
501005NNVB3	20x6 MA	8	12	12	3
501007NNVB3	25x4 MA	8	14	13	5
501008NNVB3	25x5 MA	8	14	13	5
501009NNVB3	25x6 MA	8	14	13	5
501012NNVB3	30x6 MA	20	17	25	13
501013NNVB3	30x8 MA	20	17	25	13
501014NNVB3	40x6 MA	20	20	25	13
501015NNVB3	40x8 MA	20	20	25	13
501016NNVB3	40x10 MA	20	20	25	13
501017NNVB3	50x8 MA	20	23	25	13
501018NNVB3	50x10 MA	20	23	25	13
501019NNVB3	50x12 MA	20	23	25	13
501020NNVB3	60x8 MA	28	26	31	14
501021NNVB3	60x10 MA	28	26	31	14
501022NNVB3	60x12 MA	28	26	31	14
501023NNVB3	70x10 MA	28	26	35	18
501024NNVB3	70x12 MA	28	26	35	18

colore standard Nero
standard colour Black

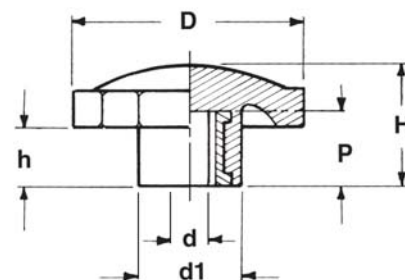
a richiesta Cromato o Ottonato
Chrome or Brass Plated on request

VOLANTINO IN PA CON BOCCOLA OTTONE PASSANTE
PA KNOB WITH BLIND BRASS ANOTHER THREADED INSERT
art.501

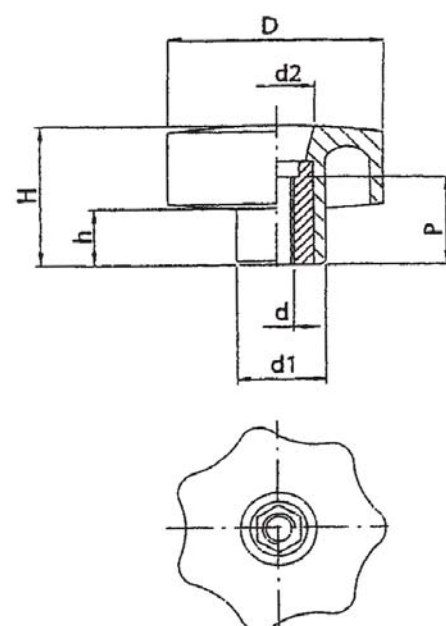
Codice code	Ø Dxd	P	d1	H	h	d2
501500LNVB3	30x4 MA	15	14	22	9	13
501501LNVB3	30x5 MA	15	14	22	9	13
501502LNVB3	30x6 MA	15	14	22	9	13
501503LNVB3	30x8 MA	15	14	22	9	13
501504LNVB3	40x6 MA	20	18	26	11	11
501505LNBV3	40x8 MA	20	18	26	11	11
501506LNVB3	40x10 MA	20	18	26	11	11
501507LNVB3	50x8 MA	20	20	32	15	20
501508LNVB3	50x10 MA	20	20	32	15	20
501509LNVB3	50x12 MA	20	20	32	15	20
501510LNVB3	60x8 MA	20	21	34	16	25
501511LNVB3	60x10 MA	20	21	34	16	25
501512LNVB3	60x12 MA	20	21	34	16	25
501513LNVB3	60x14 MA	20	21	34	16	25

colore standard Nero
standard colour Black



art.512

VOLANTINO TRIANGOLARE IN PA CON BOCCOLA OTTONE
THREE-CORNERED KNOB IN PA WITH BRASS INSERT

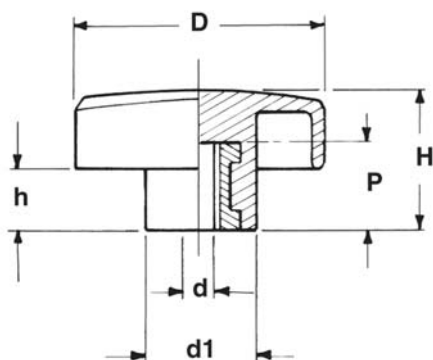

Codice code	Dxd	H	h	d1	P
512001NNVT3	52x8 MA	40	20	23	28
512002NNVT3	52x10 MA	40	20	23	28

colore standard Nero
standard colour Black

art.513

VOLANTINO TRIANGOLARE IN PA CON PERNO FERRO ZINCOCROMATO
THREE-CORNERED KNOB IN PA WITH ZINC PLATED STEEL STUD

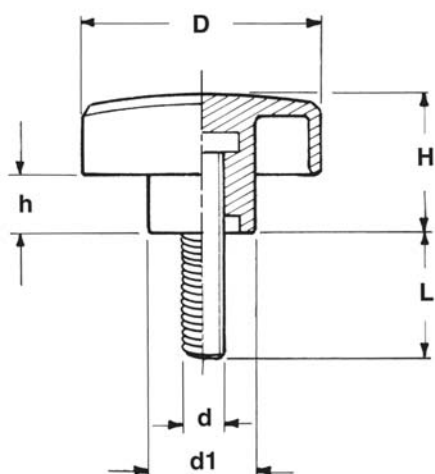

Codice code	Dxd	L	H	h	d1
513001NNVT3	52x8 MA	15	40	20	23
513002NNVT3	52x10 MA	40	40	20	23
513003NNVT3	52x8 MA	30	40	20	23

colore standard Nero
standard colour Black

art.514

VOLANTINO CON TAPPO IN PA CON BOCCOLA OTTONE
PA KNOB WITH PLUG AND BRASS INSERT

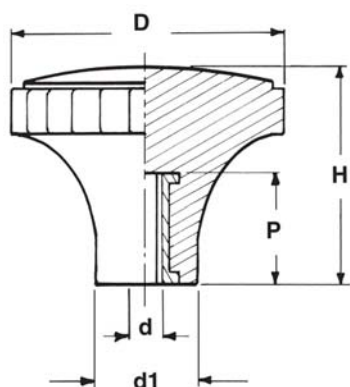

Codice code	Ø Dxd	P	H	D1
514001NNVCT3	45x8 MA	18	45	23
514002NNVCT3	45x10 MA	18	45	23

colore standard Nero
standard colour Black

VOLANTINO CON TAPPO IN PA E PERNO FERRO ZINCOCROMATO
PA KNOB WITH PLUG AND ZINC PLATED STEEL STUD

Codice code	Ø Dxd	L	H	D1
515001NNVCT3	45x8 MA	25	45	23
515002NNVCT3	45x10 MA	10	45	23
515003NNVCT3	45x10 MA	25	45	23

colore standard Nero
standard colour Black

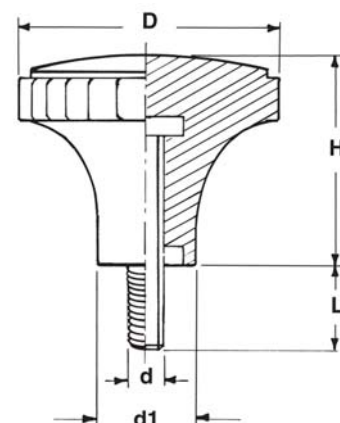
art.515

VOLANTINO MARGHERITA IN PA CON BOCCOLA OTTONE
PA KNOB WITH BRASS INSERT

Codice code	Ø Dxd	P	H	h	d1
516001NNVM3	60x8 MA	28	35	15	27
516002NNVM3	60x10 MA	28	35	15	27

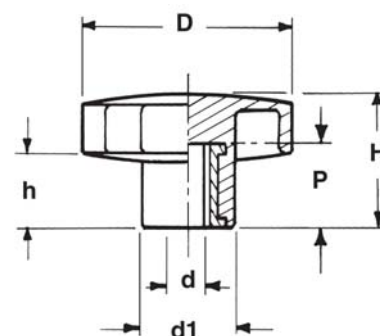
colore standard Nero
standard colour black

art.516

VOLANTINO A RAZZE CON MANIGLIA FISSA O SCATTO RIBALTABILE IN TERMOINDURENTE
FOUR-SPORE HANDWHEEL WITH FOLD AWAY OR FIXED HANDLE IN THE RHOSETTING MATERIAL
art.517

Codice code	Ø D	d1	H	h	h2	h3
517001LNVRM18	100	24	48	15	20	51
517002LNVRM18	120	25	49	16	15	82
517003LNVRM18	140	28	55	20	18	82
517004LNVRM18	160	32	57	22	21	82
517005LNVRM18	200	40	73	25	25	107
517006LNVRM18	250	50	85	29	32	107
517007LNVRM18	300	52	95	35	30	107

colore standard Nero
standard colour black

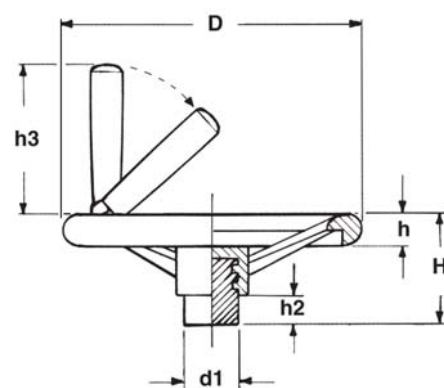
esecuzione di mozzo con foro o filetto a richiesta
on request, execution of hub with hole or thread





art.518

VOLANTINO A RAZZE IN TERMOINDURENTE
FOUR-SPOKE HANDWHEEL IN THERMOSETTING MATERIAL

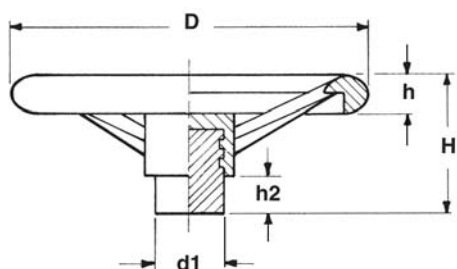

Codice code	Ø D	d1	H	h	h2
518001LNVR518	100	24	48	15	20
518002LNVR518	120	25	49	16	15
518003LNVR518	140	28	55	20	18
518004LNVR518	160	32	57	22	21
518005LNVR518	200	40	73	25	25
518006LNVR518	250	50	85	29	32
518007LNVR518	300	52	95	32	32

colore standard Nero
standard colour Black

esecuzione di mozzo con foro o filetto a richiesta
on request, execution of hub with hole or thread

art.536

VOLANTINO A FASCIA IN PAFV CON MANIGLIA FISSA O SCATTO RIBALTABILE E MOZZO FERRO ZINCATO
BAR-PATTERN HANDWHEEL IN PAFV WITH FIXED OR FOLD AWAY HANDLE AND ZINC PLATED STEEL HUB

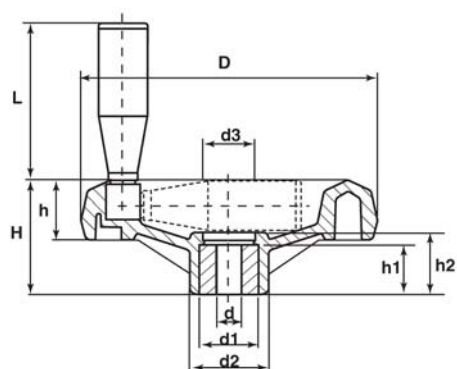

Codice code	Ø D	d	d1	d2	d3	H	h	h1	h2	L
536001LNVFM4	126	10	22	32	21	46	24	20	25	82
536002LNVFM4	126	12	22	32	21	46	24	20	25	82
536003LNVFM4	126	14	22	32	21	46	24	20	25	82
536004LNVFM4	160	10	25	34	29	47	25	26	31	82
536005LNVFM4	160	12	25	34	29	47	25	26	31	82
536006LNVFM4	160	14	25	34	29	47	25	26	31	82
536007LNVFM4	160	16	25	34	29	47	25	26	31	82
536008LNVFM4	200	10	30	50	28	60	28	32	34	107
536009LNVFM4	200	16	30	50	28	60	28	32	34	107
536010LNVFM4	200	20	30	50	28	60	28	32	34	107

colore standard Nero
standard colour black

VOLANTINO A FASCIA IN PAFV CON MOZZO FERRO ZINCATO
BAR-PATTERN HAND WHEEL IN PAFV WITH ZINC PLATED STEEL HUB
art.535

Codice code	Ø D	d	d1	d2	d3	H	h	h1	h2
535001LNVFM4	126	10	22	32	21	46	24	20	25
535002LNVFM4	126	12	22	32	21	46	24	20	25
535003LNVFM4	126	14	22	32	21	46	24	20	25
535004LNVFM4	160	10	25	34	29	47	25	26	31
535005LNVFM4	160	12	26	34	29	47	25	25	31
535006LNVFM4	160	14	25	34	29	47	25	26	31
535007LNVFM4	160	16	25	34	29	47	25	26	31
535008LNVFM4	200	10	30	50	28	60	28	32	34
535009LNVFM4	200	16	30	50	28	60	28	32	34
535010LNVFM4	200	20	30	50	28	60	28	32	34

colore standard Nero
standard colour Black

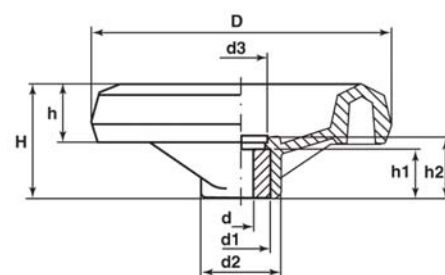
VOLANTINO IN TERMOINDURENTE A 3 PUNTE CON MOZZO FERRO ZINCOCROMATO
THREE-ARM KNOB IN THERMOSETTING MATERIAL WITH ZINC PLATED STEEL HUB
art.550

Codice code	D	d1	d2	H	h	h1
550015LNVTP18	60	12	19	24	21	10
550016LNVTP18	70	14	22	26	23	10
550017LNVTP18	80	24	30	42	38	10
550018LNVTP18	90	24	33	38	32	15
550019LNVTP18	100	25	34	37	33	15
550020LNVTP18	120	28	38	48	42	15
550021LNVTP18	140	32	44	53	44	15

colore standard Nero
standard colour Black

a richiesta si possono produrre con perno o boccola ottone
available with hinge or brass insert

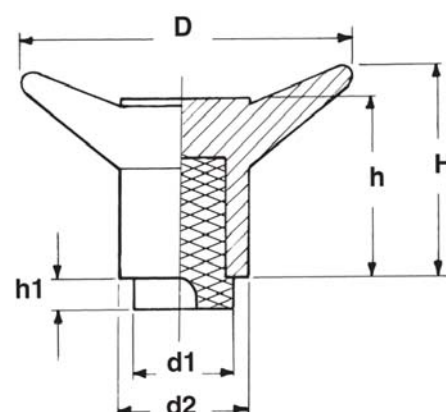

MANOPOLINA PER CASSETTI IN ABS CON BOCCOLA OTTONE
ABS KNOB WITH BRASS INSERT
art.522

Codice code	Ø Dxd	H	d1	P
522001NNPC3	30x5 MA	23	12	15
522002NNPC3	30x6 MA	23	12	15

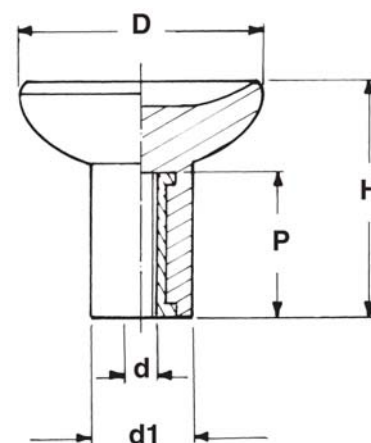
colore standard Nero
standard colour Black

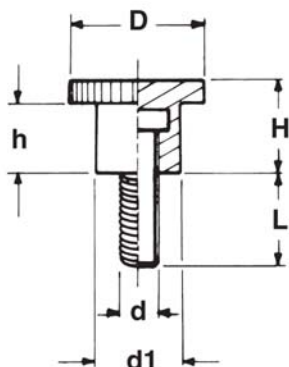

art.509



MANOPOLINA ZIGRINATA IN PA CON PERNO FERRO ZINCOCROMATO
 KNURLED KNOB IN PA WITH ZINC PLATED STEEL STUD

Codice code	Ø Dxd	L	H	h	d1
509001NNMZP3	14x4 MA	10	10	6	9
509002NNMZP3	14x4 MA	12	10	6	9
509003NNMZP3	14x5 MA	10	10	6	9
509004NNMZP3	14x5 MA	12	10	6	9

colore standard Nero
 standard colour Black

art.509

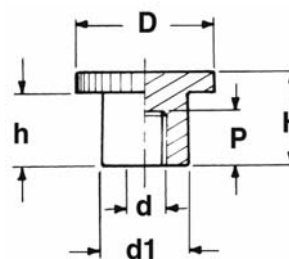

MANOPOLINA ZIGRINATA IN PA FILETTATA FEMMINA
 KNURLED KNOB IN PA FEMALE THREAD

Codice code	Ø Dxd	P	H	h	d1
509005NNMZB3	14x4 MA	6	10	6	9
509006NNMZB3	14x4 MA	6	10	6	9

colore standard Nero
 standard colour Black

art.506

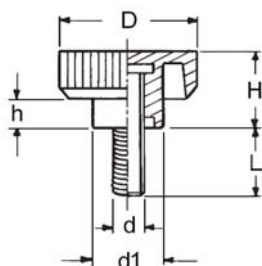

MANOPOLINA ZIGRINATA IN PA CON PERNO FERRO ZINCOCROMATO
 KNURLED KNOB IN PA WITH ZINC PLATED STEEL STUD

Codice code	Ø Dxd	L	H	h	d1
506001NNMZ3	20x4 MA	10	12,5	5	13,5
506002NNMZ3	20x4 MA	12	12,5	5	13,5
506003NNMZ3	20x5 MA	10	12,5	5	13,5
506004NNMZ3	20x5 MA	16	12,5	5	13,5

colore standard Nero
 standard colour Black

art.507

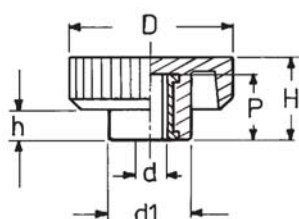

MANOPOLINA ZIGRINATA IN PA CON BOCCOLA OTTONE
 KNURLED KNOB IN PA WITH BRASS INSERT

Codice code	Ø Dxd	L	H	h	d1
507001NNMZ3	20x4 MA	8	12,5	5	13,5
507003NNMZ3	20x5 MA	8	12,5	5	13,5

colore standard Nero
 standard colour Black

MANOPOLINA ZIGRINATA IN PA FILETTATA
KNURLED KNOB IN PA

art.915

Codice code	Ø Dxd	P	H	h	d1
915001NNMZB3	26x8 MA	14	18	14	16

colore standard Nero
standard colour Black

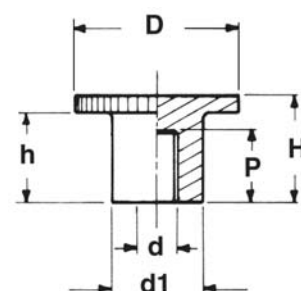

MANIGLIA A RIPRESA IN PAFV CON PULSANTE E BOCCOLA OTTONE FILETTATA
PAFV ADJUSTABLE HANDLE WITH BUTTON AND BRASS INSERT

art.519

Codice code	R	d	L	D	H	h	h2	h1	d1	P
519050LNMRPB4	40	4 MA	50	17	42	33	7	15	12	8
519051LNMRPB4	40	5 MA	50	17	42	33	7	15	12	10
519052LNMRPB4	40	6 MA	50	17	42	33	7	15	12	12
519053LNMRPB4	60	6 MA	70	22	42	37	8	14	15	12
519054LNMRPB4	60	8 MA	70	22	42	37	8	14	15	16
519055LNMRPB4	80	8 MA	95	27	59	49	9	20	19	16
519056LNMRPB4	80	10 MA	95	27	59	49	9	20	19	22
519057LNMRPB4	80	12 MA	95	27	59	49	9	20	19	22
519058LNMRPB4	100	12 MA	117	38	85	60	12	20	25	22
519059LNMRPB4	100	14 MA	117	38	85	60	12	20	25	22
519060LNMRPB4	100	16 MA	117	38	85	60	12	20	25	22

colore standard Nero
standard colour Black

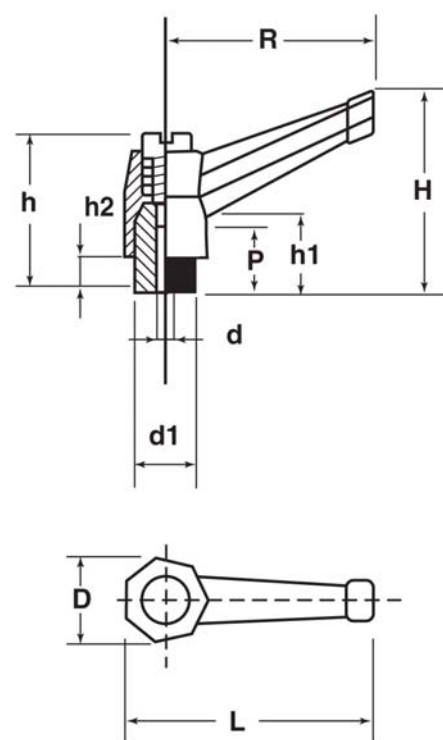

art.519

MANIGLIA A RIPRESA IN PAFV CON PULSANTE E PERNO FERRO
PAFV ADJUSTABLE HANDLE WITH BUTTON AND STEEL STUD

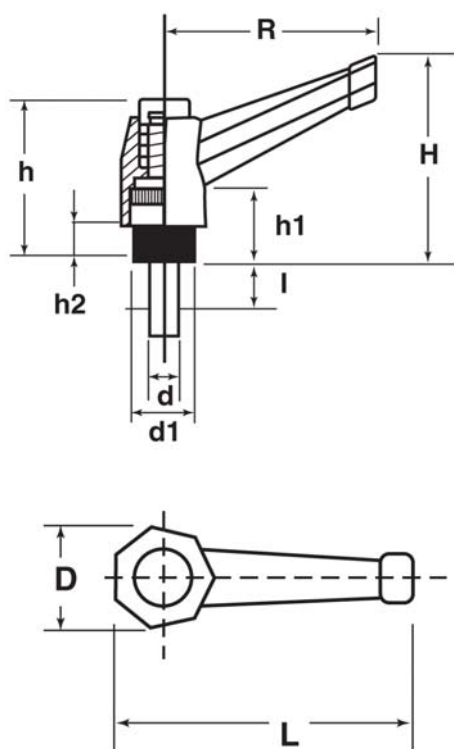

Codice code	R	d	L	D	H	h	h2	h1	d1	l
519100LNMRRPP4	40	5 MA	50	17	42	33	7	15	12	10
519101LNMRRPP4	40	5 MA	50	17	42	33	7	15	12	20
519102LNMRRPP4	40	5 MA	50	17	42	33	7	15	12	30
519103LNMRRPP4	40	6 MA	50	17	42	33	7	15	12	15
519104LNMRRPP4	40	6 MA	50	17	42	33	7	15	12	20
519105LNMRRPP4	40	6 MA	50	17	42	33	7	15	12	25
519106LNMRRPP4	40	6 MA	50	17	42	33	7	15	12	30
519107LNMRRPP4	40	8 MA	50	17	42	33	7	15	12	15
519108LNMRRPP4	40	8 MA	50	17	42	33	7	15	12	30
519109LNMRRPP4	60	6 MA	70	22	42	37	8	14	15	15
519110LNMRRPP4	60	6 MA	70	22	42	37	8	14	15	20
519111LNMRRPP4	60	6 MA	70	22	42	37	8	14	15	25
519112LNMRRPP4	60	6 MA	70	22	42	37	8	14	15	30
519113LNMRRPP4	60	6 MA	70	22	42	37	8	14	15	40
519114LNMRRPP4	60	6 MA	70	22	42	37	8	14	15	50
519115LNMRRPP4	60	8 MA	70	22	42	37	8	14	15	15
519116LNMRRPP4	60	8 MA	70	22	42	37	8	14	15	20
519117LNMRRPP4	60	8 MA	70	22	42	37	8	14	15	30
519118LNMRRPP4	60	8 MA	70	22	42	37	8	14	15	40
519119LNMRRPP4	60	8 MA	70	22	42	37	8	14	15	50
519120LNMRRPP4	60	8 MA	70	22	42	37	8	14	15	60
519121LNMRRPP4	60	10 MA	70	22	42	37	8	14	15	20
519123LNMRRPP4	60	10 MA	70	22	42	37	8	14	15	30
519124LNMRRPP4	60	10 MA	70	22	42	37	8	14	15	40
519125LNMRRPP4	60	10 MA	70	22	42	37	8	14	15	50
519126LNMRRPP4	80	10 MA	95	27	59	49	9	20	19	20
519127LNMRRPP4	80	10 MA	95	27	59	49	9	20	19	30
519128LNMRRPP4	80	10 MA	95	27	59	49	9	20	19	40
519129LNMRRPP4	80	10 MA	95	27	59	49	9	20	19	50
519130LNMRRPP4	80	12 MA	95	27	59	49	9	20	19	20
519131LNMRRPP4	80	12 MA	95	27	59	49	9	20	19	30
519132LNMRRPP4	80	12 MA	95	27	59	49	9	20	19	40
519133LNMRRPP4	80	12 MA	95	27	59	49	9	20	19	50
519134LNMRRPP4	100	12 MA	117	38	85	60	12	20	25	30
519135LNMRRPP4	100	12 MA	117	38	85	60	12	20	25	40
519136LNMRRPP4	100	12 MA	117	38	85	60	12	20	25	50
519137LNMRRPP4	100	14 MA	117	38	85	60	12	20	25	30
519138LNMRRPP4	100	14 MA	117	38	85	60	12	20	25	40
519139LNMRRPP4	100	14 MA	117	38	85	60	12	20	25	50
519140LNMRRPP4	100	16 MA	117	38	85	60	12	20	25	30
519141LNMRRPP4	100	16 MA	117	38	85	60	12	20	25	40
519142LNMRRPP4	100	16 MA	117	38	85	60	12	20	25	50

colore standard Nero
standard colour Black

IMPUGNATURA A GALLETO IN PA CON BOCCOLA OTTONE CIECA
PA WINGNUT WITH BLIND BRASS INSERT

art.510

Codice code	Dxd	d1	d2	H	P
510100LNGB3	30x4 MA	14	12	16	8
510101LNGB3	30x5 MA	14	12	16	10
510102LNGB3	30x6 MA	14	12	16	12
510103LNGB3	30x8 MA	14	12	16	11
510104LNGB3	50x5 MA	18	16	22	10
510105LNGB3	50x6 MA	18	16	22	12
510106LNGB3	50x8 MA	18	16	22	11
510107LNGB3	50x10 MA	18	16	22	16

disponibili con boccia ottone passante e con perno in ferro zincato
 available with brass through insert and zinc plated steel stud

colore standard Nero
 standard colour Black

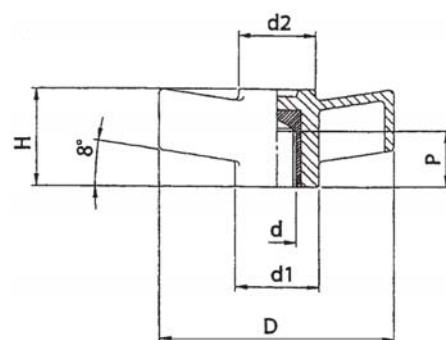

IMPUGNATURA A GALLETO IN PA CON PERNO FERRO ZINCOCROMATO
PAWING NUT WITH ZINC PLATED STEEL STUD

art.510

Codice code	Dxd	L	H	h	d1
510001NNGP3	28x4 MA	10	13	5	12
510005NNGP3	28x5 MA	10	13	5	12
510007NNGP3	28x5 MA	15	13	5	12
510009NNGP3	28x6 MA	10	13	5	12
510011NNGP3	28x6 MA	12	13	5	12
510016NNGP3	28x6 MA	15	13	5	12

colore standard Nero
 standard colour Black

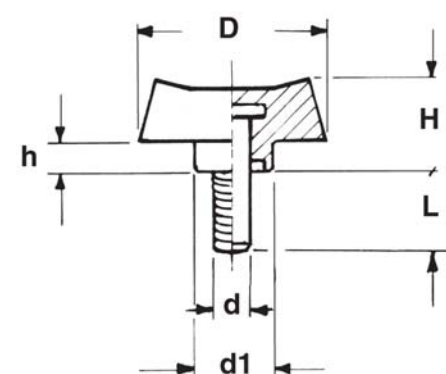

IMPUGNATURA A GALLETO IN PA CON BOCCOLA OTTONE
PA WING NUT WITH BRASS INSERT

art.510

Codice code	Dxd	L	H	h	d1
510013NNGMB3	40x4 MA	14	20	11	12
510014NNGMB3	40x5 MA	14	20	11	12
510015NNGMB3	40x6 MA	14	20	11	12

colore standard Nero
 standard colour Black

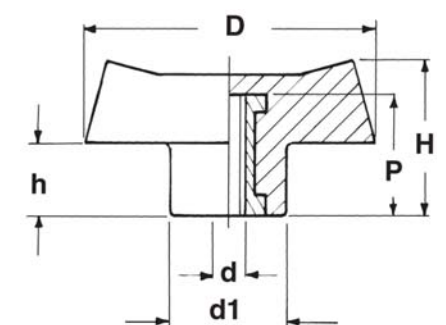

art.511

IMPUGNATURA A GALLETTO IN PA CON BOCCOLA OTTONE
PA WING NUT WITH BRASS INSERT

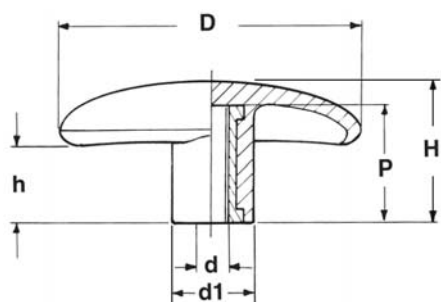

Codice code	Dxd	L	H	h	d1
511008NNGGB3	84x8 MA	28	40	20	24
511009NNGGB3	84x10 MA	28	40	20	24
511010NNGGB3	84x12 MA	28	40	20	24

colore standard Nero
standard colour Black

art.511

IMPUGNATURA A GALLETTO IN PA CON PERNO FERRO ZINCOCROMATO
PA WING NUT WITH ZINC PLATED STEEL STUD

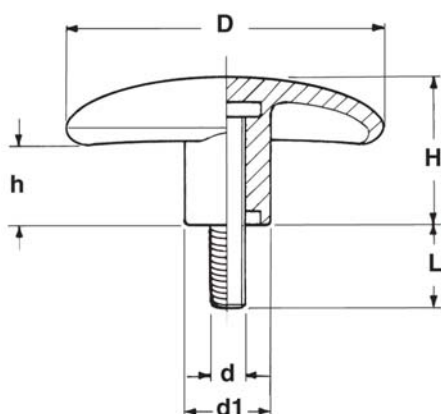

Codice code	Dxd	L	H	h	d1
511001NNGGP3	84x8 MA	30	40	20	24
511004NNGGP3	84x10 MA	10	40	20	24
511002NNGGP3	84x10 MA	30	40	20	24
511005NNGGP3	84x10 MA	40	40	20	24
511006NNGGP3	84x10 MA	45	40	20	24
511007NNGGP3	84x12 MA	30	40	20	24

colore standard Nero
standard colour Black

SFERA CON FORO FILETTATO IN ABS
ABS BALL KNOB WITH THREADED HOLE
art.504

Codice code	Ø AxB
504001MNSVF7	20x4 MA
504015MNSVF7	20x5 MA
504016MNSVF7	20x6 MA
504017MNSVF7	20x8 MA
504018MNSVF7	20x10 MA
504002MNSVF7	30x4 MA
504012MNSVF7	30x5 MA
504013MNSVF7	30x6 MA
504003MNSVF7	30x8 MA
504019MNSVF7	30x10 MA
504004MNSVF7	35x4 MA
504040MNSVF7	35x5 MA
504041MNSVF7	35x6 MA
504005MNSVF7	35x8 MA
504014MNSVF7	35x10 MA
504020MNSVF7	45x5 MA
504006MNSVF7	45x8 MA
504007MNSVF7	45x10 MA
504021MNSVF7	55x5 MA
504008MNSVF7	55x8 MA
504009MNSVF7	55x10 MA
504010MNSVF7	65x8 MA
504011MNSVF7	65x10 MA

colore standard Nero a richiesta anche Cromata
 standard colour Black Chrome plated on request

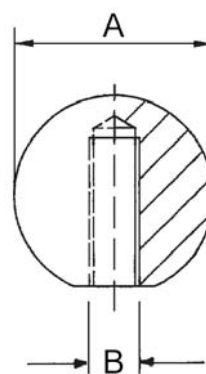
SFERA CON BOCCOLA OTTONE FILETTATA IN PA
PA BALL KNOB WITH BRASS TRHU-INSERT
art.505

Codice code	Ø AxB
505001NNSF3	20x5 MA
505002NNSF3	20x6 MA

colore standard Nero
 standard colour Black

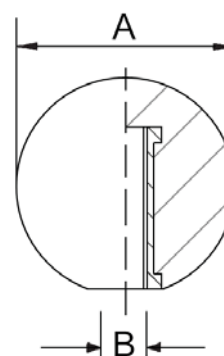



art.505

SFERA CON FORO FILETTATO IN TERMOINDURENTE
BALL KNOB IN THERMO SETTING MATERIAL WITH THREADED HOLE

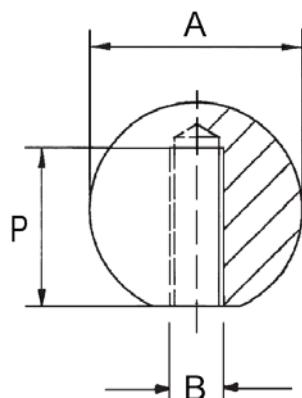

Codice code	Ø Ax B	P
505003LNSF18	20x5 MA	15
505004LNSF18	20x6 MA	15
505024LNSF18	25x5 MA	15
505005LNSF18	25x6 MA	18
505006LNSF18	25x8 MA	20
505007LNSF18	30x5 MA	15
505008LNSF18	30x6 MA	18
505009LNSF18	30x8 MA	20
505010LNSF18	30x10 MA	20
505011LNSF18	35x6 MA	18
505012LNSF18	35x8 MA	24
505013LNSF18	35x10 MA	30
505014LNSF18	35x12 MA	30
505025LNSF18	40x6 MA	18
505015LNSF18	40x8 MA	24
505016LNSF18	40x10 MA	30
505017LNSF18	40x12 MA	30
505018LNSF18	45x10 MA	30
505019LNSF18	45x12 MA	30
505020LNSF18	45x14 MA	30
505026LNSF18	45x16 MA	30
505027LNSF18	50x10 MA	38
505028LNSF18	50x12 MA	38
505021LNSF18	50x14 MA	38
505022LNSF18	50x16 MA	38

colore standard Nero
standard colour Black

SFERA CON FORO LISCIO IN ABS
ABS BALL KNOBS WITH SMOOTH HOLE

art.504

Codice code	Ø AxB
504022MNSVSF7	20x3
504023MNSVSF7	20x4
504033MNSVSF7	20x8
504034MNSVSF7	20x10
504024MNSVSF7	30x4
504035MNSVSF7	30x10
504036MNSVSF7	35x3
504025MNSVSF7	35x4
504026MNSVSF7	35x8
504037MNSVSF7	35x10
504038MNSVSF7	45x10
504027MNSVSF7	45x12
504028MNSVSF7	45x14
504039MNSVSF7	55x10
504029MNSVSF7	55x14
504030MNSVSF7	55x18
504042MNSVSF7	65x10
504031MNSVSF7	65x14
504032NNSVSF7	65x25

colore standard Nero a richiesta anche Cromata
 standard colour Black Chrome plated on request

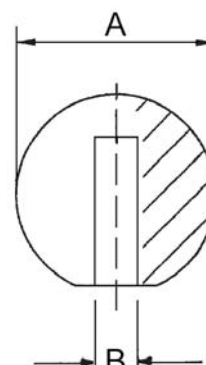

SFERA CON FORO LISCIO IN PS
PS BALL KNOB WITH SMOOTH HOLE

art.505/1

Codice code	Ø AxB
505104NNSL13	20x1,5
505105NNSL13	20x5,5
505108NNSL1	40x16

colore standard Nero
 standard colour Black

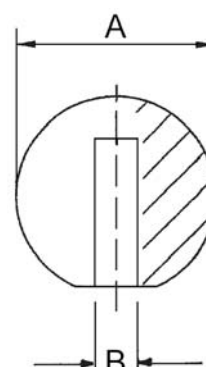



art.525

MANIGLIA IN ABS ABS HANDLE

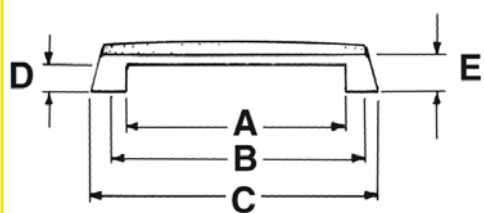

Codice code	A	B	C	D	E	Filetto thread
525001MNMD7	60	73	90	15	26	4 MA
525002MNMD7	86	100	120	15	26	4 MA
525003MNMD7	116	130	152	15	26	4 MA
525004MNMD7	128	140	150	9,5	22	4 MA

colore standard Nero
standard colour Black

a richiesta anche Cromata
Chrome plated on request

art.526

MANIGLIA IN ABS ABS HANDLE

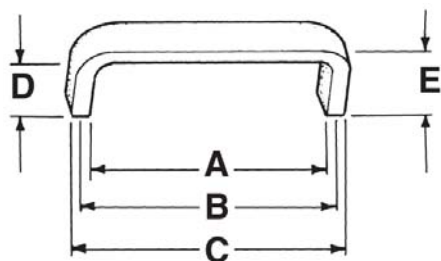

Codice code	A	B	C	D	E	Filetto thread
526001MNMD7	80	90	100	22	30	4 MA
526004MNMD7	97	108	118	26	33	4 MA
526002NNMD7	78	90	110	27	35	6 MA
526003NNMD7	78	90	110	27	35	* per autofil. thread forming

colore standard Nero
standard colour Black

a richiesta anche Cromata
Chrome plated on request

*vite consigliata TC Ø 3,9
*for screw TC Ø 3,9

art.526

MANIGLIA IN ABS ABS HANDLE

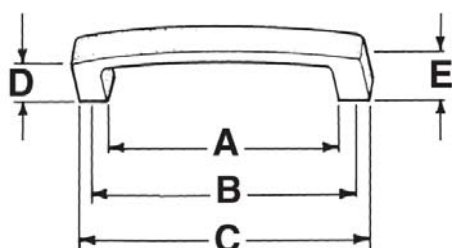

Codice code	A	B	C	D	E	Filetto thread
526005MNMD7	100	116	130	17	27	4 MA

colore standard Nero
standard colour Black

a richiesta anche Cromata
Chrome plated on request

art.526

MANIGLIA CURVA IN PP PP CURVED HANDLE

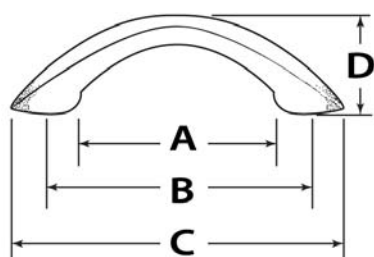

Codice code	A	B	C	D
526050INMC9	52	64	87	23
526051INMC9	88	96	123	28

colori a richiesta
colours on request

MANIGLIA A PONTE IN PA CON FORO PASSANTE PER VITE BRUGOLA
U-HANDLE IN PA WITH TROU HOLE
art.130

Codice code	Int.	L	I1	h	h1	d	d1	H	B	I
130003MPFPLN3	93,5	107	74	7	14	6,5	11	37	7,5	21
130001MPFPNN3	117	136	92	7	15	6,5	11	42	8,5	25
130002MPFPNN3	117	136	92	9	15	8,5	14	42	8,5	25
130004MPFPLN3	132	151	104	9	18	8,5	14	46	8	27
130005MPFPLN3	179	197	153	9	17	8,5	14	51	9	28

colore standard Nero
standard colour Black

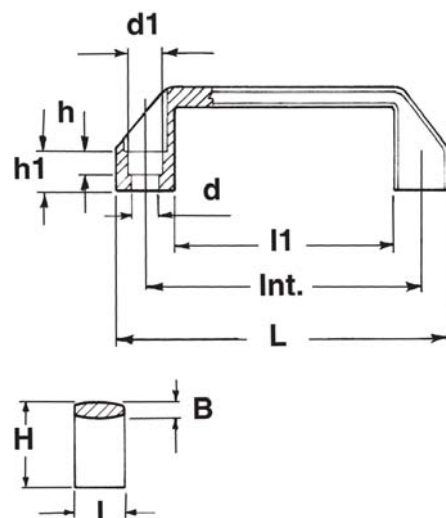
MANIGLIA A PONTE IN PA CON BOCCOLA OTTONE FILETTATA
U-HANDLE IN PA WITH THREADED BRASS INSERT
art.140

Codice code	Int.	L	I1	h1	d	P	H	B	I
140004MPBLN3	93,5	107	74	14	5 MA	10	37	7,5	21
140005MPBLN3	93,5	107	74	14	6 MA	12	37	7,5	21
140001MPBLN3	117	136	92	15	5 MA	10	42	8,5	25
140002MPBLN3	117	136	92	15	6 MA	12	42	8,5	25
140003MPBLN3	117	136	92	15	8 MA	12	42	8,5	25
140006MPBLN3	132	151	104	18	8 MA	12	46	8,9	27
140007MPBLN3	179	197	153	17	8 MA	12	51	8,9	28

colore standard Nero
standard colour Black

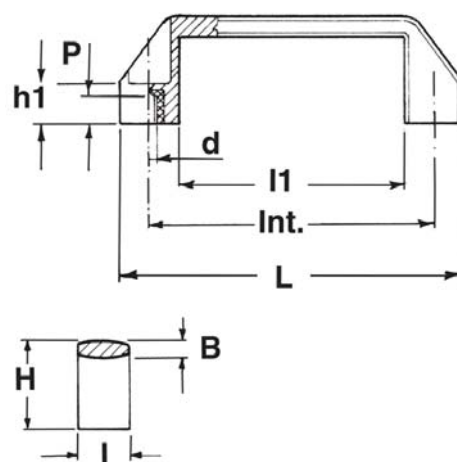
MANIGLIA A PONTE IN PA CON PERNO IN FE ZINCOCROMATO
U-HANDLE IN PA WITH ZINC PLATED STEEL STUD
art.150

Codice code	Int.	L	I1	H1	D	I2	H	B	I
150003MPPLN3	93,5	107	74	14	5 MA	10	37	7,5	21
150004MPPLN3	93,5	107	74	14	6 MA	12	37	7,5	21
150002MPPLN3	117	136	92	15	5 MA	10	42	8,5	25
150001MPPLN3	117	136	92	15	6 MA	12	42	8,5	25
150005MPPLN3	132	151	104	18	8 MA	15	46	8	27
150006MPPLN3	179	197	153	17	8 MA	15	51	9	28

colore standard Nero
standard colour Black

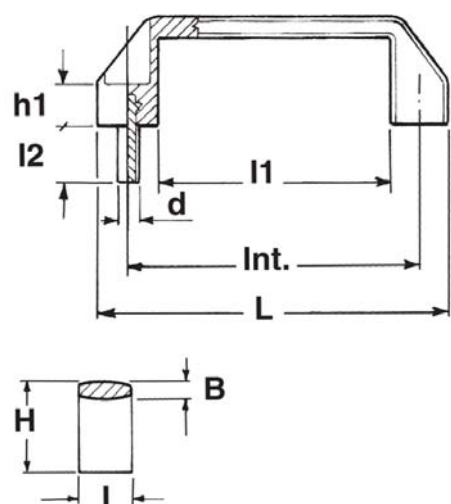

art.120

MANIGLIA A PONTE IN PA
U-HANDLE IN PA

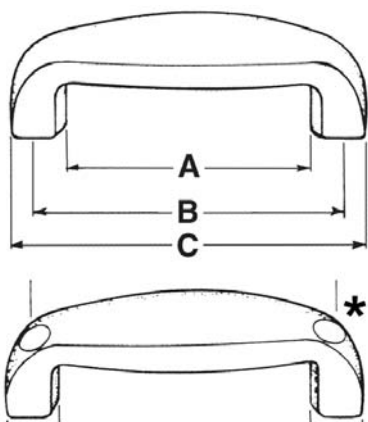

Codice code	A	B	C	Inserto insert
120001MPNN3	84x28	104	124	per vite autofilettante for thread forming screw
120002MPINN3	84x28	104	124	per brugola 6MA for threaded allen 6MA
120004MPBNN3	84x28	104	124	con boccola 6MA with threaded bushing 6MA

colore standard Nero
standard colour Black

a richiesta vite autofilettante 4,8x22
on request thread forming screw 4,8x22

per vite a brugola*
for allen screw *

art.523

MANIGLIONE IN TERMOINDURENTE CON BOCCOLA OTTONE
U-HANDLE IN THERMOSETTING MATERIAL WITH BRASS INSERT

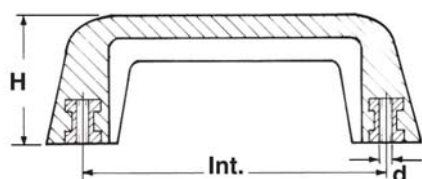

Codice code	Int.	H	d
523001LNM18	110	45	6 MA*
523002LNM18	118	35	6 MA
523003LNM18	132	55	8 MA**
523004LNM18	149	60	8 MA

disponibile con filetto ricavato nella bachelite
available with bakelite thread

colore standard Nero
standard colour Black

* disponibile con filetto 5-8 MA available with thread 5-8 MA

** disponibile con filetto 10 MA available with thread 10 MA

art.532

MANIGLIA TRAPEZIOIDALE BASSA IN TERMOINDURENTE
LOW TRAPEZOIDAL HANDLE IN THERMOSETTING MATERIAL

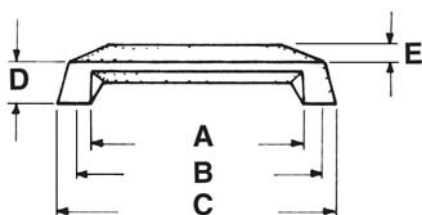

Codice code	A	B	C	D	E
532002INMT18	107	120	140	21	25

colore standard Nero
standard colour Black

MANIGLIA INCASSO IN PS
PS RECESSED HANDLE

Codice code	A	B	C	D
527001INMIR13	80x27	100	36	13
527002NNMIR9	106x38	118	45	20
527003NNMIR7	125x36	150	45	15

colore standard Nero
standard colour Black

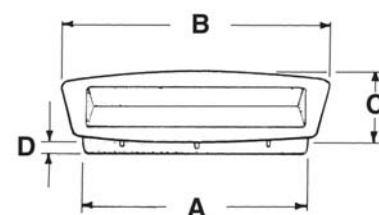
art.527
MANIGLIA INCASSO IN ABS
ABS RECESSED HANDLE

Codice code	A	B	C	D
528001MNMIR7	69x26	10	32	75
528002MNMIR7	93x32	11	40	102

colore standard Nero a richiesta anche Cromata
standard colour Black Chrome plated on request

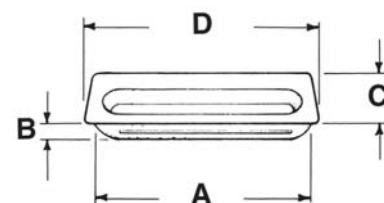

art.528
MANIGLIA SCATTO DA INCASSO IN PS
TRIP HANDLE IN PS

Codice code	A	B	C	D
528003INMIR7	120x17	126	25	13
528004NNMIR13	142x22	148	30	13
528005NNMIR13	300x23	306	30	13

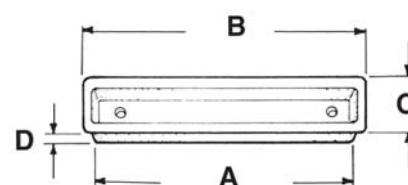
colore standard Nero
standard colour Black

art.528

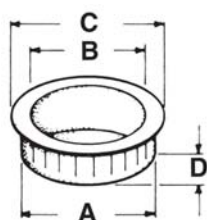
art.529



MANIGLIA ROTONDA INTERNO LISCIO DA INCASSO IN PS
ROUND HANDLE SMOOTH INSIDE IN PS

Codice code	A	B	C	D
529001INMIR13	22	20	28	10
529002INMIR13	30	27	36	12
529003INMIR13	40	36	50	14

colore standard Nero
standard colour Black

art.530

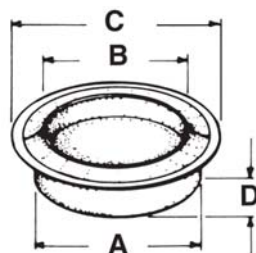

MANIGLIA ROTONDA CON BORDO SPORGENTE DA INCASSO IN ABS
ROUND HANDLE WITH PROTRUDED EDGE IN ABS

Codice code	A	B	C	D
530002MNMBS7	40	29	48	14
530003MNMBS7	52	40	62	14

colore standard nero
standard colour black

a richiesta con bordo Cromato
Chromated border on request

art.503

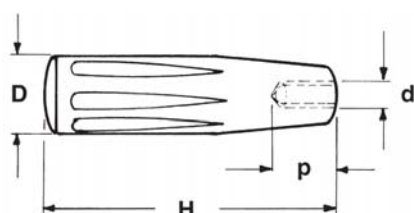

MANIGLIA IN PA CON FORO FILETTATO
PA HANDLE WITH THREADED HOLE

Codice code	D	d	P	H
503001NNMG3	24	8 MA	20	80
503002NNMG3	24	10 MA	20	80

colore standard Nero
standard colour Black

MANIGLIA IN PA CON PERNO GIREVOLE

PA REVOLVING HANDLE WITH KEY

Codice code	D	d	H	CH	L
502005LNM43	18	M 6	51	10	12
502006LNM43	20	M 8	71	13	15
502003LNM43	24	M 10	81	13	15
502004LNM43	28	M 12	98	14	15

colore standard Nero
standard colour Black

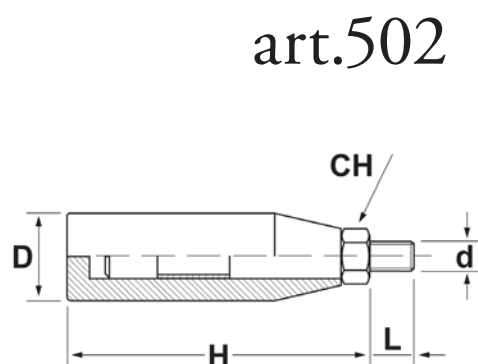
MANIGLIA OGIVALE IN TERMOINDURENTE CON FORO FILETTATO

HANDLE IN THERMOSETTING MATERIAL WITH THREADED HOLE

Codice code	D	d	d1	H	P
524002LNMO18	26	6 MA	17	64	35
524003LNMO18	26	8 MA	17	64	35
524004LNMO18	26	10 MA	17	64	35
524011LNMO18	28	8 MA	18	76	48
524012LNMO18	28	10 MA	18	76	48
524005LNMO18	33	8 MA	21	84	45
524006LNMO18	33	10 MA	21	84	45
524007LNMO18	33	12 MA	21	84	45
524013LNMO18	37	8 MA	22	97	65
524008LNMO18	37	10 MA	22	97	65
524009LNMO18	37	12 MA	22	97	65
524010LNMO18	37	14 MA	22	97	65

colore standard Nero
standard colour Black

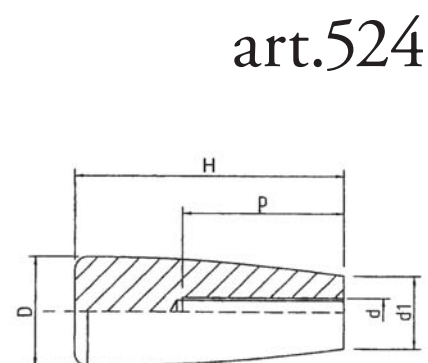



art.920

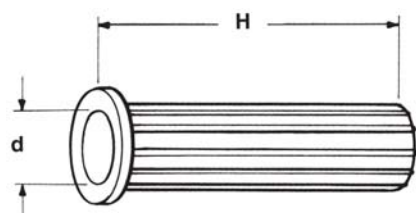

MANOPOLA IN PVC
PVC HANDLE

Codice code	d	H
920001NNM1	20	110
920002NNM1	22	110

colore standard Nero
standard colour Black

art.921

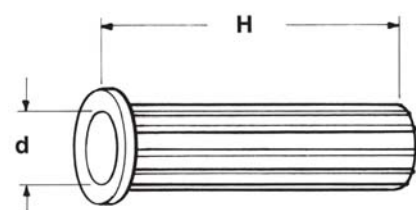

MANOPOLA IN PVC
PVC HANDLE

Codice code	d	H
921001NNM1	25	110
921002NNM1	27	110
921003NNM1	30	110

colore standard Nero
standard colour Black

art.922

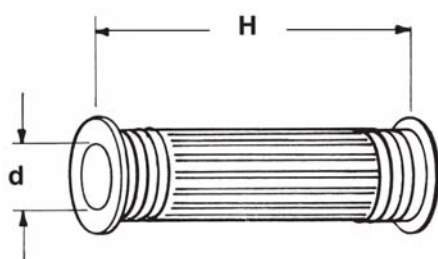

MANOPOLA RIGATA IN PVC
PVC HANDLE

Codice code	d	H	Foro hole
922002NNMR1	16	100	cieco blind
922003NNMR1	16	100	passante thru
922004NNMR1	18	100	cieco blind
922005NNMR1	18	100	passante thru

colore standard Nero
standard colour Black

art.923

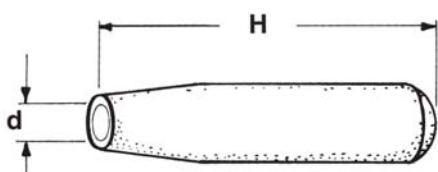

MANOPOLA IN PVC
PVC HANDLE

Codice code	d	H
923001NNMS1	8	85
923002NNMS1	10	85
923003NNMS1	12	85

colore standard Nero
standard colour Black

MANOPOLA IN PA ASTA MANOVRA FORO PASSANTE
PA HANDLE THRU HOLE
art.929

Codice code	d	H
929001NNMAM3	15,1	100

colore standard Nero
standard colour Black

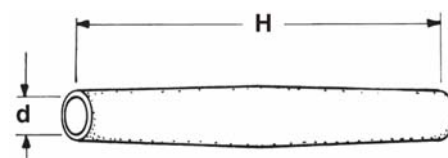
MANOPOLA RIGATA IN PVC FORO PASSANTE
PVC HANDLE THRU HOLE
art.930

Codice code	d	H
930001NNMFP1	20	147

colore standard Nero
standard colour Black

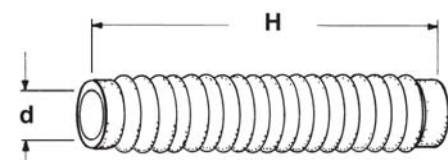
MANOPOLA IN PE
PE HANDLE
art.931

Codice code	d	H
931010INMC2	28	92
931011INMC2	30	92
931012INMC2	32	92

colore standard Nero
standard colour Black

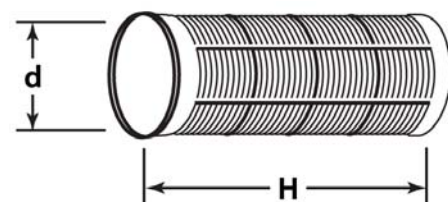



Per tutti i puntali e copritesta interni alettati il Ø della testa si riferisce al Ø esterno del tubo, mentre per i non alettati il Ø del gambo si riferisce al Ø interno del tubo.

*The Ø of the head for all ribbed inserts and cover caps is referred to the outside Ø of the tube.
The Ø of the head for all non-ribbed inserts and cover caps is referred to the inside Ø of the tube.*

art.600

PUNTALE ALETTATO ROTONDO IN PE ROUND RIBBED INSERT IN PE

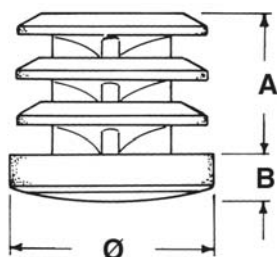

Codice code	Ø Testa Ø head	A	B
600001INPTA2	10	13	5
600002INPTA2	12	14	5
600003INPTA2	14	14	5
600004INPTA2	16	16	5
600005MPPTA2	18	13	5
600006MPPTA2	20	13	5
600007MPPTA2	22	13	5
600008INPTA2	24	20	5
600009MPPTA2	25	19	5
600010INPTA2	26	20	5
600011MPPTA2	28	19	5
600012MPPTA2	30	19	5
600013INPTA2	32	19	5
600014MPPTA2	35	20	5
600015INPTA2	38	22	5
600016MPPTA2	40	22	5
600021BPTA2	42	11,5	5
600017INPTA2	45	30	5
600018INPTA2	50	22	5
600019CPTA2	60	24	5
600020INPTA2	80	33	5
600023INPTA2	120	37	5
600024INPTA2	48	22	7
600022INPTA2	70	33	6

colore standard Nero
standard colour Black

a richiesta anche colore Bianco
White colour on request

PUNTALE ALETTATO ROTONDO IN PP FILETTATO M10
ROUND RIBBED INSERT IN PP THREAD M10
art.608

Codice code	Ø Testa Ø head	A	B
608002INPTF2	18	18	6
608004INPTF2	20	18	6
608006INPTF2	22	19	6
608008INPTF2	25	19	6
608010INPTF2	28	19	6
608023INPTF2	28x2	19	6
608012INPTF2	30	19	6
608014INPTF2	32	19	6
608016INPTF2	35	20	6
608018INPTF2	40	20	6
608020INPTF2	45	21	6
608022INPTF2	50	21	6
608024INPTF2	60	25	7
608025INPTF2	80	31	8

a richiesta filetto M8
thread M8 on request

articolo non consigliabile per rotelle
article not suitable for castors

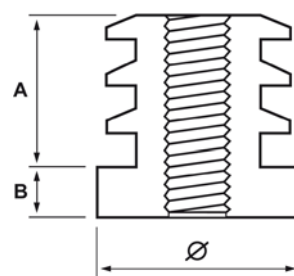
colore standard Nero
standard colour Black

PUNTALE ALETTATO CON ZOCCOLO INCLINATO 30° IN PE
RIBBED INSERT IN PE WITH 30° INCLINED BASE
art.607

Codice code	Ø Testa Ø head	A	B	C
607001INPIS2	18	21	16	5
607002INPIS2	25	25	23	6

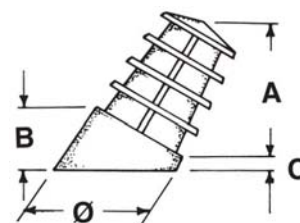
colore standard Nero
standard colour Black

a richiesta anche colore Bianco
White colour on request

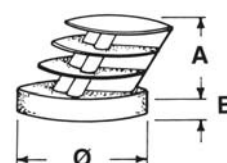
PUNTALE ALETTATO INCLINATO 30° IN PE
RIBBED INSERT 30° INCLINED IN PE
art.604

Codice code	Ø Testa Ø head	A	B
604001INPIT2	16	15	5
604002INPIT2	18	15	5
604003INPIT2	22	18	6
604004INPIT2	25	18	6
604005INPIT2	28	18	6
604006NNPIT2	30	18	6
604007INPIT2	60	40	6

colore standard Nero
standard colour Black



art.612

PUNTALE LISCIO IN PVC, ALETTATO IN PE*

SMOOTH INSERT IN PVC, RIBBED INSERT IN PE*

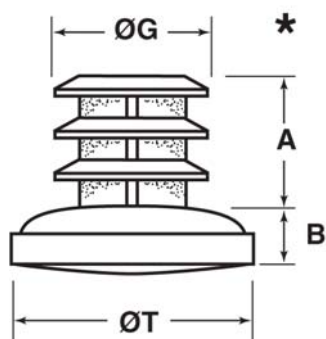
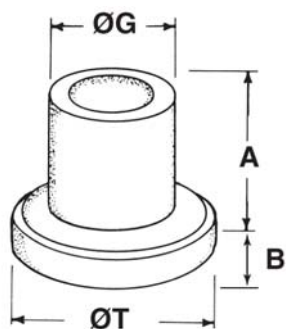

Codice code	Ø Gambo per Testa Ø stem for head	A	B
612008INPA2	8x18*	13	8
612001INPL1	8x18	16	8
612002INPL1	10x20	17	8
612003INPL	12x24	17	9
612004INPL1	14x28	17	9
612009INPA2	16x26*	16	9
612005INPL1	17x32	18	9
612006INPL1	18x32	19	10
612010INPA2	20x34*	21	9
612007INPL1	22x36*	29	10
612011MPPA2	25x30*	16	5
612012MPPA2	25x35*	16	7
612013MPPA2	25x40*	16	7
612013NNPL3	19x34	18	6

colore standard Nero
standard colour Blacka richiesta anche colore Bianco
White colour on request

art.700

PUNTALE COPRITESTA ALETTATO A TESTA SFERICA IN PE

RIBBED CAP SPHERICAL HEAD IN PE

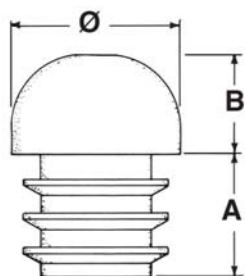

Codice code	Ø Testa Ø head	A	B
700007INCTS2	16	12	7
700008INCTS2	18	12	7,5
700001INCTS2	20	15	9
700002INCTS2	22	15	10
700003CPNCTS2	25	15	11
700009INCTS2	28	16	12,5
700004INCTS2	30	18	13,5
700005INCTS2	32	18	16,5
700006INCTS2	35	20	17
700010INCTS2	40	22	19,5
700011MPNCTS2	60	30	32

colore standard Nero
standard colour Blacka richiesta in vari colori, testa Ø 25 anche cromato o con testa metallo cromato
on request others colours, Ø 25 head with chromate metal head

COPRITESTA ALETTATO IN PE
RIBBED CAP IN PE

Codice code	Ø Testa Ø head	A	B
701001CPNCTA2	10	8	2
701002CPNCTA2	12	8	2
701003NNCTA2	14	8	2
701018INCTA2	15	8	3
701004NNCTA2	16	8	3
701005MPNCTA2	18	9	3
701006MPNCTA2	20	9	4
701007MPNCTA2	22	10	4
701008NNCTA2	25	13	4
701009INCTA2	28	15	5
701010MPNCTA2	30	17	5
701011MPNCTA2	32	16	5
701012INCTA2	35	17	5
701013MPNCTA2	40	17	5
701014INCTA2	45	17	5
701015INCTA2	50	17	5
701016MPNCTA2	60	17	5
701017INCTA2	80	17	6
701019INCTA2	100	29	6

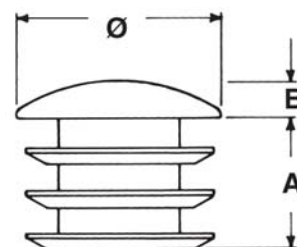
art.701

colore standard Nero.
A richiesta:
colore Bianco
testa Ø 25,
con 1 aletta.

standard colour Black.
On request:
white colour,
head Ø 25,
with 1 ribbed.

COPRITESTA ALETTATO IN PE CON TESTA IN METALLO CROMATO
RIBBED CAP IN PE WITH CHROMATE METAL HEAD

Codice code	Ø Testa Ø head	A	B
705001INCTC2	13	8	2
705002INCTC2	14	10	2
705003INCTC2	16	10	2
705004INCTC2	18	10	2
705005INCTC2	19	10	2
705006INCTC2	20	10	3
705007INCTC2	22	11	3
705008INCTC2	25	15	3
705009INCTC2	28	15	3
705010INCTC2	30	16	3
705011INCTC2	32	16	3
705012INCTC2	35	16	3
705013INCTC2	38	16	3
705014INCTC2	40	16	3
705015INCTC2	45	16	3
705016INCTC2	50	12	3
705017INCTC2	60	12	3
705018INCTC2	80	12	3

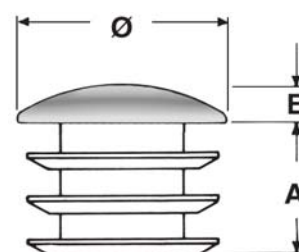
art.705

a richiesta testa ottonata.
per Ø 25 - 50 - 60 - 80
a richiesta per vari spessori tubo.
dal Ø 20 al Ø 80 si possono fornire con
foro Ø 6 per inserimento ventosa.

brass head only on request.
for Ø 25 - 50 - 60 - 80
only on request for different tube
thickness.
for Ø 20 up to Ø 80 mm. we can supply
with hole Ø 6 mm. for inserting of buffer.

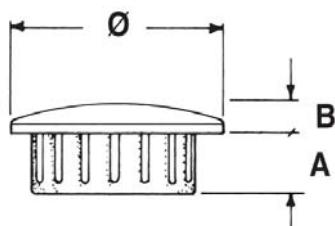

art.707

COPRITESTA TONDO LISCIO IN ABS
SMOOTH CAP IN ABS

Codice code	Ø TESTA Ø head	Spess. Tubo Ø tube th.	A	B
707001MNCL7	8	1	4,5	8,5
707002MNCL7	10	1	5	2
707003MNCL7	12	1	5	2
707004MNCL7	13	1	6	2
707005MNCL7	14	1	8	3
707006MNCL7	16	1	8	3
707007MNCL7	16	1,2	8	3
707008MNCL7	16	1,5	8	3
707009MNCL7	18	1	8	3
707010MNCL7	18	1,2	8	3
707011MNCL7	18	1,5	8	3
707012MNCL7	19	1,2	9	3
707013MNCL7	19	1,5	9	3
707014MNCL7	20	1	8	3
707015MNCL7	20	1,2	8	3
707016MNCL7	20	1,5	8	3
707017MNCL7	22	1	8	3
707018MNCL7	22	1,2	8	3
707019MNCL7	22	1,5	8	3
707020MNCL7	22	2	8	3
707021NNCL7	25	0,9÷1,2	11	4
707022NNCL7	25	0,6	11	4
707023MNCL7	25	1,5	11	4
707024MNCL7	25	2	11	4
707061MNCL7	25	2,5	8	4
707062MNCL7	25,4	1,25	8	4
707025MNCL7	28	1	10	4
707026MNCL7	28	1,2	10	4
707027MNCL7	28	1,5	10	4
707028MNCL7	28	2	10	4
707060MNCL7	30	1	10	5
707029MNCL7	30	1,2	10	5
707030MNCL7	30	1,5	10	5
707031MNCL7	30	2	10	5
707032CPNCL7	32	1,2	10	4
707033MNCL7	32	1,5	10	4
707034MNCL7	32	2	10	4
707063MNCL7	32	3	10	4
707035MNCL7	35	1	10	3
707036MNCL7	35	1,2	10	3
707037MNCL7	35	1,5	10	3

segue / continue >>

Codice code	Ø TESTA Ø head	Spess. Tubo Ø tube th.	A	B
707038MNCL7	35	2	10	3
707039MNCL7	38	1,5	10	3
707040MNCL7	38	2	10	3
707041MNCL7	40	1	10	3
707042MNCL7	40	1,5	10	3
707043MNCL7	40	2	10	3
707044MNCL7	45	1,5	11	4
707045MNCL7	45	2	11	4
707046MNCL7	50	1	11	5
707047MNCL7	50	1,2	11	5
707048CPCL7	50	1,5	11	5
707049MNCL7	50	2	11	5
707050MNCL7	60	1	11	5
707051MNCL7	60	1,2	11	5
707052MNCL7	60	1,5	11	5
707053MNCL7	70	1,2	11	5
707054MNCL7	70	1,5	11	5
707055MNCL7	80	1,2	11	5
707056MNCL7	80	1,5	11	5
707057MNCL7	90	1,2	11	5
707058MNCL7	90	1,5	11	5
707059MNCL7	120	5	16	8

colore standard Nero
standard colour Black

a richiesta Cromato, Satinato, Ottonato
on request Chrome, Satin, Brass plated

COPRIFORO PER SERRAMENTI IN PVC

INSERT FOR LOCKS IN PVC

Codice code	Ø Testa Ø head	A	B	C
607001INPIS2	18	21	16	5
607002INPIS2	25	25	23	6

colore standard Nero
standard colour Black

a richiesta anche colore Grigio
Grey colour on request

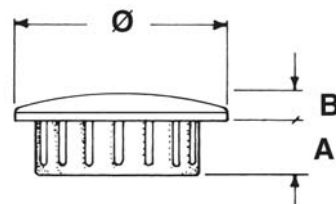

art.741

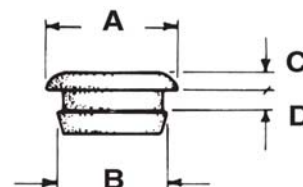

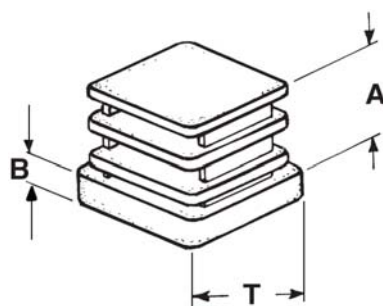

art.602

PUNTALE QUADRO ALETTATO IN PE
SQUARE RIBBED INSERT IN PE

Codice code	Testa head	A	B
602001INPQA2	12x12	12	5
602002INPQA2	15x15	11	4
602003INPQA2	16x16	17	5
602004INPQA2	18x18	12	5
602005CPNPQA2	20x20	17	5
602006INPQA2	22x22	17	5
602007INPQA2	25x25	20	6
602008NNPQA2	30x30	21	6
602014INPQA2	32x32	21	6
602009INPQA2	35x35	21	6
602010NNPQA2	40x40	21	6
602015INPQA2	45x45	26,5	5
602011INPQA2	50x50	21	6
602012INPQA2	60x60	22	6
602013INPQA2	70x70	25	6
602016INPQA2	80x80	30	6
602017INPQA2	100x100	30	6

colore standard Nero
standard colour Blacka richiesta anche colore Bianco
White colour on request

art.609

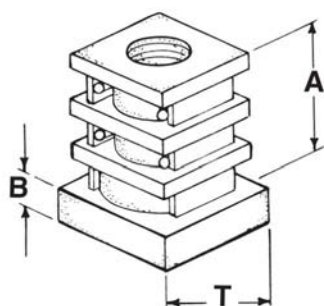
PUNTALE ALETTATO QUADRO IN PP FILETTATO M10
SQUARE RIBBED INSERT THREAD M10 IN PP

Codice code	Testa head	A	B
609001INPQF9	15x15x8 MA	18	5
609002INPQF9	16x16x8 MA	18	5
609004INPQF9	18x18x10 MA	18	5
609006INPQF9	20x20x10 MA	18	5
609008INPQF9	22x22x10 MA	18	5
609010INPQF9	25x25x10 MA	19	5
609012NNPQF9	30x30x10 MA	15	6
609020NNPQF9	30x30x12 MA	15	6
609014INPQF9	35x35x10 MA	21	6
609016NNPQF9	40x40x10 MA	24	6
609019NNPQF9	40x40x12 MA	24	6
609018INPQF9	50x50x10 MA	30	7
609021INPQF9	60x60x10 MA	25	7
609025INPQF9	80x80x10 MA	30	8

a richiesta filettato M8
thread M8 on requestnon consigliabile per rotelle
not suitable for castorscolore standard Nero
standard colour Black

PUNTALE QUADRO ALETTATO INCLINATO 30° IN PE
SQUARE RIBBED INSERT 30° INCLINED IN PE
art.605

Codice code	Testa head	A	B
605001INPIQ2	20x20	19	6
605002INPIQ2	25x25	18	6
605003INPIQ2	30x30	20	6

 colore standard Nero
 standard colour Black

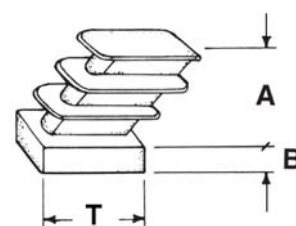
 a richiesta anche colore Bianco
 White colour on request

COPRITESTA - PUNTALE QUADRO ALETTATO IN PE
SQUARE CAP - INSERT, RIBBED IN PE
art.709

Codice code	Testa head	A	B
709001INCPTA2	20x20	19	9
709002INCPTA2	22x22	18	11
709003INCPTA2	25x25	19	12
709004INCPTA2	15x15	15	8
709005INCPTA2	18x18	16	8

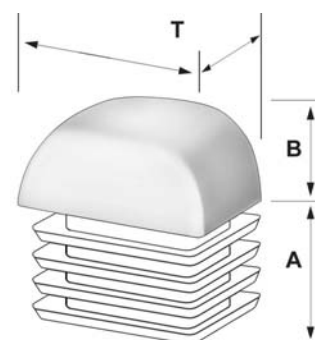
 colore standard Nero
 standard colour Black

 a richiesta anche colore Bianco
 White colour on request

COPRITESTA ALETTATO QUADRO IN PE
SQUARE RIBBED CAP IN PE
art.702

Codice code	Testa head	A	B
702001INCQA2	12x12	9	3
702002INCQA2	14x14	10	3
702003INCQA2	15x15	11	3
702004INCQA2	16x16	10	3
702005INCQA2	18x18	10	3
702006CPNCQA2	20x20	11	4
702007CPNCQA2	25x25	15	5
702008CPNCQA2	30x30	15	5
702009INCQA2	35x35	15	4
702010CPNCQA2	40x40	16	4
702012INCQA2	50x50	20	5
702013INCQA2	60x60	24	7
702011NNCQL8	80x80 liscio 80x80 smooth	10	4

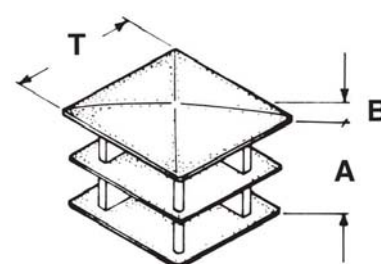
 colore standard Nero
 standard colour Black

 a richiesta anche colore Bianco
 White colour on request



art.719

COPRITESTA ALETTATO QUADRO IN PE TESTA IN METALLO CROMATO
SQUARE RIBBED CAP IN PE, WITH CHROMATE METAL HEAD

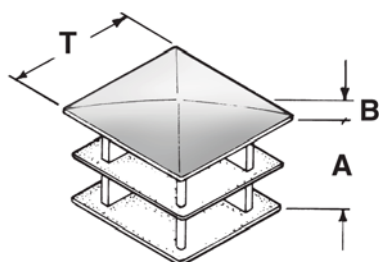

Codice code	Testa head	A	B
719001INCQTC2	16x16	9	2
719002INCQTC2	18x18	9	2
719003INCQTC2	20x20	10	2
719004INCQTC2	25x25	10	2
719005INCQTC2	30x30	10	3
719006INCQTC2	35x35	12	3
719007INCQTC2	40x40	12	3

a richiesta con testa Ottonata
Brass plated head on request

art.708

COPRITESTA LISCIO - QUADRO IN ABS
SQUARE SMOOTH CAP IN ABS

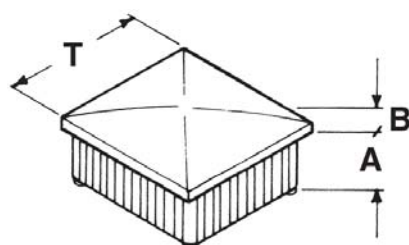

Codice code	Testa head	Spess. Tubo tube th.	A	B
708001MNCLQ7	12x12	1	7	2
708002MNCLQ7	12x12	1,2	7	2
708004MNCLQ7	15x15	1	8,5	2,5
708003MNCLQ7	15x15	1,2	8,5	2,5
708005MNCLQ7	15x15	1,5	8,5	2,5
708031MNCLQ7	16x16	1	8	3
708032MNCLQ7	16x16	1,5	8	3
708006MNCLQ7	18x18	1,2	8	3
708007MNCLQ7	18x18	1,5	8	3
708008MNCLQ7	20x20	1	7	3
708009MNCLQ7	20x20	1,2	7	3
708010MNCLQ7	20x20	1,5	7	3
708011MNCLQ7	25x25	1	7	3
708012MNCLQ7	25x25	1,2	7	3
708013MNCLQ7	25x25	1,5	7	3
708014MNCLQ7	25x25	2	7	3
708015MNCLQ7	30x30	1	10	4
708016MNCLQ7	30x30	1,2	10	4
708017MNCLQ7	30x30	1,5	10	4
708018MNCLQ7	35x35	1,2	11	4
708019MNCLQ7	35x35	1,5	11	4
708020MNCLQ7	40x40	1,2	11	4

segue / continue >>

Codice code	Testa head	Spess. Tubo tube th.	A	B
708021MNCLQ7	40x40	1,5	11	4
708022MNCLQ7	45x45	1,2	11	5
708023MNCLQ7	45x45	1,5	11	5
708024MNCLQ7	50x50	1,2	11	5
708025MNCLQ7	50x50	1,5	11	5
708033MNCLQ7	50x50	2	11	5
708034MNCLQ7	50x50	3	11	5
708026MNCLQ7	60x60	1,2	12	5
708027MNCLQ7	60x60	1,5	12	5
708028MNCLQ7	80x80	1,2	12	5
708029MNCLQ7	80x80	1,5	12	5
708030MNCLQ7	80x80	2	12	5

colore standard Nero
standard colour Black

a richiesta Cromato, Satinato, Ottonato
on request Chrome, Satin, Brass plated

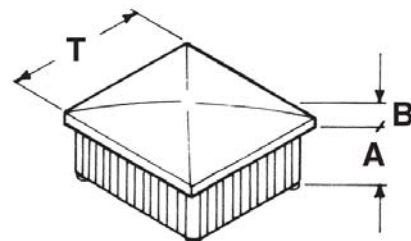

PUNTALE RETTANGOLARE SAGOMATO IN PE

RECTANGULAR RIBBED INSERT IN PE

Codice code	Testa head	A	B
603050INPRS2	30x20	25	25

art.603

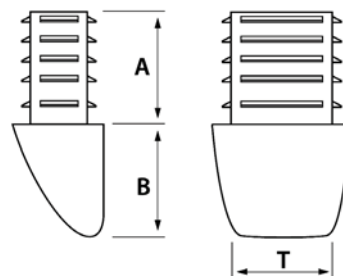

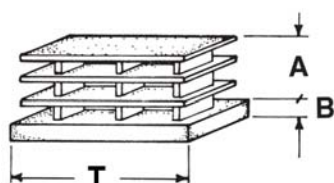

art.603

PUNTALE RETTANGOLARE ALETTATO IN PE
RECTANGULAR RIBBED INSERT IN PE

colore standard Nero
a richiesta colore Bianco

standard colour Black
White colour on request

Codice code	Testa head	A	B
603001INPRA2	10x15	11	5
603002INPRA2	10x20	15	5
603003INPRA2	10x25	15	5
603004INPRA2	10x30	15	5
603027INPRA2	10x35	16,5	5
603005INPRA2	10x40	15	5
603035INPRA2	10x50	17	5
603006INPRA2	15x20	12	5
603007INPRA2	15x25	17	5
603008INPRA2	15x30	12	5
603009INPRA2	15x35	18	6
603010INPRA2	15x40	18	6
603011INPRA2	15x50	15	5
603028INPRA2	15x60	17	5
603012INPRA2	20x25	12	5
603013INPRA2	20x30	17	5
603014INPRA2	20x35	17	5
603015INPRA2	20x40	17	5
603016INPRA2	20x50	17	5
603017INPRA2	20x60	17	5
603033INPRA2	20x100	23	6
603018INPRA2	25x35	19	6
603019INPRA2	25x40	18	6
603020INPRA2	25x50	21	6
603026INPRA2	27x40	18	5
603021INPRA2	30x40	18	6
603029INPRA2	30x45	18	6
603022INPRA2	30x50	18	6
603023INPRA2	30x60	21	6
603032INPRA2	30x70	17	6
603034INPRA2	30x80	17	6
603025NNPRA2	40x60	21	5
603036INPRA2	40x70	18	6
603024INPRA2	40x80	23	6
603030INPRA2	40x100	23	6
603031INPRA2	50x100	23	6

PUNTALE RETTANGOLARE ALETTATO IN PP FILETTATO M10
RECTANGULAR RIBBED INSERT IN PP THREAD M10

Codice code	Testa head	A	B
610001INPRF9	20x30	19	6
610002INPRF9	20x35	19	6
610003INPRF9	20x40	19	6
610004INPRF9	20x50	19	6
610006INPRF9	20x60	19	6
610005INPRF9	25x50	22	6
610008INPRF9	30x60	22	6

non consigliabile per rotelle
not suitable for castors

a richiesta filetto M8
thread M8 on request

colore standard Nero
standard colour Black

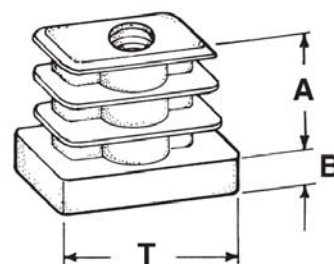
art.610

PUNTALE RETTANGOLARE ALETTATO INCLINATO 20° IN PE
RECTANGULAR RIBBED INSERT 20° INCLINED IN PE

Codice code	Testa head	A	B
606050INPI202	20x30	18	6

colore standard Nero
standard colour Black

a richiesta anche colore Bianco
White colour on request

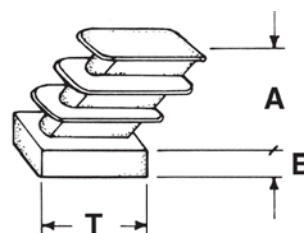
art.606

PUNTALE RETTANGOLARE ALETTATO INCLINATO 30° IN PE
RECTANGULAR RIBBED INSERT 30° INCLINED IN PE

Codice code	Testa head	A	B
606001INPIR2	15x30	18	6
606002INPIR2	20x40	19	6

colore standard Nero
standard colour Black

a richiesta anche colore Bianco
White colour on request

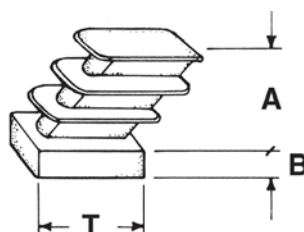
art.606

PUNTALE RETTANGOLARE INCLINATO 30° ALETTATO A ZOCCOLO IN PE
RECTANGULAR RIBBED INSERT 30° INCLINED HEAD IN PE

Codice code	Testa head	A	B	C
606075INPIRZ2	15x30	22	22	5

colore standard Nero
standard colour Black

a richiesta anche colore Bianco
White colour on request

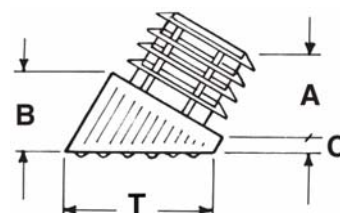
art.606

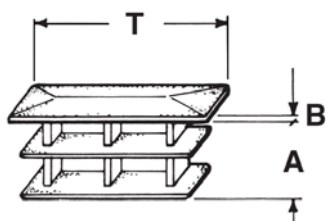

art.704

COPRITESTA RETTANGOLARE ALETTATO IN PE
RECTANGULAR RIBBED CAP IN PE

Codice code	Testa head	A	B
704001INCRA2	10x15	9	3
704002INCRA2	10x20	9	3
704003INCRA2	10x30	9	3
704004INCRA2	10x40	10	3
704005INCRA2	15x20	10	3,5
704006INCRA2	15x25	10	3,5
704007INCRA2	15x30	10	3,5
704008INCRA2	15x35	10	3,5
704009INCRA2	15x40	10	3,5
704010INCRA2	20x30	10	4
704011INCRA2	20x35	10	4
704012INCRA2	20x40	11	4
704023MPNCRA2	20x50	11	3,5
704013INCRA2	20x80	16	3
704014INCRA2	25x40	12	4
704015INCRA2	25x50	12	4
704016INCRA2	25x100	15	3
704017NNCRA2	30x40	13	5
704018INCRA2	30x50	13	5
704021INCRA2	30x60	19	5
704019INCRA2	30x100	16	3
704022NNCRA2	40x60	21	5
704024INCRL2	40x80x2 liscio 40x80x2 smooth	15	11
704020NNCRL2	50x100x2 liscio 50x100x2 smooth	20	3

colore standard Nero
standard colour Blacka richiesta anche colore Bianco
White colour on request

art.738

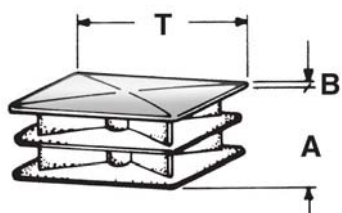
COPRITESTA RETTANGOLARE IN PE CON TESTA IN METALLO CROMATO
RECTANGULAR RIBBED CAP IN PE WITH CHROMATE METAL HEAD

Codice code	Testa head	A	B
738001INCRTC2	10x20	10	1,5
738002INCRTC2	15x20	10	2
738003INCRTC2	15x30	10	2
738004INCRTC2	20x40	11	2

a richiesta con testa Ottonata
Brass plated head on request

COPRITESTA RETTANGOLARE LISCIO IN ABS
RECTANGULAR SMOOTH CAP IN ABS
art.739

Codice code	Testa head	Spess. Tubo tube th.	A	B
739001MNCRL7	8x15	1	8	2
739002MNCRL7	10x15	1	9	2
739003MNCRL7	10x15	1,2	9	2,5
739004MNCRL7	10x20	1	9	2,5
739005MNCRL7	10x20	1,2	9	2,5
739008MNCRL7	10x25	1,5	9	2,5
739010MNCRL7	10x30	1,5	9	2,5
739017MNCRL7	10x40	1,2	9	3
739018MNCRL7	10x40	1,5	9	3
739006MNCRL7	15x20	1,2	9	3
739007MNCRL7	15x20	1,5	9	3
739009MNCRL7	15x25	1,5	9	3
739011MNCRL7	15x30	1,2	9	3
739012MNCRL7	15x30	1,5	9	3
739015MNCRL7	15x35	1,5	9	3
739019MNCRL7	14x40	1	9	3
739020MNCRL7	15x40	1,2	9	3
739021MNCRL7	15x40	1,5	9	3
739013MNCRL7	20x30	1,2	9	3
739014MNCRL7	20x30	1,5	9	3
739016MNCRL7	20x35	1,5	9	3
739022MNCRL7	20x40	1,2	9	3,5
739023MNCRL7	20x40	1,5	9	3,5
739028CPCRL7	20x40	2	9	3,5
739024MNCRL7	20x50	1,2	10	3
739025MNCRL7	20x50	1,5	10	3
739026MNCRL7	20x60	1,5	10	3
739027CPCRL7	30x40	2	12	3

colore standard Nero
standard colour Black

a richiesta Cromato, Satinato, Ottonato
on request Chrome, Satin, Brass plated

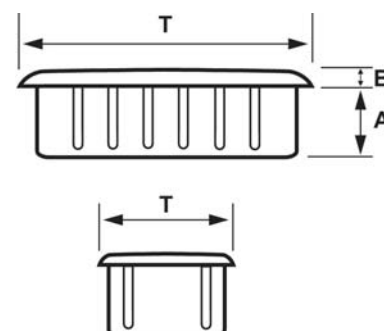
PUNTALE ELLISSE ALETTATO IN PE
ELLIPTICAL RIBBED INSERT IN PE
art.611

Codice code	Testa head	A	B
611002INPEA2	15x30	14	4
611001INPEA2	20x40	18	6
611003INPEA2	30x60	19	5
611004INPEL2	30x60x2 liscio-smooth	15	5

colore standard Nero
standard colour Black

a richiesta anche colore Bianco
White colour on request

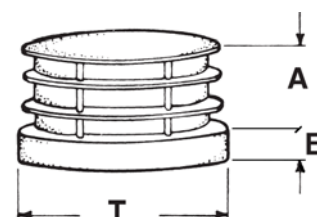

art.718

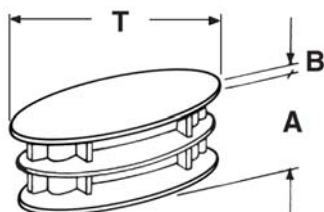
COPRITESTA ELLISSE IN PE
ELLIPTICAL RIBBED CAP IN PE

Codice code	Testa head	A	B
718001INCEA2	15x30	10	3
718002INCEA2	18x36	10	3,5
718004INCEA2	20x35	11	5
718003INCEA2	20x40	11	4
718005INCELA2	30x60x2 liscio-smooth	15	10

colore standard Nero
standard colour Blacka richiesta anche colore Bianco
White colour on request

art.601

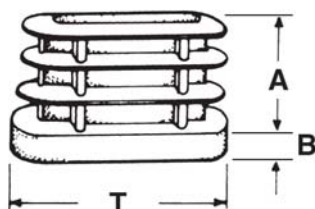
PUNTALE OVALE ALETTATO IN PE
OVAL RIBBED INSERT IN PE

Codice code	Testa head	A	B
601001INPOA2	15x30	17	5
601006INPOA2	12x25	12,5	5
601002INPOA2	18x36	18	6
601003INPOA2	20x40	19	6
601004INPOA2	25x50	16	5
601005INPOA2	30x60	18	5

colore standard Nero
standard colour Blacka richiesta anche colore Bianco
White colour on request

art.601

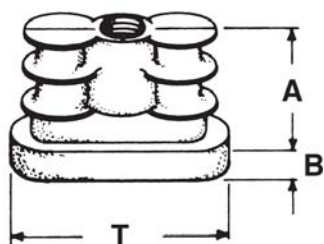
PUNTALE OVALE ALETTATO IN PP FILETTATO M10
OVAL RIBBED INSERT IN PP, THREAD M10

Codice code	Testa head	A	B
601075INPOF9	18x36	18	6,5
601076INPOF9	20x40	18	6,5

colore standard Nero
standard colour Blacka richiesta filettato M8
thread M8 on requestnon consigliabile per rotelle
not suitable for castors

art.601

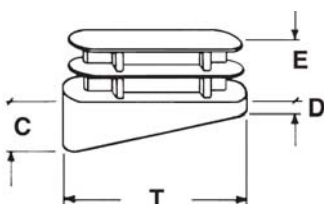
PUNTALE OVALE INCLINATO 12,5° IN PE
OVAL RIBBED INSERT 12,5° INCLINED IN PE

Codice code	Testa head	C	D	E
601050INPOI2	30x15	13	7	11

colore standard Nero
standard colour Blacka richiesta: colore Bianco / versione inclinato 30°
on request: White colour / inclined 30° version available

COPRITESTA OVALE ALETTATO IN PE
OVAL RIBBED CAP IN PE
art.703

Codice code	Testa head	A	B
703001INCOA2	10x20	10	2
703002INCOA2	15x30	10	3
703003INCOA2	18x36	10	3
703004INCOA2	20x40	10	4
703005INCOA2	25x50	22	4
703006INCOA2	30x60	22,5	3

colore standard Nero
standard colour Black a richiesta anche colore Bianco
White colour on request

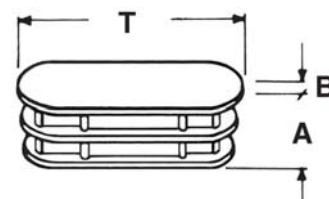
COPRITESTA PUNTALE OVALE TESTA ALTA IN PE
OVAL RIBBED INSERT, HIGH HEAD, IN PE
art.703

Codice code	Testa head	A	B
703030INCPTA2	30x15	12	8

colore standard Nero
standard colour Black

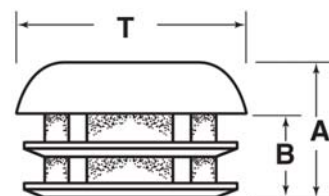
PUNTALE COPRITESTA SEMI OVALE IN PE
SEMI-OVAL RIBBED INSERT IN PE
art.703

Codice code	Testa head	A	B
703050INCISO2	15x30	12	3
703051INCISO2	20x40	13	3,5
703052INCISO2	25x40	13	3,5

colore standard Nero
standard colour Black a richiesta anche colore Bianco
White colour on request

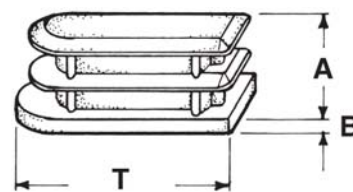
COPRITESTA OVALE IN PE CON TESTA IN METALLO CROMATO
OVAL RIBBED CAP IN PE WITH CHROMATE METAL HEAD
art.736

Codice code	Testa head	A	B
736001INCTC2	10x20	10	2
736002INCTC2	15x30	10	2,5
736003INCTC2	18x36	11	3
736004INCTC2	20x40	10	3

colore standard Nero
standard colour Black a richiesta testa Ottonata
Brass plated on request

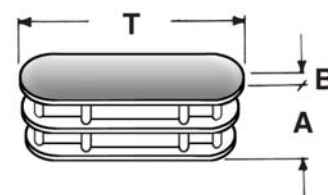



art.737

COPRITESTA OVALE LISCIO IN ABS
OVAL SMOOTH CAP IN ABS

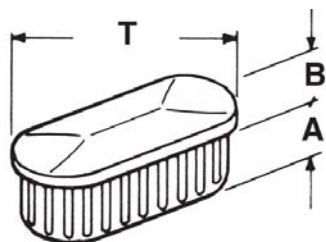

Codice code	Testa head	Spess. Tubo tube th.	A	B
737001MNCOL7	10x20	1	9	2,5
737002MNCOL7	10x20	1,2	9	2,5
737003MNCOL7	10x25	1,5	9	3
737004MNCOL7	15x25	1,5	9	3
737005MNCOL7	15x30	1,2	10	3
737006MNCOL7	15x30	1,5	10	3
737009MNCOL7	16x32	1,2	10	3
737012MNCOL7	17x45	1,5	10	3
737007MNCOL7	20x30	1,2	10	3
737008MNCOL7	20x30	1,5	10	3
737010MNCOL7	20x35	1,5	10	3
737011MNCOL7	20x40	1,5	10	3

colore standard Nero
standard colour Black

a richiesta Cromato, Satinato, Ottonato
on request Chrome, Satin, Brass plated

Il Ø interno dei calzanti è riferito al Ø esterno del tubo.

Internal Ø of outside caps is referred to the out side Ø of the tube.

CALZANTE EXPORT IN PVC

OUT SIDE CAP IN PVC

art.630

Codice code	Ø Tubo Ø tube	A	B
630001INCE1	2	7,5	6
630002INCE1	3	9,5	8
630003INCE1	4	11	9
630004LUNCE1	5	13	10
630005MPNCE1	6	14	11
630006INCE1	7	14	11
630007CPNCE1	8	16	13
630008LUNCE1	10	18	14
630009MPNCE1	12	21	17
630021INCE1	13	21	17
630010MPNCE1	14	23	18
630011MPNCE1	16	25	20
630012MPNCE1	18	27	22
630013MPNCE1	20	30	24
630014LUNCE1	22	32	26
630015MPNCE1	24	36	30
630016MPNCE1	26	37	31
630017LUNCE1	28	38	32
630018LUNCE1	30	41	34
630019LUNCE1	32	43	39
630020INCE1	35	47	40

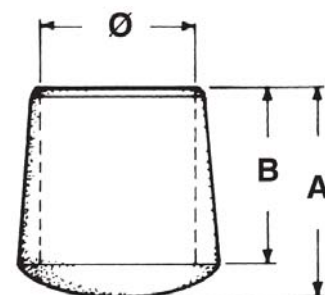

colore standard Nero
standard colour Black

a richiesta anche colore Bianco
White colour on request



art.631

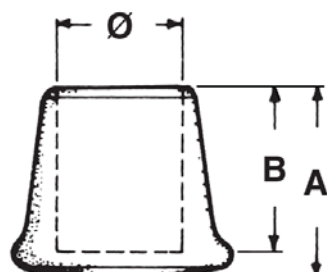

CALZANTE CAMPANA A BASE LARGA IN PVC
OUT SIDE CAP, WIDE BASE, IN PVC

Codice code	Ø Tubo Ø tube	A	B
631001INCC1	6	20	16
631002INCC1	8	23	18
631003INCC1	10	25	21
631004INCC1	12	27	23
631005INCC1	14	28	22
631006INCC1	16	29	22
631007INCC1	18	31	24
631008INCC1	20	33	26
631009MPNCC1	22	35	27
631010INCC1	24	35	28
631011INCC1	26	37	32
631012INCC1	28	41	34
631013INCC1	30	44	36
631014NNCC1	32	43	36
631015NNCC1	35	43	36

 colore standard Nero
 standard colour Black

 a richiesta anche colore Bianco
 White colour on request

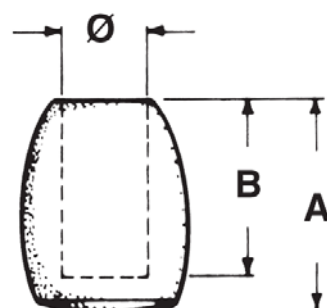
art.632



CALZANTE BOTTE IN PVC
OUT SIDE CAP, BARREL SHAPE, IN PVC

Codice code	Ø Tubo Ø tube	A	B
632001INCB1	6	19	14
632002INCB1	8	21	16
632003INCB1	10	23	18
632004INCB1	12	26	20
632005INCB1	14	28	21
632006INCB1	16	30	23
632007INCB1	18	31	24

 colore standard Nero
 standard colour Black

 a richiesta anche colore Bianco
 White colour on request

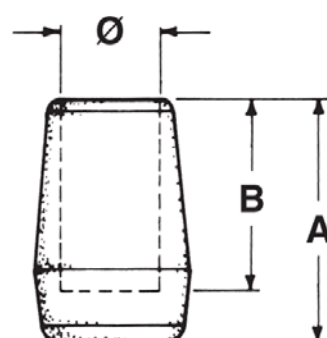
art.633

CALZANTE BOMBATO LUNGO IN PVC
OUT SIDE CAP, LONG SHAPE IN PVC

Codice code	Ø Tubo Ø tube	A	B
633001INCBL1	10	28	22
633002INCBL1	12	31	24
633003INCBL1	14	34	27
633004INCBL1	16	36	29
633005INCBL1	18	38	31
633006INCBL1	20	40	33
633007NNCBL1	25	47	35

 colore standard Nero
 standard colour Black

 a richiesta anche colore Bianco
 White colour on request

CALZANTE CILINDRICO IN PVC
OUT SIDE CAP CYLINDRICAL SHAPE IN PVC

Codice code	Ø Tubo Ø tube	A	B
636003BNCC1	4	15	12
636004NNCC1	4,5	15	12
636005NNCC1	5	15	12
636006NNCC1	5,5	15	12
636007NNCC1	6	15	12

colore standard Nero
standard colour Black

a richiesta anche colore Bianco
White colour on request

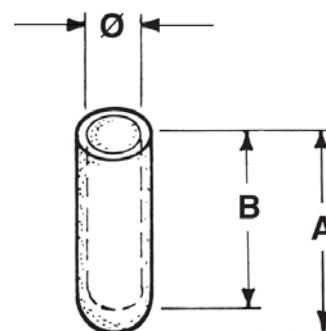
art.636

CALZANTE PIEDE LETTO IN POLITENE
OUT SIDE CAP FOR BED FOOT IN PE

Codice code	Ø Tubo Ø tube	B	C	D
637020INCPL2	50	64	32	9,5

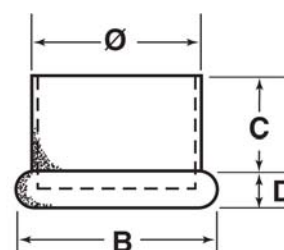
colore standard Nero
standard colour Black

art.637

CALZANTE SFERA IN PVC
OUT SIDE CAP BALL SHAPE IN PVC

Codice code	Ø Sfera Ø ball	A	B
740001INCS1	10	7	3
740002INCS1	10	8	4
740003INCS1	14	12	5

adatti per terminali filo ferro
suitable for terminal iron thread

colore standard Nero
standard colour Black

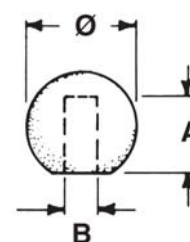
a richiesta colorato
coloured on request

art.740

CALZANTE INCLINATO 20° IN PVC
OUT SIDE CAP 20° INCLINED IN PVC

Codice code	Ø Tubo Ø tube	A	B	C
638001INCI301	25	38	27	20

colore standard Nero
standard colour Black

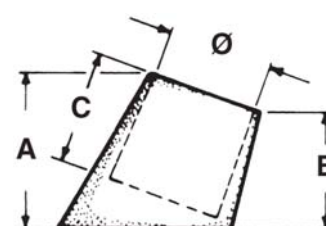
a richiesta anche colore Bianco
White colour on request

art.638



art.635

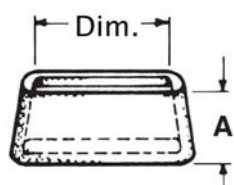

CALZANTE RETTANGOLARE ESTERNO PER PIATTO IN PVC
RECTANGULAR OUT SIDE CAP IN PVC

Codice code	Dimensioni dimensions	A
635009INCR1	25x5	19
635008INCR1	25x6	19
635006INCR1	25x8	19
635007INCR1	30x6	19

colore standard Nero
standard colour Black

a richiesta anche colore Bianco
White colour on request

art.639

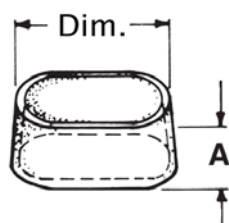

CALZANTE ESTERNO OVALE IN PVC
OVAL OUT SIDE CAP IN PVC

Codice code	Dimensioni dimensions	A
639050INCO1	15X30	23
639051INCO1	18X36	27
639052INCO1	20X40	28

colore standard Nero
standard colour Black

art.639

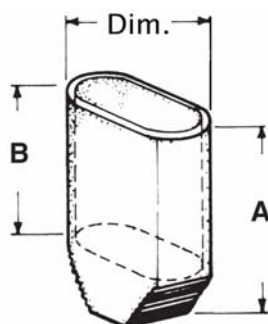

CALZANTE OVALE CON BASE INCLINATA IN PVC
OVAL OUT SIDE CAP INCLINED BASE IN PVC

Codice code	Dimensioni dimensions	A	B
639001INCOBI1	15X30	40	26

colore standard Nero
standard colour Black

art.651

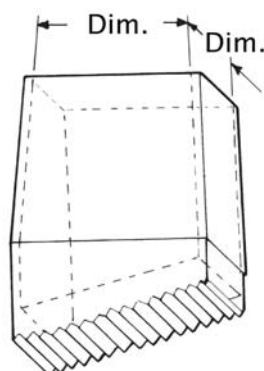

CALZANTE RETTANGOLARE INCLINATO IN PVC
RECTANGULAR OUT SIDE CAP INCLINED IN PVC

Codice code	Dimensioni dimensions
651001NNCRI1	33x18
651002NNCRI1	40x20

colore standard Nero
standard colour Black

PUNTALE RETTANGOLARE CURVO DENTATO IN PVC
RECTANGULAR INSERT IN PVC

Codice code	Dimensioni dimensions
652001NNCRD1	60x20
652002NNCRD1	80x30
652003NNPOD1 ovale	40x20

colore standard Nero
 standard colour Black

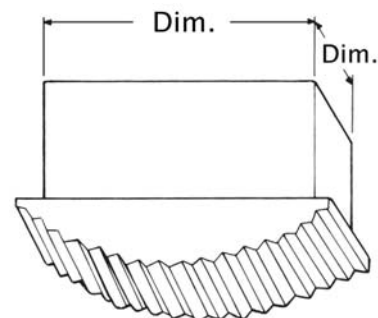
art.652

CALZANTE PERA IN PVC
OUT SIDE CAP IN PVC

Codice code	Ø Tubo Ø tube	A	B	C
649001INCP1	20	36	27	32
649002INCP1	28	48	34	44
649003INCP1	30	42	34	42
649004INCP1	32	49	34	45
649005INCP1	35	52	36	48
649006INCP1	38	57	40	53
649007INCP1	40	60	42	56

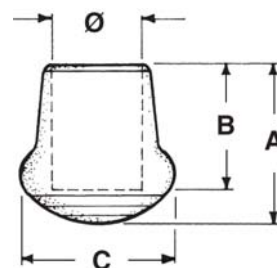
colore standard Nero
 standard colour Black

art.649

CALZANTE TONDO IN PE
ROUND OUT SIDE CAP IN PE

Codice code	Ø Tubo Ø tube	B	C	D
640001INCT2	20	35	23	20

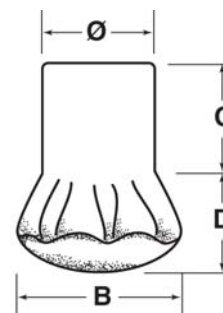
colore standard Nero
 standard colour Black

art.640



art.653

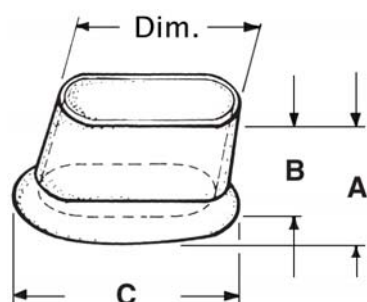

CALZANTE SCALE PERA OVALE IN PVC
OVAL LADDER OUT SIDE CAP IN PVC

Codice code	Dimensioni dimensions	A	B	C
653001INCSO1	20x40	41	34	52x32
653002INCSO1	25x50	50	43	65x40

colore standard Nero
standard colour Black

art.650

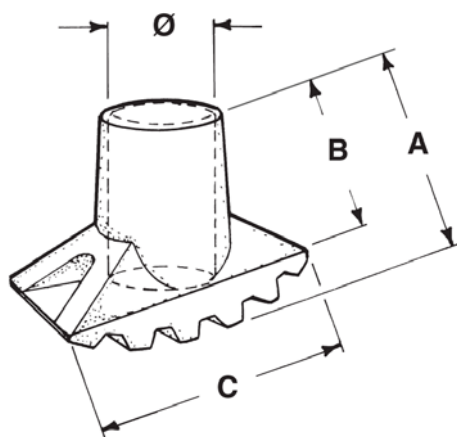

CALZANTE ARTIGLIO TONDO IN PVC
CLAWED OUT SIDE CAP IN PVC

Codice code	Ø Tubo Ø tube	A	B	C
650001INCA1	30	69	53	78x42
650002INCA1	32	61	59	81x46
650003INCA1	35	78	62	87x48
650004INCA1	38	83	67	94x52
650005INCA1	40	95	73	97x54

colore standard Nero
standard colour Black

art.650

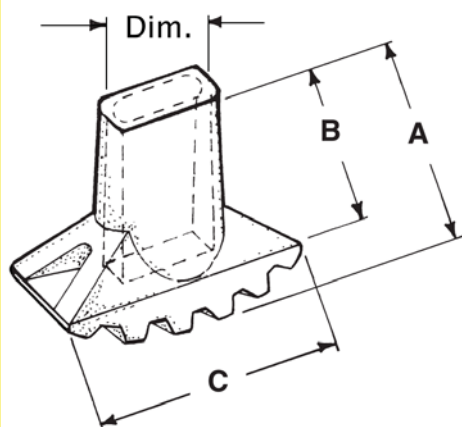

CALZANTE ARTIGLIO OVALE IN PVC
OVAL CLAWED OUT SIDE CAP IN PVC

Codice code	Dimensioni dimensions	A	B	C
650006INCAO1	20x40	72	56	89x38
650007INCAO1	25x50	89	76	114x46

colore standard Nero
standard colour Black

VENTOSA CON GAMBO FORATO IN PVC

PVC SUCKER WITH DRILLED SHANK

art.713

Codice code	A	B	C	D
713001NNVG1	15	7	4	6
713002NNVG1	20	7	5	6
713003BNVG1	30	12	8	10

colore standard Trasparente
standard colour Transparent

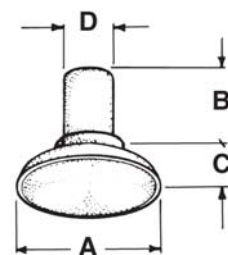
a richiesta colore Nero o Bianco
Black or White colours or on request

VENTOSA CON GAMBO FORATO IN PVC

PVC SUCKER WITH DRILLED SHANK

art.713

Codice code	A	B	C	Foro hole
713004BNVG1	78	14	17	16
713005BNVG1	78	14	17	18

colore standard Nero
standard colour Black

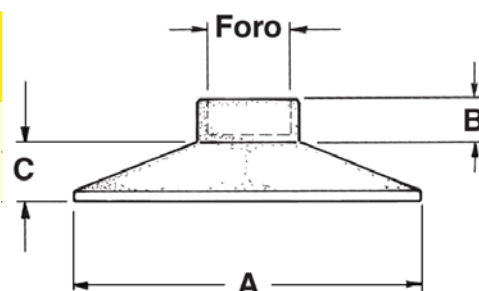
a richiesta colore Bianco o Trasparente
Black or Transparent colours on request

VENTOSA CON SFERA A SOTTOSQUADRA IN PVC

PVC SUCKER WITH BALL

art.714

Codice code	A	B	C	D
714001BNVS1	20	8	6	6
714002INVS1	25	12	5	7
714003INVS1	30	13	5	8
714005BNVCS1	20	8	7	7

colore standard Trasparente
standard colour Transparent

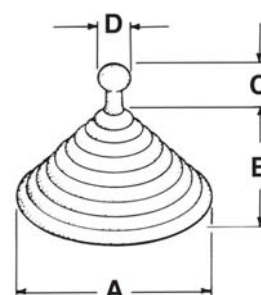
a richiesta colore Nero o Bianco
Black or White colours or on request



art.715

VENTOSA CON SOTTOSQUADRA IN PVC
PVC SUCKER WITH BACK-DRAFT

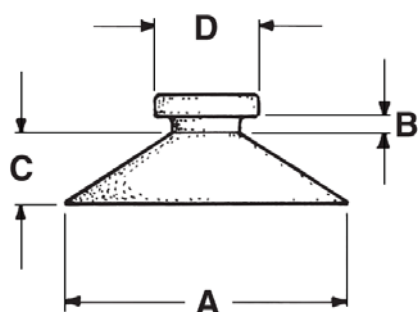

Codice code	A	B	C	D
715001NNT1	40	3	8	15

colore standard Nero
standard colour Black

art.916

VENTOSA IN PVC CON GAMBO FILETTATO 8 MA
PVC SUCKER WITH THREADED SHANK M8

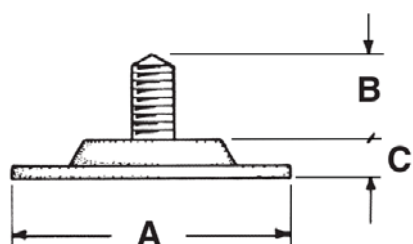

Codice code	A	B	C
916001NNVFO81	45	13	6

colore standard Nero
standard colour Black

particolare accoppiabile con Manopolina Zigrinata art. 915
this article may be used together with Knurled Knob art. 915

PASSAFILO A BUSSOLA IN PVC

WIRE AND CABLE PROTECTION IN PVC

Codice code	A	B	C
300001BN1	16	9	43
301002NN1	8	2,5	20

colore standard Nero

standard colour Black

art.300-301

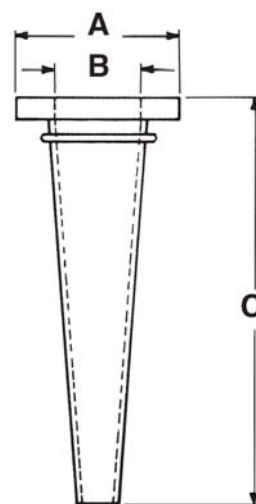

PASSAFILO CON MEMBRANA IN PVC

WEBBED WIRE AND CABLE PROTECTION IN PVC

Codice code	NR	A	B	C	E	F	H
302008BN1	8	15	9	12	6	1,5	cieco blind
302009BN1	9	16	8	13	5	1,5	2
302016BN1	16	18	9	14	7,5	1,5	5
302020BN1	20	26	15	20	7,5	1	5
302021BN1	21	23	14	19	5,5	2	7
302037BN1	34	17	9	13	8	3	cieco blind
302048BN1	40	23	14	20	6	1,5	cieco blind
302049BN1	43	53	35	46	11	2,5	cieco blind

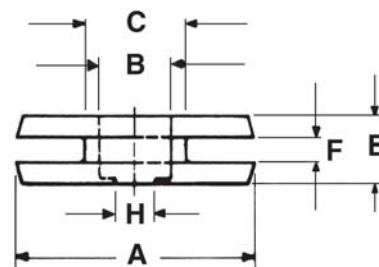

A =	B =	C =	E =	F =	H =
diametro esterno	diametro foro	diametro gola	altezza passafilo	altezza gola	membrana
external diam.	hole diam.	rim diam.	tot. height	rim height	film

colore standard Nero
standard colour Black

a richiesta in Gomma Termoplastica
Thermoplastic Rubber on request



art.302

PASSAFILO IN PVC

WEBBED WIRE AND CABLE PROTECTION IN PVC

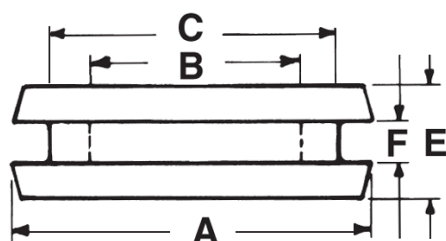

Codice code	NR	A	B	C	E	F
302001BN1	1	10	3,5	9	6	1
302002BN1	2	10	4	8	8	1,5
302003BN1	3	9	3	7	6	1
302004NN1	4	12	6	9	5,5	2,5
302004NNBV1	4	15	6	8	6	2,5
302005BN1	5	11	5	9	8	1
302006BN1	6	15	5	10	5,5	1
302007BN1	7	13	5	11	7	1,5
302010BN1	10	14	7,5	10	8	1,5
302011BN1	11	15	6,5	10	6	1,5-4
302012BN1	12	17	9	13	5	2
302014BN1	14	16	9,5	12	10	1-2,5
302015BN1	15	19	10	15	7,5	1,5
302018BN1	18	14	6,5	10	7,5	1,5
302019BN1	19	22	12	18	10	3
302022BN1	22	33	19	25	10	1,5
302023BN1	23	26	12	19	7	1
302024NN1	24	37	22	28	9	3
302025NN1	25	50	35,5	40	9	3
302026BN1	24	13	6	10	5	1-2
302028BN1	26	28	16	20	8	2
302029BN1	27	23	14	19	6	1,5
302030BN1	28	12	6	8	5	1,5-4
302031BN1	29	33	18	25	7	1,5-4
302032BN1	30	25	14	17	7	1
302033BN1	31	25	10	17	7	2
302034BN1	32	21	12	16	7	1,5
302035BN1	33	18	8	12	10	3
302036NN1	34	8	3	5	5	2
302040BN1	37	70	50	55	10	2
302041BN1	35	12	5	9	6	3
302043BN1	38	14	6	10	9	2,5
302044BN1	41	46	28	36	13	3
302045BN1	42	20,5	11,5	16	7,5	1,5
302046BN1	44	90	74	84	6	1
302047BN1	47	38	22	29	11	2-4-5

A =	B =	C =	E =	F =
diametro esterno	diametro foro	diametro gola	altezza passafilo	altezza gola
external diam.	hole diam.	rim diam.	tot. height	rim height

colore standard Nero
standard colour Black

a richiesta in Gomma Termoplastica
Thermoplastic Rubber on request

RONDELLA SOTTOVITE IN PE HD
PE HD WASHER
art.313

Codice code	A	B	C
313001INRS2	11	5,5	1,5
313002INRS2	11,5	3,2	1,2
313003INRS2	12	4,5	1,5
313004INRS2	14	6	1,5
313005INRS2	15	5	1,5
313006NNRS1	15	5,5	1,5
313008INRS2	16	6	1,5
313011INRS2	22	10	2
313012INRS2	24	8,5	2
313013NNRS1	25	15	3
313015INRS2	19	7	2
313016NNR3	39	11	12

colore standard Nero a richiesta anche colore Bianco
 standard colour Black White colour on request

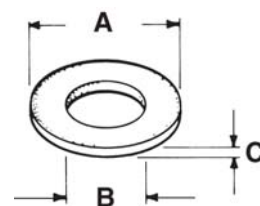
RONDELLA PARACOLPO IN PVC
BUFFER WASHER IN PVC
art.735

Codice code	A	B	C	D
735001NNRP1	10	6	5	3
735002INRP1	15	5	8,5	5
735003INRP1	18	6	9,5	3
735004NNRP1	22	6	9	4
735005INRP1	25	6	10	2

colore standard Nero a richiesta anche colore Bianco
 standard colour Black White colour on request

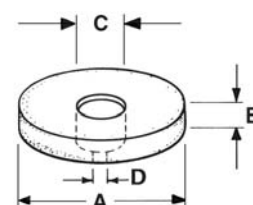
RONDELLA FORO SVASATO IN PVC
COUNTER SUNK HEAD WASHER IN PVC
art.311

Codice code	A	H
311007INRS1	27,5	4,5
311009INRS1	30	4,5

colore standard Nero
 standard colour Black

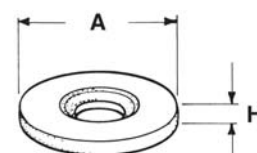

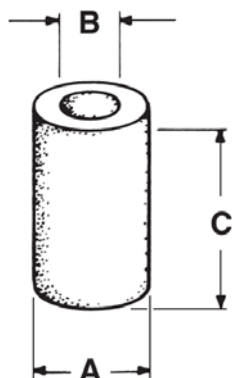

art.733

TUBETTO DISTANZIATORE IN PE
PE SPACER

Codice code	A	B	C
733001INDC2	8	5	3,7
733003INDC2	10	4	20
733004INDC2	10	6	4
733005INDC2	10	6	6
733006INDC2	10	6	9
733007INDC2	10	6	10
733008INDC2	10	6	12
733009INDC2	10	6	14
733010INDC2	10	6	15
733011INDC2	10	6	17
733012INDC2	10	6	19
733013INDC2	11	4	10
733014INDC2	11,5	7,5	5
733015INDC2	12	8,5	6
733016INDC2	13	6,3	3,5
733017INDC2	14	5	3
733021INDC2	14	5	9
733018INDC2	14	6,5	7
733019INDC2	17	6	10
733050NTDC1	16	8,5	10
733020INDC2	24	10	15

colore standard Nero
standard colour Blacka richiesta anche colore Bianco
White colour on request

art.733

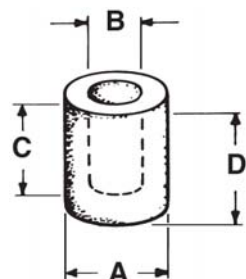
TUBETTO PARACOLPO CIECO TONDO IN PVC
ROUND BLIND BUFFER IN PVC

Codice code	A	B	C	D
733030INTPC1	17	12	21	24
733031INTPC1	14	6	16,5	18

colore standard Nero
standard colour Blacka richiesta colore Bianco o Trasparente
White or Transparent colours on request

art.733

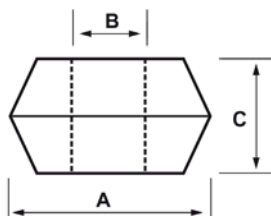
DISTANZIATORE CONICO IN PE
CONICAL SPACER IN PE

Codice code	A	B	C
733040IBDC2	14	5	9

colore standard Nero
standard colour Black

DISTANZIATORE LISCIO IN PE

SMOOTH SPACER IN PE

Codice code	A	B	C
733042IBDL2	20	6,5	7

colore standard Bianco
standard colour White

art.733

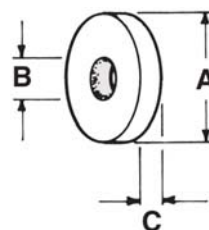

TUBETTO DISTANZIATORE CON INCAVO IN PP

SPACER WITH CAVITY IN PP

Codice code	A	B	C	D
732001INDI9	13	5,5	5	9,5
732002INDI9	13	5,5	7	11,5
732003INDI9	13	5,5	14	18
732004INDI9	17	6	5	9
732005INDI9	17	6	7	11,5
732006INDI9	17	6	10	14,5
732007INDI9	17	6	14	18,5
732008INDI9	17	6	16	21

colore standard Nero
standard colour Black

a richiesta anche colore Bianco
White colour on request

art.732

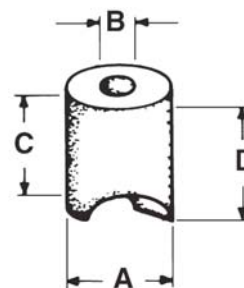

DISTANZIATORE CON INCAVO IN PE

SPACER WITH CAVITY IN PE

Codice code	A	B	C	D
732009INDCI2	18,5	6	6	10,5

colore standard Nero
standard colour Black

art.732

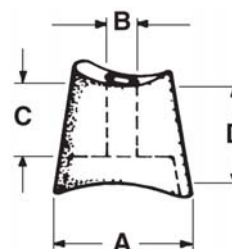

PARACOLPO A FUNGO TESTA TONDA IN PVC MORBIDO

ROUND HEAD BUFFER IN SOFT PVC

Codice code	Ø Testa Ø head	Ø Gambo Ø shank	A	B
720001NNPTT1	9	5	6	4
720002NNPTT1	9	6	6	4
720003INPTT1	14	9	6	4,5
720004INPTT1	14	6	15	6,5
720005INPTT1	20	10	10	8

colore standard Nero
standard colour Black

a richiesta anche colore Bianco
White colour on request

art.720

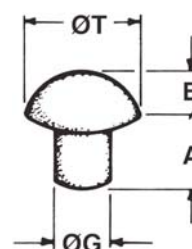

art.721

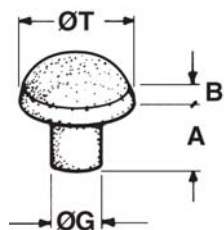

PARACOLPO A FUNGO TESTA BOMBATA IN PVC MORBIDO
ROUND HEAD BUFFER IN SOFT PVC

Codice code	Ø Testa Ø head	Ø Gambo Ø shank	A	B
721001INPTB1	9,5	5	6	3
721002INPTB1	12	6	7,5	3
721003INPTB1	14	6	15	4
721004INPTB1	18	8	15	5
721005INPTB1	20	8	15	5
721006INPTB1	24	11	13	5

colore standard Nero
standard colour Black

a richiesta anche colore Bianco
White colour on request

art.722

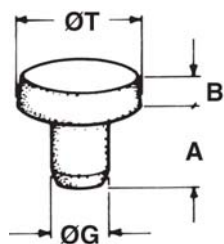

PARACOLPO A FUNGO TESTA PIATTA IN PVC MORBIDO
FLAT HEAD BUFFER IN SOFT PVC

Codice code	Ø Testa Ø head	Ø Gambo Ø shank	A	B
722001INPTP1	7	3,5	5	1,5
722002NNPTP1	12	5	7	3,8
722003NNPTP1	12	6	7	3,8
722005NNPTCB1	10	5	7	3
722006NNPTCB1	10	6	7	3
722007NNPTCA1	10	5	7	5
722008NNPTCA1	10	6	7	5
722011INPTCA1	12	6	9	2,5

colore standard Nero
standard colour Black

a richiesta anche colore Bianco
White colour on request

art.722

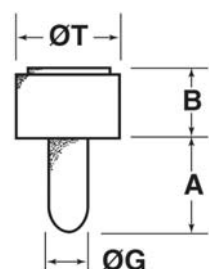

PARACOLPO TESTA CILINDRICA IN PVC
CYLINDRICAL HEAD BUFFER IN PVC

Codice code	Ø Testa Ø head	Ø Gambo Ø shank	A	B
722050INPC1	11	4,2	10	7

colore standard Nero
standard colour Black

a richiesta anche colore Bianco
White colour on request

art.722

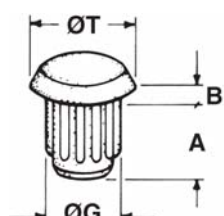

PARACOLPO A FUNGO TESTA BASSA IN PE E PVC
LOW HEAD BUFFER IN PE AND PVC

Codice code	Ø Testa Ø head	Ø Gambo Ø shank	A	B
722004NNPTP2	12	10	10	3
722009INPTP1	12,5	8	9	2

colore standard Nero
standard colour Black

a richiesta anche colore Bianco
White colour on request

PARACOLPO A FUNGO TESTA RETTANGOLARE IN PVC MORBIDO
RECTANGULAR HEAD BUFFER IN SOFT PVC

Codice code	Testa head	Ø Gambo Ø shank	A	B
723001INPTR1	15x10	6	9	4,5
723002INPTR1	15x10	6	9	10

colore standard Nero
standard colour Black

a richiesta anche colore Bianco
White colour on request

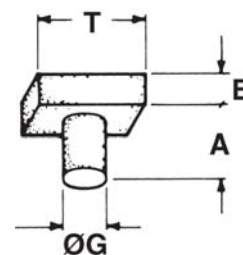
art.723

PARACOLPO TESTA BOMBATA TIPO "A" IN PVC MORBIDO
BUFFER TYPE "A" IN SOFT PVC

Codice code	Ø Testa Ø head	Ø Gola Ø rim	A	B
724001INPCS1	12	5	4,5	4

colore standard Nero
standard colour Black

a richiesta anche colore Bianco
White colour on request

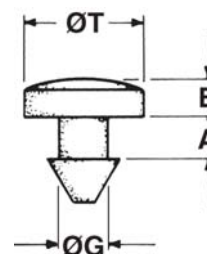
art.724

PARACOLPO TESTA ROTONDA TIPO "C" IN PVC MORBIDO
BUFFER TYPE "C" IN SOFT PVC

Codice code	Ø Testa Ø head	Ø Gola Ø rim	A	B
724004INPCS1	8	4	1	1,5

colore standard Nero
standard colour Black

a richiesta anche colore Bianco
White colour on request

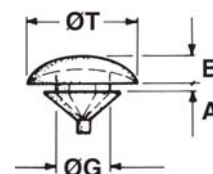
art.724

PARACOLPO TESTA BOMBATA TIPO "B" IN PVC MORBIDO
BUFFER TYPE "B" IN SOFT PVC

Codice code	Ø Testa Ø head	Ø Gola Ø rim	A	B
724002INPCS1	12	6	1	2
724003INPCS1	12	6	1	4,5

colore standard Nero
standard colour Black

a richiesta anche colore Bianco
White colour on request

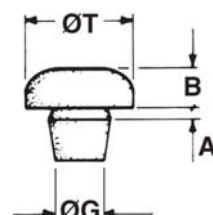
art.724

art.725

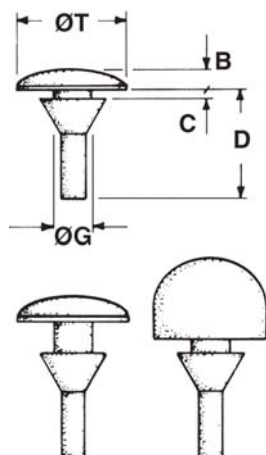

PARACOLPO A FUNGO GAMBO LUNGO IN PVC MORBIDO
 BUFFER WITH LONG SHANK IN SOFT PVC

Codice code	Ø Testa Ø head	B	C	D	Ø Gola Ø rim
725001NNPGL1	12	3	1,5	18	5
725002NNPGL1	12	8	1,5	18	5
725003NNPGL1	12	3	5	21	5

colore standard Nero
 standard colour Black

a richiesta anche colore Bianco
 White colour on request

art.728

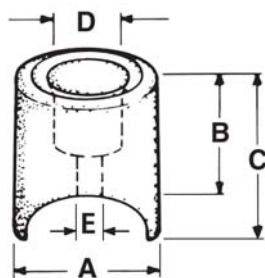

PARACOLPO CON INCAVO CILINDRICO IN PVC
 BUFFER WITH CYLINDRICAL CAVITY IN PVC

Codice code	A	B	C	D	E
728001INPCI1	25	20	28	15	6

colore standard Nero
 standard colour Black

a richiesta anche colore Bianco
 White colour on request

art.729

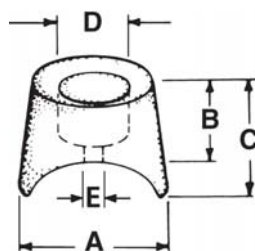

PARACOLPO CON INCAVO IN PVC
 BUFFER WITH CAVITY IN PVC

Codice code	A	B	C	D	E
729001INPTI1	20	9	14	9	5
729002INPTI1	22	11	18	10	5

colore standard Nero
 standard colour Black

a richiesta anche colore Bianco
 White colour on request

PARACOLPO TRONCOCONICO IN PVC
CONICAL BUFFER IN PVC

art.730

Codice code	A	B	C	D
730001INPT1	13	6	6	3
730002INPT1	18	8	7	3
730003INPT1	18,5	18	8	4
730004INPT1	19	10	9	4
730005MPPT1	19	13	8	4
730006INPT1	21	11	9	4
730007INPT1	24	10	9,5	3
730008NNPT1	29	12	13,5	4
730009INPT1	22	13,5	10	5

colore standard Nero
 standard colour Black

a richiesta anche colore Bianco
 White colour on request

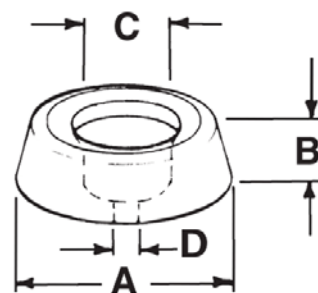

PARACOLPO FERMA PORTE IN PVC
DOOR-STOP BUFFER IN PVC

art.731

Codice code	A	B	C	D
731001NNPF1	18	22	9	4
731002NNPF1	25	25	10	4
731003INPF1	30	25	13	6

colore standard Nero
 standard colour Black

a richiesta anche colore Bianco
 White colour on request

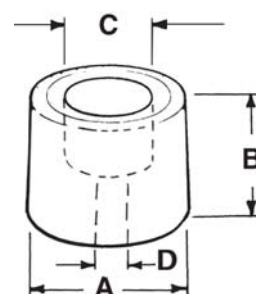



art.901

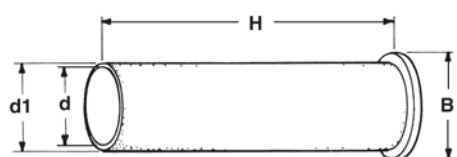

BOCCOLA IN PA CON BORDO
PA BUSHING WITH EDGE

Codice code	d	d1	H	B
901002NNB3	25	29	105,5	32
901003NNB3	26	29	105,5	32
901001NNB3	28	32	120	36

colore standard Nero
standard colour Black

art.902

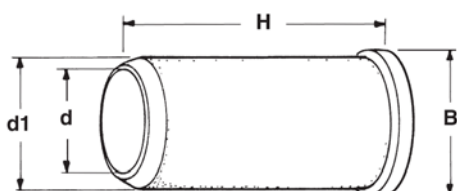

BOCCOLA IN PA CON BORDO
PA BUSHING WITH EDGE

Codice code	d	d1	H	B
902001NNB3	25	47	98	50
902003NNB3	34	47	98	50
902002NNB3	35,2	47	98	50
902004NNB3	35,2	47	98	50

colore standard Nero
standard colour Black

art.903

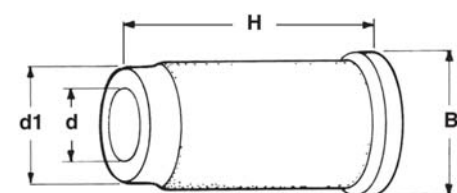

BOCCOLA IN PA CON BORDO
PA BUSHING WITH EDGE

Codice code	d	d1	H	B
903001NNB3	35,5	46	88	50

colore standard Nero
standard colour Black

art.904

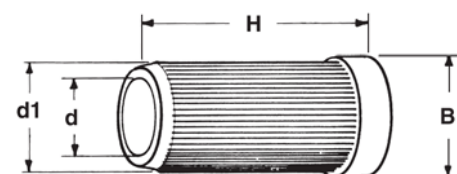

BOCCOLA IN PA RIGATA CON BORDO
GROOVED BUSHING IN PA WITH EDGE

Codice code	d	d1	H	B
904001NNB3	17	34	80	39

colore standard Nero
standard colour Black

BOCCOLA IN PA CON BORDO

PA BUSHING WITH EDGE

Codice code	d	d1	H	B
905001NNB3	45	50	50	56
905002NNB3	51	57	53	60

colore standard Nero
standard colour Black

art.905

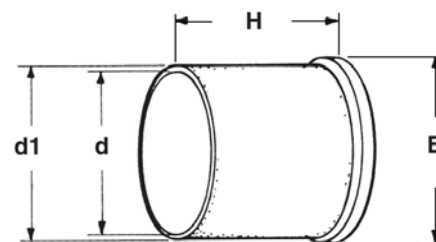

BOCCOLA IN PA CON BORDO

PA BUSHING WITH EDGE

Codice code	d	d1	H	B
906001NNB3	8,5	10	12	16
906002NNB3	12	16	20	22
906004NNB3	21,6	30,6	22	50

colore standard Nero
standard colour Black

art.906

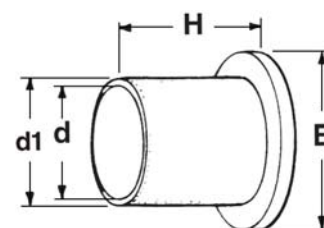

BOCCOLA IN PA LISCIA

SMOOTH BUSHING IN PA

Codice code	d	d1	H
907002NNB3	12	16	20

colore standard Nero
standard colour Black

art.907

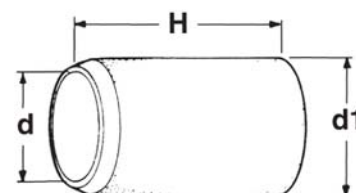

MORSETTO FERMATUBO COMPLETO IN PA

COMPLETE CLAMPING-LUG IN PA

Codice code		Descrizione description
2100016NN3	A	Morsetto Fil. 6ma Clumping-Lug Thread 6ma
2100018NN3	A	Morsetto Fil. 8ma Clumping-Lug Thread 8ma
2100031NN3	B	Boccola 1 Taglio x Ø Tubo 20 1 Cut Bushing for Tube Ø 20
2100022NN3	C	Boccola 2 Tagli x Ø Tubo 15 2 Cuts Bushing for Tube Ø 15
500102NNVP3	D	Volantino Ø 40x6 ma l. 15 Knob Ø 40x6 ma l. 15
500122NNVP3	D	Volantino Ø 40x8 ma l. 15 Knob Ø 40x8 ma l. 15

colore standard Nero standard colour Black

art.210

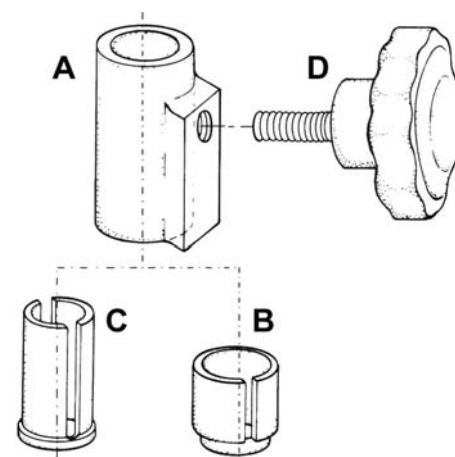

art.211

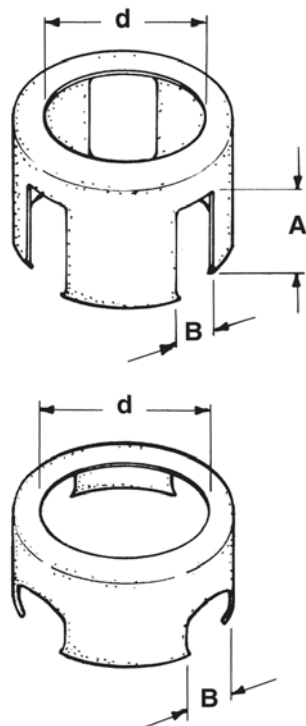

CALOTTA COPRICROCIERA IN ABS
WRAPPER IN ABS

Codice code	d	A	B	Lame blades
211001NN7	51	40	20	2
211002NN7	51	40	20	4
211003NN7	51	40	20	4
211007NN7	51	Ø 25		4
211008NN7	foro cieco blind hole			
211009NN9	41	Ø 25		4

colore standard Nero
standard colour Black

a richiesta anche Cromata
Chrome plated on request

art.212

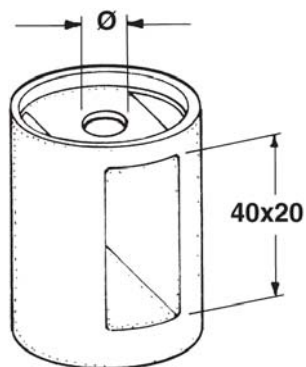

TERMINALE PORTARUOTA IN ABS
END OUTSIDE CAP FOR LEVELLING ELEMENT IN ABS

Codice code	Foro Centrale central hole	Per Tubo for tube
212001NN7	Ø 10	40x20

colore standard Nero
standard colour Black

a richiesta anche Cromata
Chrome plated on request

art.213

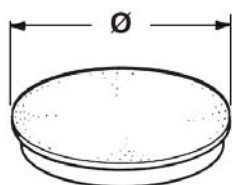

COPRITESTA PER TERMINALE PORTARUOTA IN ABS
COVERING FOR END OUTSIDE CAP FOR LEVELLING ELEMENT IN ABS

Codice code	Ø
213001NN7	50

colore standard Nero
standard colour Black

a richiesta anche Cromata
Chrome plated on request

TUBO mm 20x20 spessore 1,2

TUBE 20x20 mm thickness 1,2

MOD. A “3 VIE”

“3 WAYS” MOD.

Codice code	Misura misura	A	B
412001MNI7	20x20	25	25

colore standard Nero
standard colour Black

a richiesta Cromato o Ottonato
Chrome and Brass plated on request

art.412

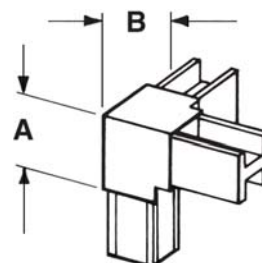

MOD. A “L”

“L” MOD.

Codice code	Misura misura	A	B
412005MNI7	20x20	25	25

colore standard Nero
standard colour Black

a richiesta Cromato o Ottonato
Chrome and Brass plated on request

art.412

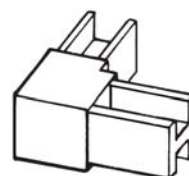

MOD. A “T”

“T” MOD.

Codice code	Misura misura	A	B
412006MNI7	20x20	25	25

colore standard Nero
standard colour Black

a richiesta Cromato o Ottonato
Chrome and Brass plated on request

art.412

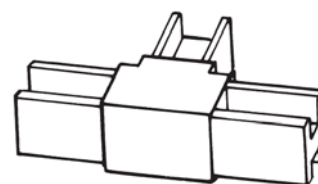

MOD. A “CROCE”

“CROSS” MOD.

Codice code	Misura misura	A	B
412007MNI7	20x20	25	25

colore standard Nero
standard colour Black

a richiesta Cromato o Ottonato
Chrome and Brass plated on request

art.412

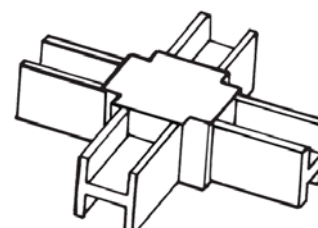



art.412

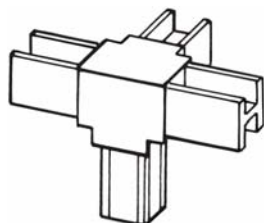

MOD. A "4 VIE"

"4 WAYS" MOD.

Codice code	Misura misura	A	B
412002MNI7	20x20	25	25

colore standard Nero
*standard colour Black*a richiesta Cromato o Ottonato
Chrome and Brass plated on request

art.412

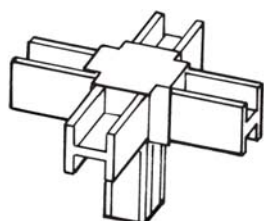

MOD. A "5 VIE"

"5 WAYS" MOD.

Codice code	Misura misura	A	B
412003MNI7	20x20	25	25

colore standard Nero
*standard colour Black*a richiesta Cromato o Ottonato
Chrome and Brass plated on request

art.412

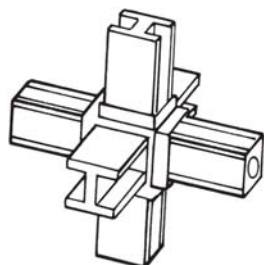

MOD. A "6 VIE"

"6 WAYS" MOD.

Codice code	Misura misura	A	B
412004MNI7	20x20	25	25

colore standard Nero
*standard colour Black*a richiesta Cromato o Ottonato
Chrome and Brass plated on request

TUBO mm 25x25 spessore 1,2

TUBE 25x25 mm thickness 1,2

MOD. A “3 VIE”

“3 WAYS” MOD.

Codice code	Misura misura	A	B
412008MNI7	25x25	30	30

colore standard Nero
standard colour Black

a richiesta Cromato o Ottonato
Chrome and Brass plated on request

art.412

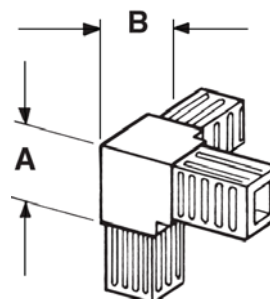

MOD. A “L”

“L” MOD.

Codice code	Misura misura	A	B
412011MNI7	25x25	30	30

colore standard Nero
standard colour Black

a richiesta Cromato o Ottonato
Chrome and Brass plated on request

art.412

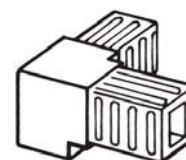

MOD. A “4 VIE”

“4 WAYS” MOD.

Codice code	Misura misura	A	B
412009MNI7	25x25	30	30

colore standard Nero
standard colour Black

a richiesta Cromato o Ottonato
Chrome and Brass plated on request

art.412

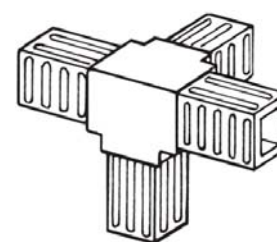

MOD. A “5 VIE”

“5 WAYS” MOD.

Codice code	Misura misura	A	B
412010MNI7	25x25	30	30

colore standard Nero
standard colour Black

a richiesta Cromato o Ottonato
Chrome and Brass plated on request

art.412

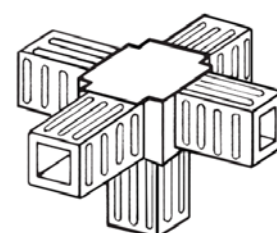



art.205

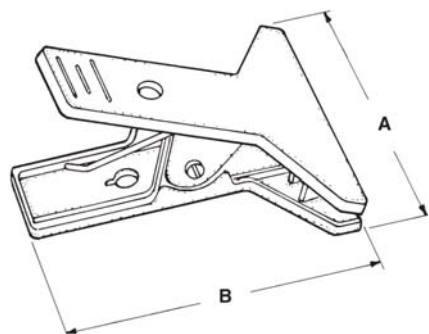

PINZA IN PA PER FARETTI SPOT
PA PLIER FOR SPOT LIGHTS

Codice code	A	B	Apertura max max opening
205001NN3	100	120	40

colore standard Nero
standard colour Black

art.806

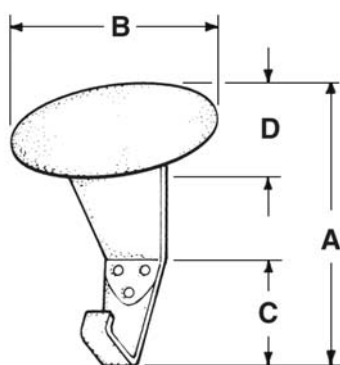

ATTACCAPANNI IN ABS
HANGER IN ABS

Codice code	A	B	C	D
806001NNAR7	130	83	59	
806002INA07	131	98	55	56,5

colore standard Nero
standard colour Black

altri colori a richiesta
other colours on request

art.812

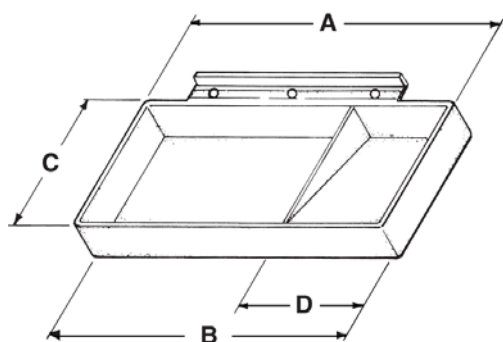

VASCHETTA PORTA GESSO PER LAVAGNA IN PP
LITTLE CONTAINER IN PP FOR CHALK

Codice code	A	B	C	D
812002IGVL9	192	188	98	50

colore standard Grigio
standard colour Grey

art.812

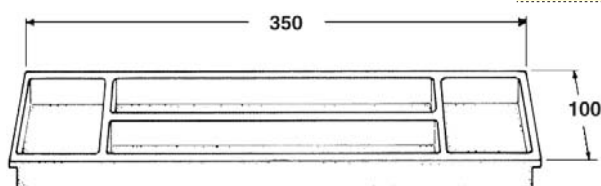

VASCHETTA PORTAMATITE IN PS
LITTLE CONTAINER PENHOLDER IN PS

Codice code	Dimensioni mm dimensions mm
812001NNVP13	100x350

colore standard Nero
standard colour Black

PASSACAVO PER SCRIVANIA IN PS
PS CABLE CHANNEL FOR DESK

Codice code	A	B	C	D
812010INPS13	72	60	3	21
812011INPS13	91	80	3	18

colore standard Nero
standard colour Black

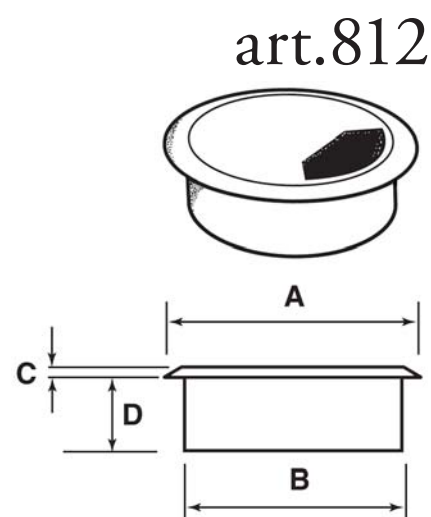
BACINELLA IN PP PER PORTA OMBRELLI
UMBRELLA STAND TRAYER IN PP

Codice code	Ø	H
809001NNBP9	260	28
809002INBP9	130	35
809003INBP9	200	35
809004INBP9	275	35
809005INBPO9	160x130 ovale 160x130 oval	45

colore standard Nero
standard colour Black

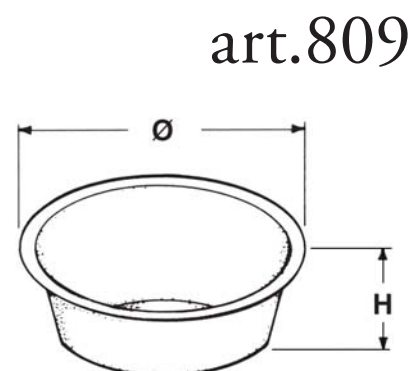
VASCHETTA IN PP PORTA OMBRELLI PER SPOGLIATOI
UMBRELLA STAND BOWL FOR DRESSING ROOM MADE IN PP

Codice code	A	B	C	D
810001NNVR2	57	64	56	63

colore standard Nero
standard colour Black

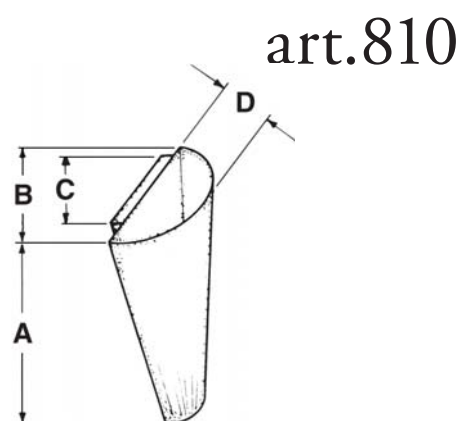
BLOCCHETTO REGGIPIANI IN PE HD
PE HD SHELF SUPPORT

Codice code	A	B	Ø C	D	E
801003IBBR2	11,5	11,5	7	11,5	11,5

colore standard Bianco
standard colour Naturale

a richiesta colore Marrone
Brown colour on request

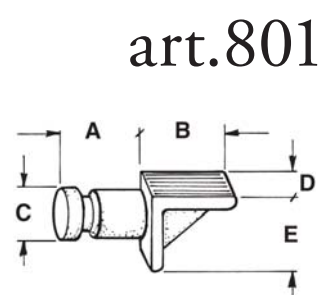



art.801

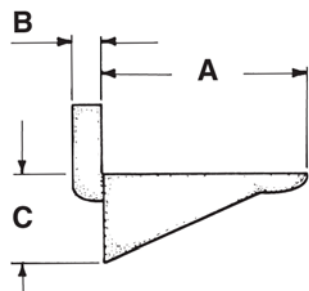

MENSOLA REGGIPIANO IN PA
PA SHELF SUPPORT

Codice code	A	B	C
801001INMR3	21 x 24,5	3,5 x 15,5	9,5

colore standard Naturale
standard colour Naturale

art.950

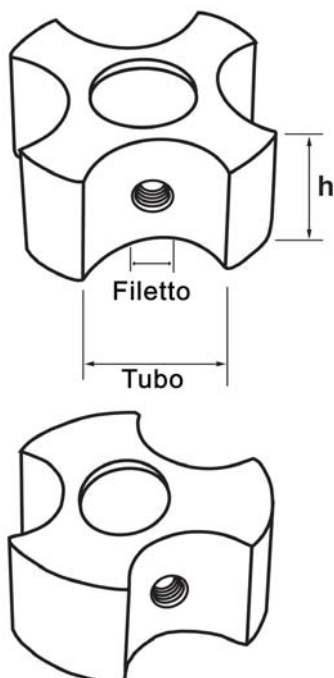

CROCIERA PER STENDER IN ZAMA ZINCATA
STAR WHEEL FOR COLUMN CLOTHES GALVANIZED ZAMA

Codice code	Tubo tube	Filetto thread	h
950001CRZ	25 ÷ 32	M8	28
950002CRZ	25 ÷ 32	M8	28

Personalizzazione a richiesta
Customization on request

art.808

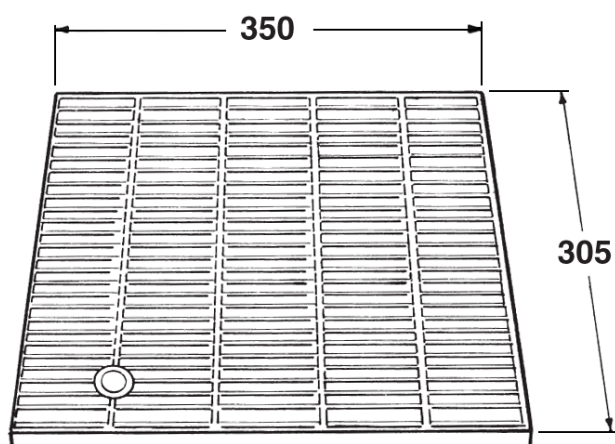

GRIGLIA PER COMODINI IN PE HD
PE HD GRATING FOR NIGHT TABLES

Codice code	Dimensioni mm dimensions mm
808001NBGC14	305x350

colore standard Naturale
standard colour Naturale

PARASPIGOLO IN PE PER MOBILI
PE CORNER COVER FOR FURNITURES

Codice code	BxB	C
800011INPM2	* 55x55	30
800012INPM2	* 55x55	25
800013INPM2	* 55x55	19
800010INPM2	60x60	26

colore standard Nero * ad angolo chiuso
 standard colour Black * closed corner

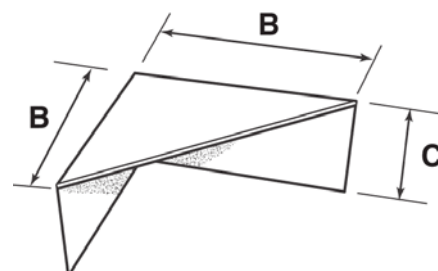

art.800
CARRUCOLA IN PA CON GOLA PER TUBO Ø 20
PA PULLEY WITH RIM FOR TUBE Ø 20

Codice code	Ø D	Ø d	H
734001NNC3	40	8,5	32

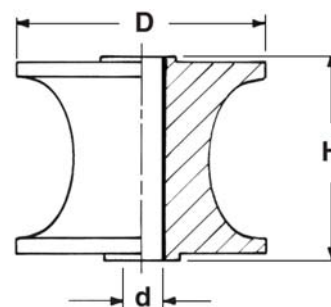
colore standard Nero adatto per tubo Ø 20
 standard colour Black suitable for tube Ø 20

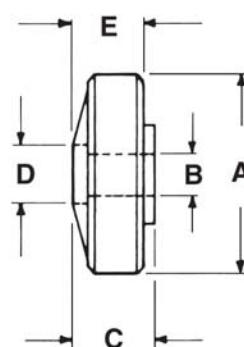

art.734
CUSCINETTO A SFERA IN PA
PA BALL BEARING

Codice code	Ø A	Ø B	C	Ø D	E
815001INCS3	23	6	8	8	7
815002INCS3	25	6	8	8	7
815003INCS3	28	6	8	8	7
815004INCS3	30	8	8	10	7

art.815-816

CUSCINETTO PER RIVETTATURA A STRAPPO IN PA
PA BALL BEARING FOR PULL RIVETING

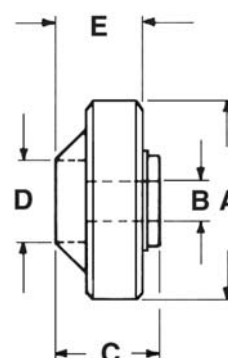
816001INCR3	23	5	12	12	8,5
816002INCR3	25	5	12	12	8,5
816003INCR3	28	5	12	12	8,5

colore standard Naturale adatto per cassetti
 standard colour Natural suitable for drawers



Accessori per porte basculanti di produzione Gielle Technoplast
Other articles of our production





Condizioni generali di vendita

General sale conditions

ORDINI E CONFERME DI VENDITA: le ordinazioni trasmesse alla Gielle Technoplast Srl per lettera, fax, e-mail o telefono sono da considerarsi accettate e la vendita si intende perfezionata al momento e nel luogo in cui Gielle Technoplast Srl comunica la sua accettazione con uno dei predetti mezzi di comunicazione e secondo i termini dell'accettazione stessa. Le vendite vengono effettuate in conformità alle presenti condizioni generali, salvo diverse espresse attuazioni scritte tra Gielle Technoplast Srl e l'acquirente.

PREZZI: salvo accordi diversi, si applicano i prezzi in vigore al momento della consegna o spedizione della merce ed i prezzi stessi si intendono per merce resa franco nostro magazzino con imballo a carico dell'acquirente.

CONSEGNE: i termini di consegna sono indicativi e non ci impegnano. Non siamo tenuti a corrispondere indennizzi di sorta per eventuali danni dovuti a ritardi di consegna, ad interruzioni o risoluzione parziale o totale della fornitura.

TRASPORTI: le merci, anche se vendute franco destino, viaggiano sempre a totale rischio e pericolo dell'acquirente. Noi non garantiamo né i prezzi di trasporto né i termini in cui i trasporti vengono effettuati.

PAGAMENTO: i pagamenti dovranno essere effettuati presso il domicilio di Gielle Technoplast Srl secondo le condizioni ed i termini indicati nell'ordine; il mancato o ritardato pagamento anche di una sola parte dell'importo dovuto determinerà la decadenza del beneficio del termine del compratore diretto di Gielle Technoplast Srl di esigere immediatamente il pagamento dell'intero prezzo residuo. Trascorse le scadenze convenute saranno inoltre conteggiati gli interessi di mora. Si precisa che il ritardato pagamento ci autorizza a sospendere, senza alcun preavviso, ogni fornitura in corso. La presente vendita è assoggettata alla normativa con patto di riservato dominio di cui agli art. 1523 C.C. E seguenti; la proprietà della merce passerà in capo all'acquirente solo in seguito al pagamento dell'intero prezzo.

USO: Il compratore assume tutti i rischi relativi all'uso del pezzo e Gielle Technoplast Srl non sarà responsabile dei danni e/o sinistri che dovessero verificarsi in seguito di uso difforme da parte del compratore.

RECLAMI: eventuali reclami dovranno essere fatti per iscritto entro 8 giorni dal ricevimento della merce. Il cliente è tenuto a fornire indicazioni chiare e precise riguardo alle quote critiche tolleranze, i cui valori si intendono per lo stato esistente al momento dei controlli di processo, la Gielle Technoplast Srl non risponderà in alcun modo di eventuali manomissioni.

GARANZIA: In caso di difetti Gielle Technoplast Srl si impegna a sostituire gratuitamente le parti difettose dopo che il compratore ne abbia dato comunicazione scritta a Gielle Technoplast Srl, le sostituzioni avverranno con le spese di trasporto a carico del compratore, restando esclusa la responsabilità verso il cliente per perdite costi o danni conseguenti al difetto. Gielle Technoplast Srl non sarà responsabile per problemi e difetti derivanti dalla normale usura dei pezzi, per danni causati da improprio o erroneo utilizzo dei pezzi. La garanzia prestata da Gielle Technoplast Srl in base al presente contratto non opera nel caso di mancato pagamento anche di una sola rata del prezzo da parte del compratore. Le forniture e le lavorazioni di Gielle Technoplast Srl sono garantite comunque nei soli limiti delle specifiche e delle richieste tecniche e/o dei controlli specifici in quanto espressamente pattuiti, per un mese dalla consegna a condizione che eventuali difetti siano denunciati come previsto nell'articolo 1495 del C.C.

SOLVET ET REPETE: il compratore non potrà proporre alcuna domanda o eccezione se non sarà in regola con i pagamenti pattuiti.

RISERVA DI PROPRIETÀ: la vendita di cui al presente contratto è assoggettata alla normativa della vendita con riserva di proprietà di cui agli artt. 1523 C.C. e seguenti con effetto che quanto venduto resta di proprietà di Gielle Technoplast Srl fino all'integrale pagamento del pezzo concordato. Il compratore assume tuttavia i rischi fino al momento della consegna della merce. La stessa si impegna altresì a comunicare al venditore senza dilazione alcuna e per iscritto ogni spostamento e/o eventuale procedimento giudiziario dovesse riguardare la merce venduta. In caso di mancato pagamento anche di una sola rata il cui importo superi l'ottava parte del prezzo complessivo convenuto, il compratore decadrà dal beneficio del termine e il venditore, senza necessità di costituzione in mora, potrà domandare dell'intero prezzo residuo.

FORO E LEGGE APPLICABILE: l'autorità giudiziaria di Milano ha competenza per decidere qualsiasi controversia insorgesse. E per quanto non espressamente previsto dalle condizioni generali e particolari del contratto è applicabile la legge Nazionale Italiana.

ORDERS AND SALE CONFIRMATION: orders sent to Gielle Technoplast Srl by letter, fax, e-mail or phone should be considered accepted and the sale should be considered done at the moment and in the place where Gielle Technoplast Srl gives his acceptance by one of the above mentioned means and according to his terms of acceptance. The sales are done only according to the present general conditions, except different written agreements between Gielle Technoplast Srl and the buyer.

PRICES: except different agreements, will be applied prices in force, at the moment of the delivery of the goods. The same should be considered free our factory and packing cost will be at the Customer's charge.

DELIVERIES: delivery terms are indicative and do not bind us. We will not be obliged to pay any kind of refund for possible damage arising from either delay or interruption or partial/total supply rescission.

TRANSPORTS: goods, even if free your factory, are always conveyed at the total Customer's risk. Our guarantee does not cover transport prices and terms. On request we establish transport and insurance contracts only on Customer's name and on his instructions.

PAYMENTS: payments must be made at the domicile of Gielle Technoplast Srl to the conditions and terms specified in the order; non-payment or delay payment of even one part of the amount due will result in the forfeiture of the term benefit of the buyer with the right to Gielle Technoplast Srl to request immediate payment of residual value. Spent the agreed deadline will also be counted interest on late payments. State that the payment entitled us to suspend, without notice any provision in the course. This sale is subject to the rule of the sale with retention of the title referred to and following art. 1523 C.C. title of the goods will pass to the buyer only after payment of the price.

USE: buyer assumes all risk of use of the pieces and Gielle Technoplast Srl shall not be liable for damage and/or claims that may arise from a different use by the buyer.

CLAIMS: Any claims must be made in writing within 8 days from receipt of good. The customer must give clear and precise about the critical dimensions and tolerances, the values are valid for the state at the time of the inspections process. The Gielle Technoplast srl not respond in any way tampering.

WARRANTY: in case of defects Gielle Technoplast Srl will replace defective parts free of charge after the buyer he has given written notice to Gielle Technoplast Srl, substitutions will be made with travel expenses incurred by the buyer, to the exclusion of liability for the customer cost losses or damages caused by the defect. Gielle Technoplast Srl not be liable for problems and defects arising from normal wear price for damages caused by improper or incorrect use of pieces. The guarantee given by Gielle Technoplast Srl under this contract will not operate in case of failure to pay even one instalment of the price by the buyer. Supplies or work Gielle Technoplast Srl are guaranteed, however, only in the specification limits and technical requirements and/or specific checks as expressly agreed, for a month after delivery, provided that any defects are reported in 1495 del C.C. as planned.

SOLVE ET REPETE: The buyer may not bring any claim or objection if it is not in compliance with the agreed payments.

RETENTION OF TITLE: the sale of this contract is subject to the rule of the sale of the property subject to in art. 1523 C.C. and following with effect as the sold under the exclusive property of Gielle Technoplast Srl until full payment of the agreed price. However the buyer assumes the risks from the moment of the delivery. The same also undertakes to notify the seller without delay, and some writing of any displacement and/or possible legal proceedings must related to the goods sold. In case of the failure to pay even one instalment that exceed one-eight of the total agree price, the buyer will lose the benefit of the term and the seller, without any formal notice, may request the entire residual value.

COURT AND APPLICABLE NATIONAL LAW: Judicial Authority of Milan will have the competence on decisions concerning any controversy that could arise. Italian law will be apply for whatever as not been foreseen in the general and particular contract conditions.

GIELLE TECHNOPLAST S.r.l.

Via Principale 18, 23879 VERDERIO (LC) - ITALIA

tel. +39 039 510526 r.a. - fax +39 039 510711

www.gielletechnoplast.com

info@gielletechnoplast.com

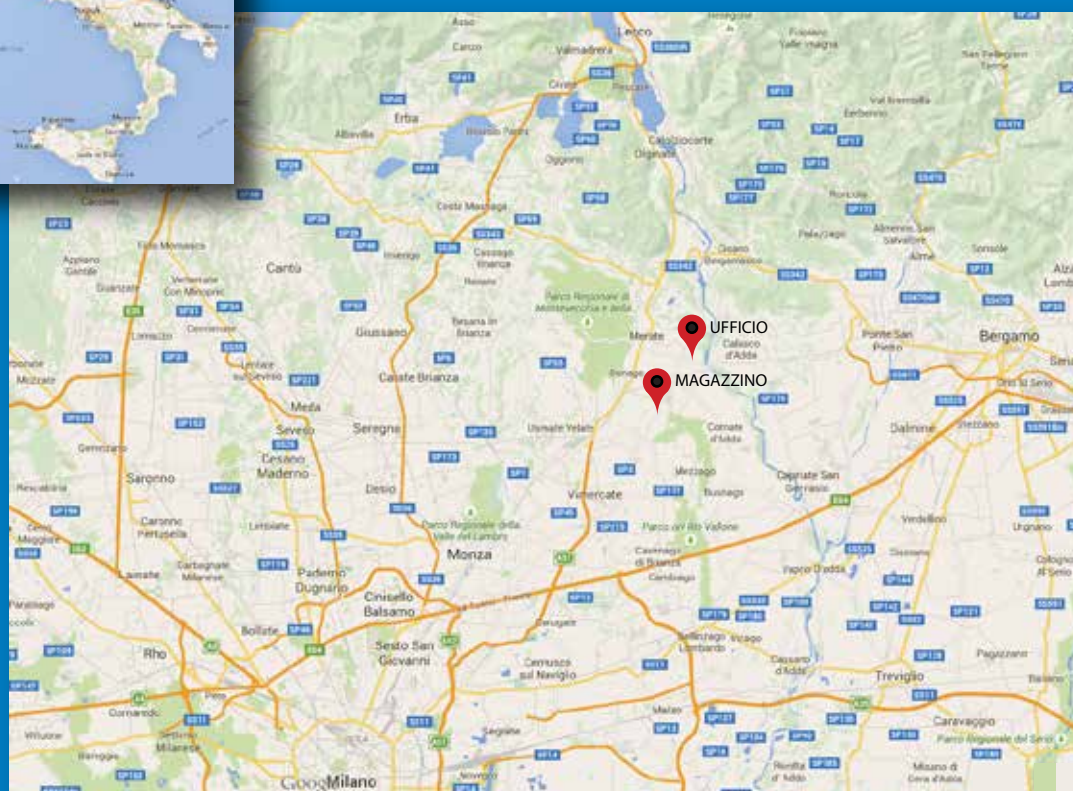

Sede e uffici commerciali : Via Principale,18 - 23879 VERDERIO (LC) - ITALIA

Magazzino spedizioni : Via delle Industrie, 21 - 20881 BERNAREGGIO (MB) - ITALIA